

WC7650 – User Manual

USB to HDMI video converter

product description:

This product is a USB to HDMI video converter. Please connect your device to the display of the HDMI interface (such as HDTV/projector/LED display), you can watch the video slideshow on the big screen, etc. Operation, to meet your needs in the family conference office and other places of production.

Product connection diagram:

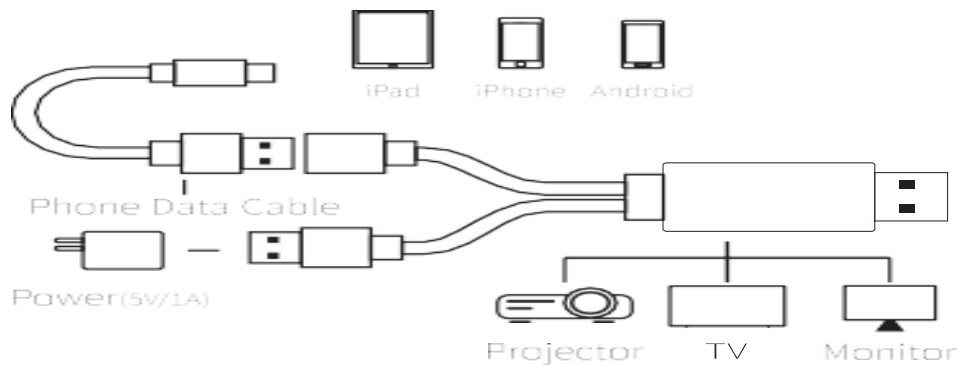

IOS system operation steps

1. Connect iPhone/iPad via USB data port with original data cable
2. The trust window pops up, and you can choose the trust to be on the same screen. (Figure 1)

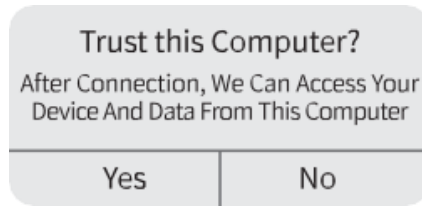

(Figure 1)

Android system steps:

Google Home Android with mirror

1. Connect the phone/tablet through the USB port with the original data cable
2. Install Google Home software and log in to your account.
3. Turn on the phone Set ①» Wireless and Network ②» Mobile Network Sharing ③» USB Sharing Network ④



①

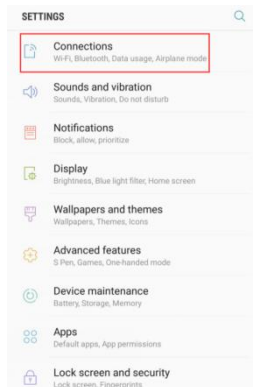

②

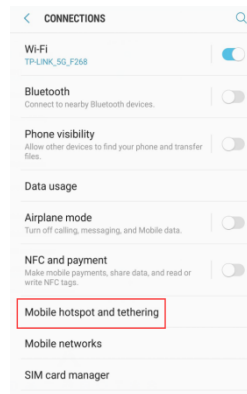

③

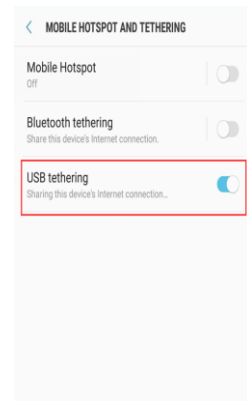

④

4. Open Google Home software and log in to your account
5. Click on the mirror device
6. Open Google Home Software > Click on Mirror Device ⑤ > Click on "Projection Screen / Audio ⑥" > click on SSID Name ⑦ to get the mirror.

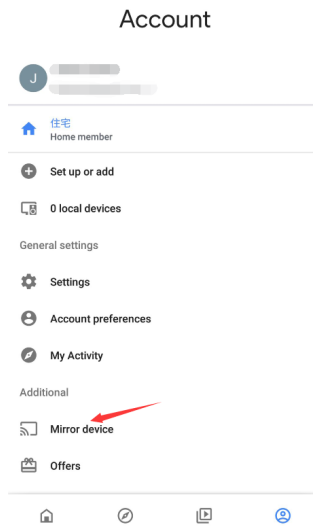

⑤

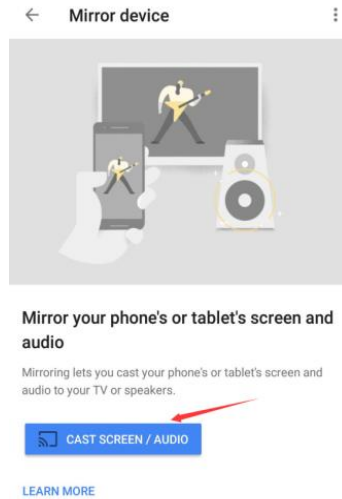

⑥

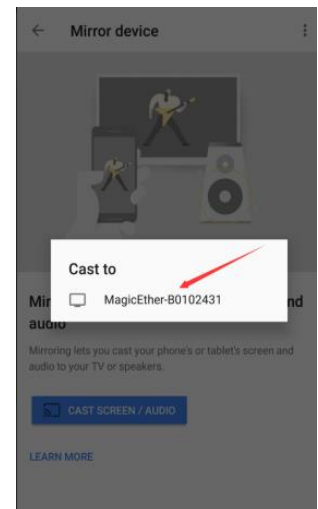

⑦

EZCast software Android with the mirror:

1. Search for "EZCast Software" in the mobile phone market and install it.
2. Go to EZCast and click on the red "W" in the upper right corner (Figure 2)
3. Click on "Connet" under USB network sharing (Figure 3)
4. Open USB network share (Figure 4) The first pop-up window (Figure 5) click "Start now" to be on the same screen



图 2



图 3

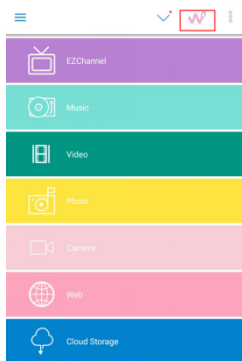

图 4



图 5

Product upgrade:

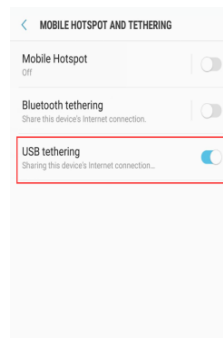
After the IOS system is upgraded, it cannot be on the mirror. Please use the upgrade method to upgrade the product.

1. Power on the mirror cable and press the upgrade button to switch to the upgrade page »Open the phone settings» open "personal hotspots"
2. Go to "EZCast" and click on the red "W" in the upper right corner (Figure 2)
3. Click on the upper left menu (Fig. 6) and select "Firmware OTA" (Fig. 7). The upgrade window will pop up and select OK (Fig. 8) to count into the upgrade mode.

Note: Do not disconnect the device during the upgrade process!

