

Unit: mm

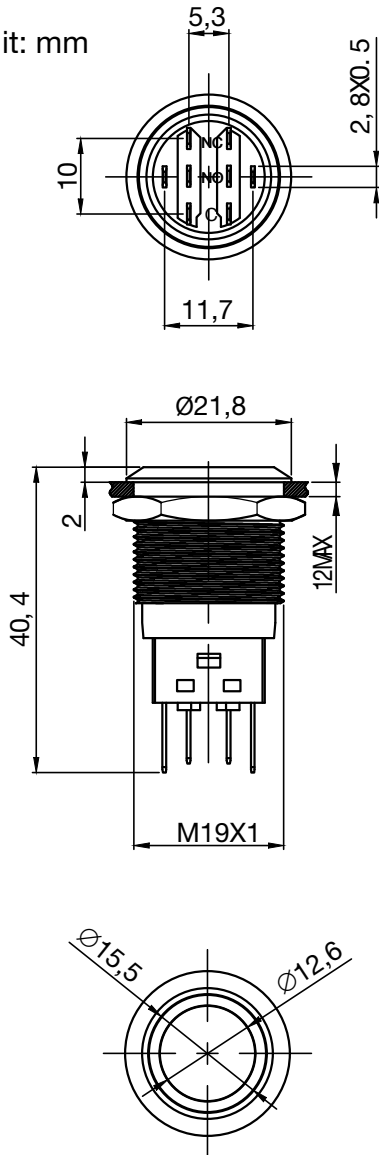

Switch structure description:

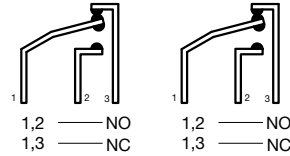

Lamp bead equivalent circuit:

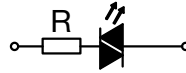

Mounting hole size:

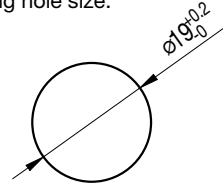

Performance requirements:

Protection grade: IP67

Contact resistance: $\leq 50m\Omega$

The insulation resistance: $\geq 100M\Omega$

Electrical resistance: AC2500V, 1min, no flicker and breakdown;

Life: Electrical part: operate 50,000 times under rated load without any abnormality.

Mechanical part: no abnormal movement for 1000,000times

Technical requirements:

The surface is smooth without burr;

Clear handwriting of parameters/batches without any dislocation;

Electric parameter: 5A U_i : 250V;

Working environment temperature: $-25^{\circ}C \sim +65^{\circ}C$;

Operation type: Momentary; Latching ;

Movement stroke: about 3.2mm

Connection form: Matching connectors/Welding wire;

Tightening torque: about 0.6Nm;

Contact configuration: 1NO1NC;

Appearance material: Button surface: PC/Stainless steel; PC/Nickel-Plated Brass;
Housing: Stainless steel; Nickel-Plated Brass
Pedestal: PBT;
Contact silver alloy

Unmarked tolerance shall be in accordance with GB/T 1804-m class.

Lamp bead parameters: Rated Voltage: 6V/12V/24V/36V; 110V/220V;
Rated current: $\leq 20mA$

LED color: Red/Green/Yellow/Orange/Blue/White

Led life: 50000 hours.