

Specifications

Power:	1.5W
Lumens:	220LM
LEDs:	SMD2835*14PCS (Front 12PCS+Back2PCS)
Beam Angle:	90°
Li-ion Battery:	1200mAh/3.7V
Solar Panel:	0.7W, Mono-crystalline silicon
Detection Angle/Area:	120°/≤6m
IP Degree:	IP65 Waterproof
Lifespan:	35,000hrs
Installation Height:	≤4m

Features

- Easy & quick installation
- No operational cost
- PIR sensor
- IP65 waterproof
- Light on/off Automatically
- 6m detection range
- 2 modes

Distributed by:
Electus Distribution Pty Ltd
46 Eastern Creek Dr,
Eastern Creek NSW 2766 Australia
Ph 1300 738 555

www.electusdistribution.com.au



**220 Lumen Solar Rechargeable
Wall Light with PIR Sensor
SL3512
User Manual**

Installation

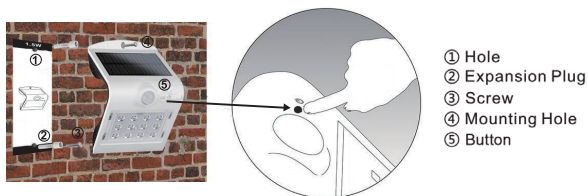

1. Please use the card to measure hole position correctly and drill 2 holes of 6mm diameter.
2. Fix 2 expansion plugs into the holes.
3. Fix a screw to the lower expansion plug, insert the notch onto the screw.
4. Straighten the whole lamp and fasten the upper screw.
5. Press the button to adjust to required working mode.

Notice

1. This is a solar powered lamp, install in location where it can receive enough sunshine.
2. Lighting time depends on sunshine duration and weather.
3. Lamp lights up automatically at dusk.
4. Built-in intelligent IC with over-charge, over-discharge and over-voltage protection.

Warning

1. The lamp is equipped with an internal lithium battery, which is replaceable. If and need, please contact the seller for new battery.
2. If the battery is taken out & put back in or replaced with new ones, please toward the solar panel to sunshine or a strong light to activate the lamp.
3. Non-professionals please do not disassemble the lamp.
4. Please do not exposure the battery with household garbage to avoid explosion.

Working Modes

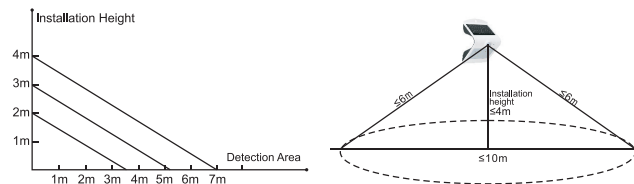

Press the Button to adjust working mode:
Press 1st time for Mode A.
Press 2nd time for Mode B.
Press 3rd time for off.



Mode A: Automatically turns on to full brightness (220lm) when motion is detected in the range $\le 6m$, and then turns to weak brightness (front light on and back light on) in 10 seconds if no motion.



Mode B: Automatically turns on to full brightness (220lm) when motion is detected in the range $\le 6m$ and then turns to weak brightness (front light off and back light on) in 10 seconds if no motion.