

80\*80mm

## NEXTECH



**1296P Smart Wi-Fi  
IP Camera  
QC3900  
User Manual**

### 1.Product Introduction

Packing list: Smart Camera × 1, Manual × 1, USB Power Cord × 1, Power Adapter × 1, Screw Accessories Package × 1

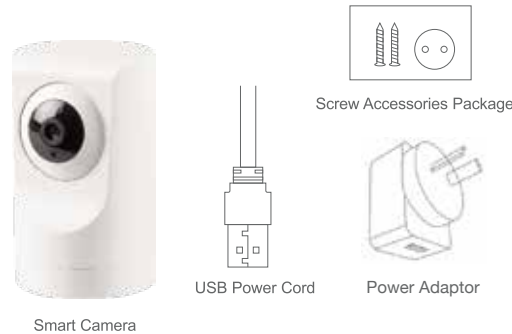

01

### Basic Parameters

Pixel: 3MP  
Video Compression: H.265 High Profile  
Image Enhancement: Digital Wide Dynamic 3D Noise Reduction  
Local Storage: MicroSD card  
Wireless Encryption: WEP/WPA/WPA2 Encryption  
Power Input: 5V 1A(Min)  
Total Power Consumption: 5W (Max)  
WirelessStandard: 2.4G 802.11 b/g/n  
Support Platform: Android/iOS

### Component Description:

Reset Button: Long press "reset" hole 5sec, reset success.

It is recommended to insert 8-256GB high-speed Micro SD card, otherwise it will not be able to store, view historical video and support Important functions such as firmware upgrading.

02

### 2.Install APP

Download APP: scan the QR code below to download and install.  
Register and login: open the "Smart Life" APP to register and login according to the prompts.



03

### 3.1、 Add The Device-Scan QR code mode

- Make sure Wi-Fi is available and connected to the Internet.
- Connect the camera to the power, then system startup completed.
- Open "Smart Life" APP, press the '+' in the upper right corner of the main screen (Figure 01); choose "Security & Sensor", click "Smart Camera" (Figure 02) to add camera; and then click "Next step" (Figure 03);

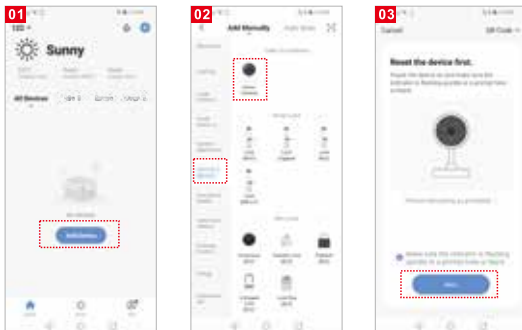

04

- If the mobile phone is not connected to wi-fi, please click "Connect to Wi-fi" (Figure 04);
- It will jump to the WLAN interface and connects Wi-Fi (Figure 05).Please note that only 2.4 GH Wi-Fi network is supported;
- If the phone is connected to Wi-Fi (Figure 06);

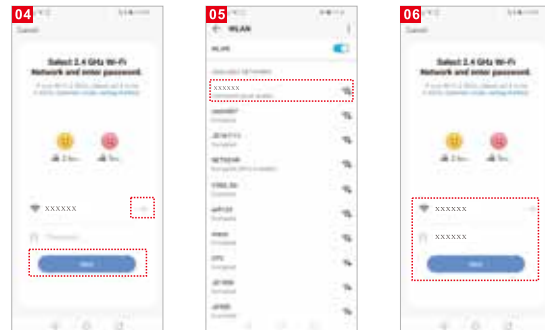

05

- A QR code will prompt on your screen and you need to scan it with the Smart Camera. (the camera is about 20-30 cm away from the mobile phone lens). Then click "hear the prompt sound" (Figure. 07).
- "connecting" (Figure. 08);

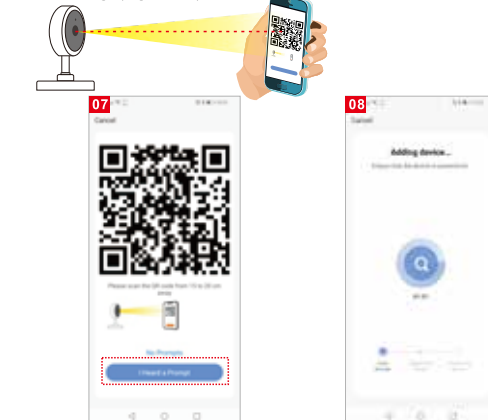

06

- connection completed(Figure 09), and click "Finish";
- Then jump to preview interface (Figure 10)
- After closing the device preview interface, the interface returns to the APP home page. At this time, the connected device will appear on the APP home page (Figure 11). Then you can click directly to the device interface to see the monitoring situation without re-adding afterwards.

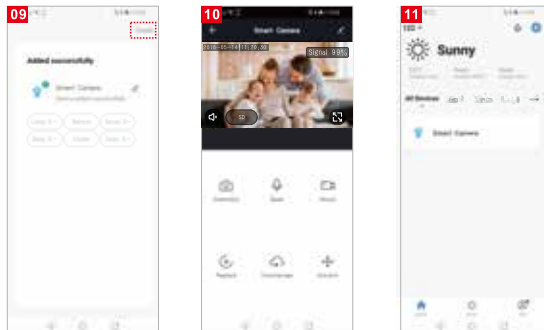

07

### 3. 2. Add The Device-AP Mode

#### First set the machine to the hot spot distribution network mode

- Locate the RESET button on the machine and press it for about 1 second; After about 1 minute, the sound will ring and the hotspot will start successfully.

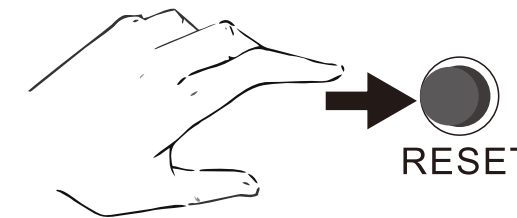

08

- If you want to use AP Mode,press the reset button on the machine
- Make sure Wi-Fi is available and connected to the Internet.
  - Connect the camera to the power, system startup completed.
  - Open "Smart Life" APP, press the '+' in the upper right corner of the main screen (Figure 12); choose "Security & Sensor", click "Smart Camera" (Figure 13) to add camera ; Alternatively, choose "other ways" to add (as shown in Figure 14);

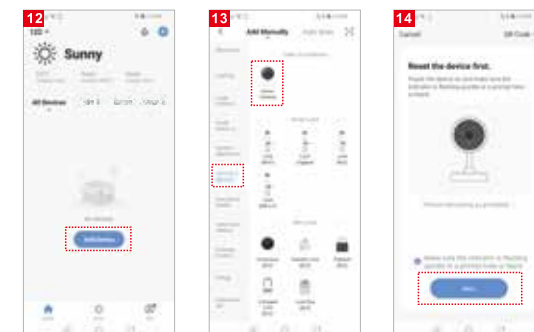

09

**Note : Before using the "AP Mode",you need to switch to "AP Mode" by lightly pressing the "Reset key" of the device.**

- Then click "hot spot configuration" (Figure 15);
- Then click "compatibility mode", clicks"Next" (Figure 16);
- Then click "change Network" (Figure 17);

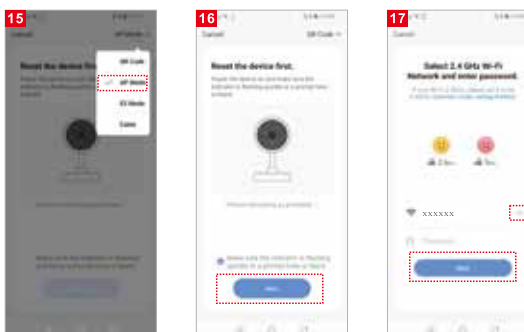

10

- Then enter the password to complete the connection (Figure 18);
- Click Back and return to the APP compatible mode interface, where the Wi-Fi name and the connected Wi-Fi name are displayed Password, click the "Confirm" button (Figure 19);
- The page jumps to where the interface prompts "Wi-fi" to connect to the device hotspot and clicks "Connect" (Figure 20)

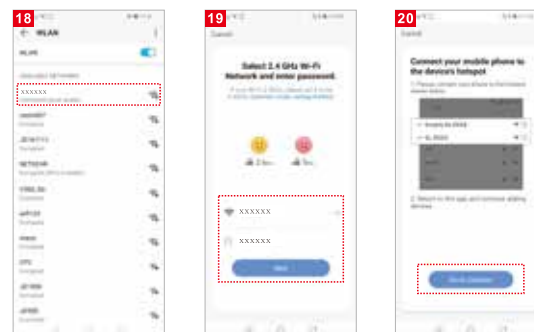

11

- The interface jumps to the WALN connection interface, finds the Wi-Fi at the beginning of "Smart Life", and clicks on the connection (Figure 21);
- When the connection is completed, click back and return to the APP interface, at which time the APP display device is connected (Figure 22).
- At this time, the device has been successfully connected; the interface jumps to "Add Device Successful" (Figure 23);

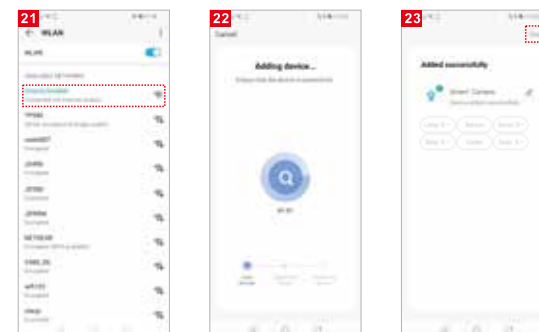

12

- Then click "connected", it will jump to the Preview Interface of the Device (Figure 24)
- Close the device preview interface and the interface returns to the APP home page, at which point the connected device will appear on the APP home page.(Fig. 25). After entering the device interface to view, no need to re-add, click directly into the device interface to view .

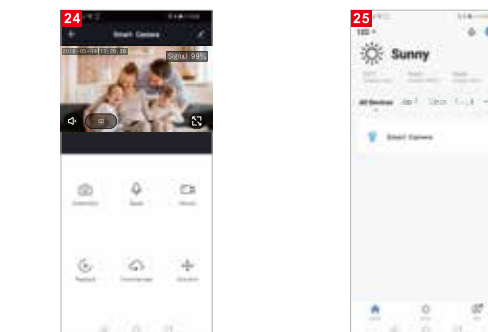

13

### 4.APP Video Browsing Details

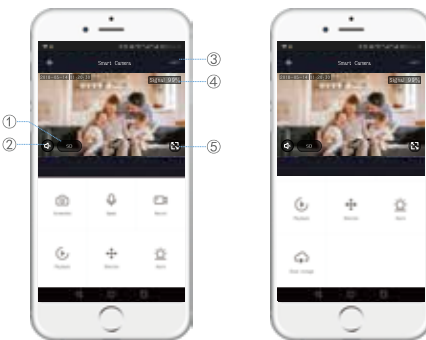

- ①Preview mode
- ②Monitor Switch
- ③About device
- ④Signal Value
- ⑤Full screen

14

### 5.Matters Need Attention

- Try to keep away from the metal space;
- Avoid the furniture , microwave oven blocked;
- Avoid the space where the audio, video and data lines are wound, and keep the space away from them as large as possible;
- Ensure that as close as possible to the coverage of wireless Wi-Fi signals. Switching network environment:
- In the new network environment, please press the reset hole about 5 seconds, then connect to the network.

15

### The name and content of the harmful substances in the product

Part Name	Harmful Substance					
	Pb	Hg	Cd	Cr(VI)	PBB	PBDE
shell	○	○	○	○	○	○
Board	X	○	○	○	○	○
charger	○	○	○	○	○	○
annex	○	○	○	○	○	○

This form is based on the provisions of SJ/T 11364.

This product conforms to RoHS environmental protection requirements. At present, there is no mature technology in the world to replace or reduce the lead content in the electronic ceramics, porcelain, optical glass, steel and copper alloy.

16

### Warranty Information

Our product is guaranteed to be free from manufacturing defects for a period of 12 Months.  
If your product becomes defective during this period, Electus Distribution will repair, replace, or refund where a product is faulty; or not fit for intended purpose.

This warranty will not cover modified product; misuse or abuse of the product contrary to user instructions or packaging label; change of mind and normal wear and tear.  
Our goods come with guarantees that cannot be excluded under the Australian Consumer Law. You are entitled to a replacement or refund for a major failure and for compensation for any other reasonably foreseeable loss or damage. You are also entitled to have the goods repaired or replaced if the goods fail to be of acceptable quality and failure does not amount to a major failure.

To claim warranty, please contact the place of purchase. You will need to show receipt or other proof of purchase. Additional information may be required to process your claim.

Any expenses relating to the return of your product to the store will normally have to be paid by you.  
The benefits to the customer given by this warranty are in addition to other rights and remedies of the Australian Consumer Law in relation to the goods or services to which this warranty relates.

This warranty is provided by: Electus Distribution  
Address 46 Eastern Creek Drive, Eastern Creek NSW 2766  
Ph. 1300 738 555

17