

ELECTUS DISTRIBUTION

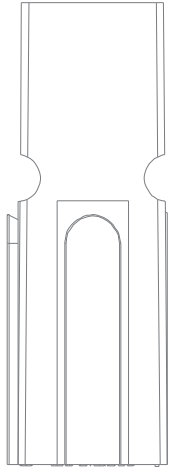

FEATURES

- Flat wiping contact system
- Minimal contact resistance at high current
- Wiping action cleans contact surface during connection/disconnection
- Colored modular housings
- Provides visual identification of proper Mating connector
- Molded-in dovetails
- Secures individual connectors into "keyed" Assemblies which prevents misconnection
- With similar configurations
- Genderless design
- Makes assembly quick and easy and Reduces number of parts stock



Connector Specifications

Rated current(Amperes)	75A
Voltage Ratings (Volts)	600V
Contact Barrel Wire Size	6-12AWG 13.3-3.3mm ²
Maximum Wire Insulation Diameter	0.44inches 11.2mm
AVG Contact Resistance(micro-ohms)	<200
Insulation Withstanding Test Voltage (Volts AC/DC)	2200V
Contact Retention Force (lbf)	50lbf
Life	
a.No load (Contact/Disconnect Cycles)	To 10,000
b.under Load (Hot Plug 250 cycles @ 120V)	50A
AVg. Connection/Disconnect (lbf)	7lbf
operating Temperature Range °C	-20 °to 105 °C -4 °to 221 °F
Flammability Rating of Housing Material	UL 94-V0
Contact Material	Silver plated copper

PT4409

Datasheet

SN75 Housing

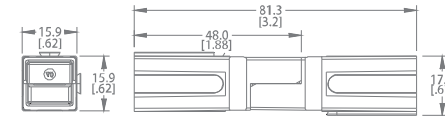

DIMENSIONS ARE:[INCH] MM

Part Number	Housing Color
SN5916G7	Red
SN5916G6	Green
SN5916G4	Black
SN5916G5	White
SN5916	Blue
SN5916G15	Yellow
SN5916G14	Orange
SN5916G16	Gray

SN75LOCK Housing

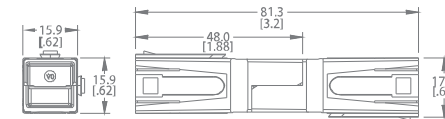

Part Number	Housing Color
SN75LOKRED	Red
SN75LOKGRN	Green
SN75LOKBLK	Black
SN75LOKWHT	White
SN75LOKBLU	Blue
SN75LOKGRA	Gray

SN75Contact

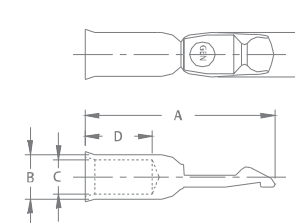

Part Numbers	Mating Force	Wire Size		-A-		-B-		-C-		-D-		-E-	
		AWG	mm ²	Inch	mm	Inch	mm	Inch	mm	Inch	mm	Inch	mm
SE5900	High	6	13.3	1.18	30	0.28	7.1	0.22	5.6	0.43	10.9	0.28	7.1
SE5915	High	10/12	5.3/3.3	1.18	30	0.28	7.1	0.14	3.5	0.43	10.9	0.28	7.1
SE5952	High	8	8.4	1.18	30	0.28	7.1	0.19	4.8	0.43	10.9	0.28	7.1