

Rolife

Alice's Tea Store

— DG156 —



Brief Introduction

WARNING:

01. The product requires 2“AAA/LR03/AM4 1.5V” batteries. (Batteries for self-preparation).
02. Before loading or removing batteries, please loosen screws on the cover of the battery box with the screwdriver first.
03. Non-rechargeable batteries are not to be recharged.
04. Rechargeable batteries are only to be charged under adult supervision.
05. Rechargeable batteries are to be removed from the toy before being charged.
06. Different types of batteries or new and used batteries are not to be mixed.
07. Batteries are to be inserted with the correct polarity(+ and -).
08. Remove the exhausted battery in time.
09. The power supply terminal cannot be short circuited.
10. Do not connect the wire to a mains outlet.
11. The product is not to be connected to more than the recommended number of power supplies.
12. Check each part before assembly.If the part is damaged,fix it well before assembly.
13. Please keep the product away from substances flammable and humid environments to prevent damage.
14. The instruction must be retained since it contains important information.

ATTENTION:

1. This product is suitable for people over 14 years old. Children should be guided by adults.
2. This product contains small parts. Please use it carefully to avoid accidental ingestion and room breathing.
3. Please install the electronic components correctly and test whether the circuit is normal after completion.
4. Please read the instructions carefully before assembly to confirm that the parts are not damaged or missing.
5. Please carefully cut the parts and make sure they are firmly pasted when using glue.
6. Some small parts may be embedded in grooves, and please pay attention to check it.
7. This product needs to be made with auxiliary tools. Please select it reasonably to avoid injury.

The guidance of instructions:

1、P1-P2: Please read this page before assembling to understand the materials in the box and get ready to assemble.

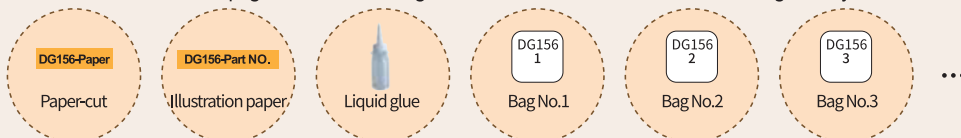

2、P3-P10: Detailed assembly steps of some small part. All the dimension in the instruction is shown in millimeter (mm).

3、P10: Installation steps of lamps. (2 AAA batteries for self-preparation).

4、P11-P14: The building steps of component and framework and its illustration.

Tips of glue:

(Glue is a gift not for sale. If it becomes dry or expired due to time or environmental problems, you can use your own glue to assemble.)

1. Liquid glue is used for wood parts and other materials. You can assemble the next one while the liquid glue is drying.
2. How to open the liquid glue:

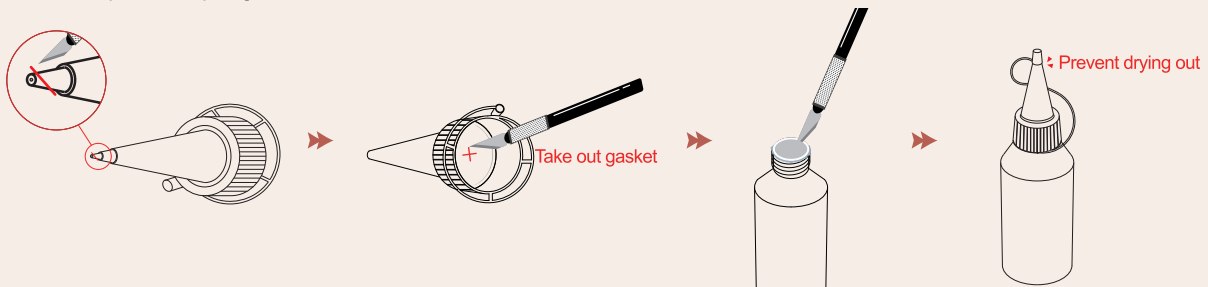

3. Do not use too much glue in case of longer time to dry. It may also affect the appearance of completed products.

Part bag explanation: (The parts are small and please do not pour out all parts from the bag.)

Bag No.1 Density Board, colored large board, cardpaper and etc.

Bag No.2,3,4 Colored small board

Bag No.5,6 Other parts

1
DG156

Bag Number

In case of missing materials, put the remains back to original bags after taking enough dosage in each step.

Assembly illustration:

Tools instructions:(Use tools as shown in the figure below)

Tools included



Transparent sheet cutting explanation:

1. Cut the sheet into specific sizes based on the instructions.
2. Peel off the protective film on both front and back before using it.

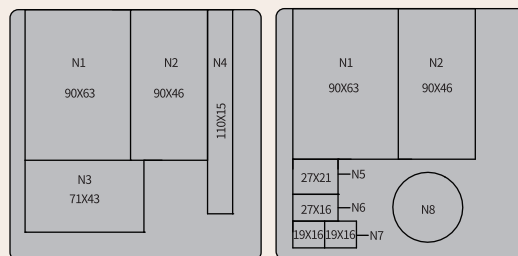

Tools not included

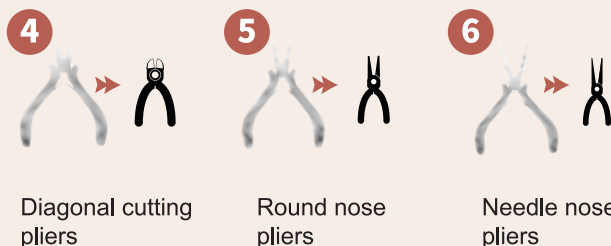
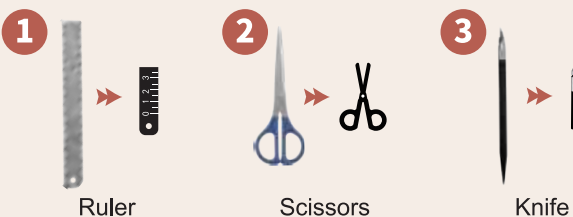

Wood parts instructions:

1. Remove the wood part with a knife for preparation. (It's easier to remove parts by cutting the knots of both sides.)

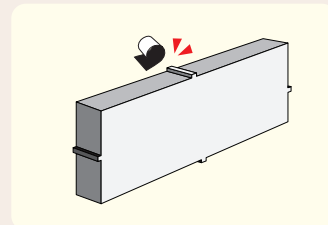
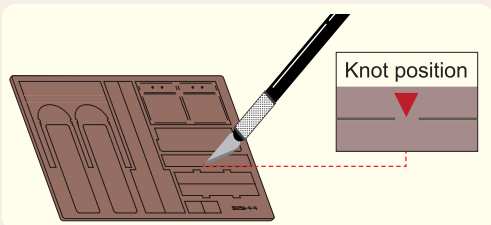

2. Polish the edge of the board with the sandpaper to make its sides flat.

Paper-cut&part number explanation:

1. Paper-cut: Use after cutting. (K)(M)(N) are the codes.



Cut the paper-cut along the edge lines.

2. Part number: Find the part according to the material list and the 1:1 part illustration paper. Check its number and size carefully before assembling.

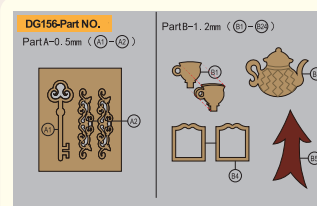

Cabinet



Material List:

Wood pieces

1 Wood pieces 16pcs

2-B24

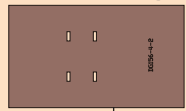

1-C21

1-C35

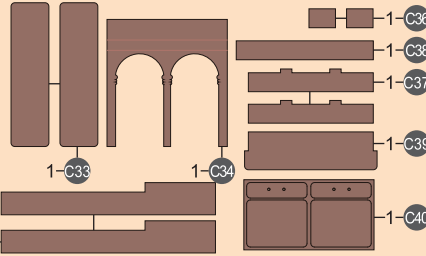

Other pieces

2 Brown wire L30mm 1pc(Bag No.6)

3 Golden bead 2pcs(Bag No.6)

4 Golden bar-type sticker 1pc(Bag No.1)

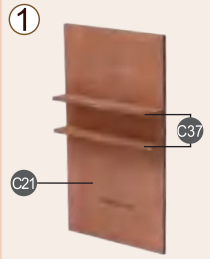
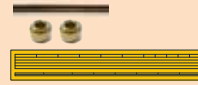

Glue as shown.



Edge aligned and glue C35 as shown.



Glue C40 centrally as shown.



Glue C36 and C38 as shown.



Align the boards on both up and down. Glue as shown.

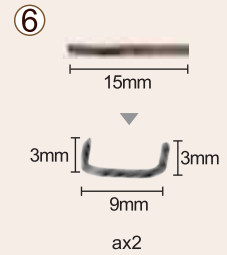

Bend the wire based on the size as shown.

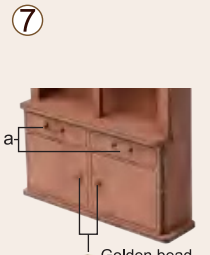

Glue as shown.

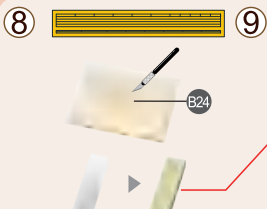

Cut the boards off. Then take the sticker out shown as orange in the figure. Glue the sticker on the boards as shown.



Glue on the position as shown. Completed.

Table



Material List:

Wood pieces

1 Wood pieces 10pcs

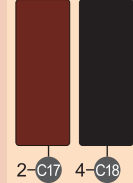

Paper-cut

2 Paper-cuts K6, K10

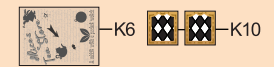

Other pieces (Bag No.1)

3 Golden bar-type sticker 1pc

4 Double sided adhesive 1pc

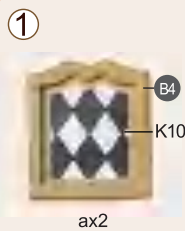

Glue K10 on B4 along reference lines.

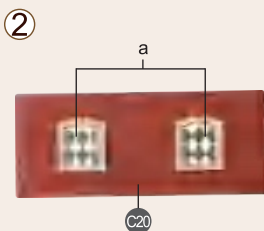

Glue along reference lines.

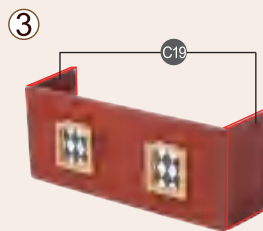

Glue C19 on the edge side of C20.

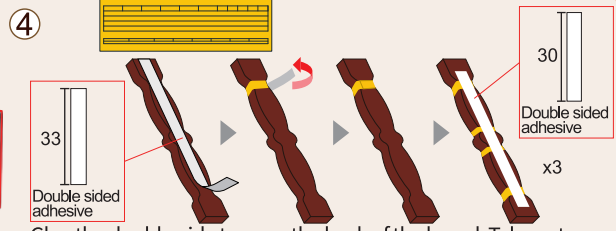

Glue the double tape on the back of the board. Take out the sticker shown as orange in the figure. Then wrap it around the position as shown. Fix the stickers with double-side tape as shown again.



Glue as shown. The junctions face inwards.

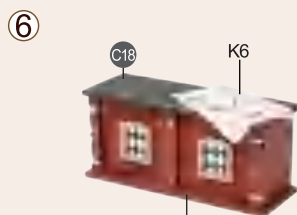

Glue the boards centrally. Then glue K6 as shown.

Dice



Material List:

Wood pieces

1 Wood pieces 10pcs

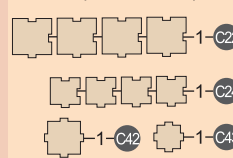

Paper-cut

2 Paper-cuts P3, P7

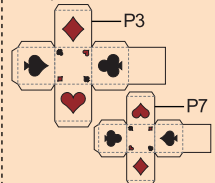

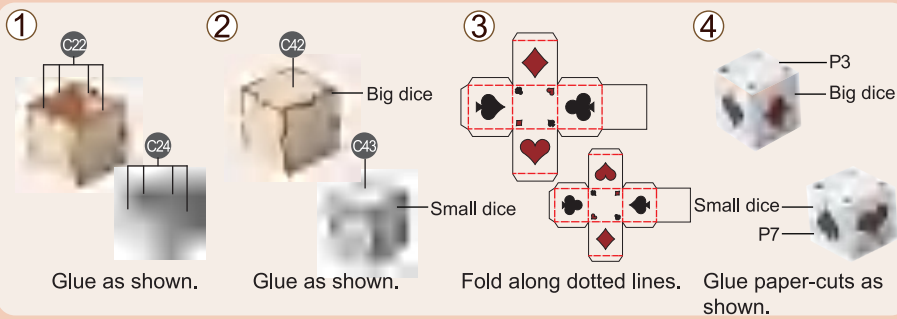

Street Lamp

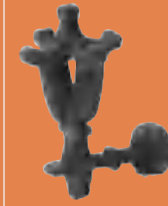

Material List:

Wood pieces

- 1 Wood pieces 5pcs

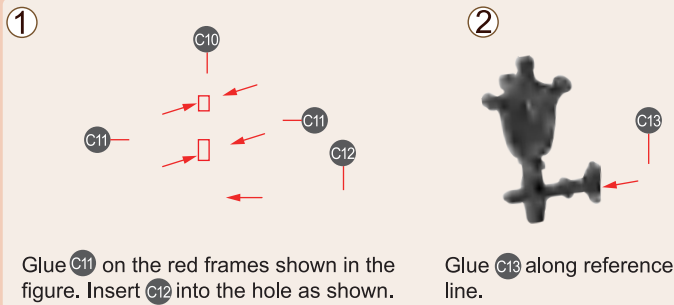
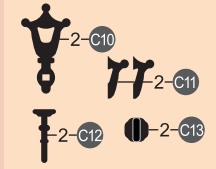

Display Case



Material List:

Wood pieces

- 1 Wood pieces 6pcs

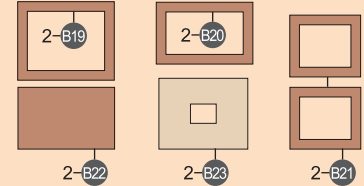

Paper-cut

- 2 Paper-cut P9



Other pieces

- 3 A cup and saucer set 2pcs (Bag No.5)
4 Transparent sheet N5, N6, N7 1pc (Bag No.1)

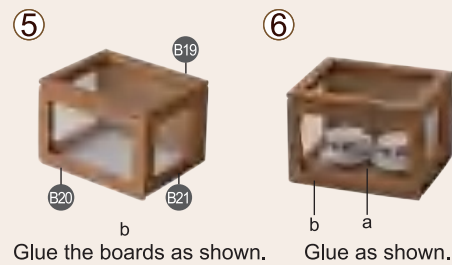
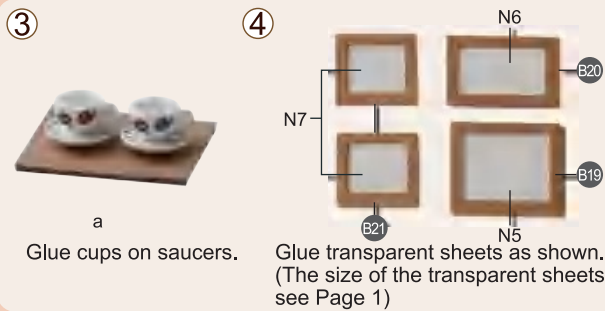
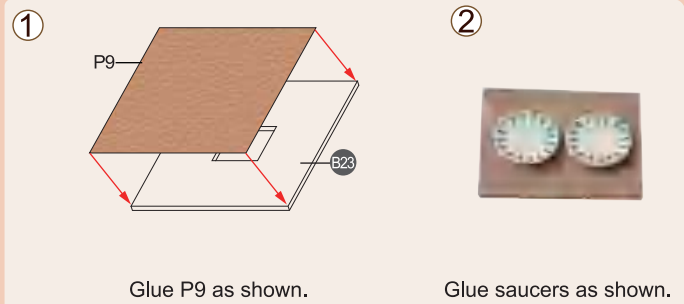
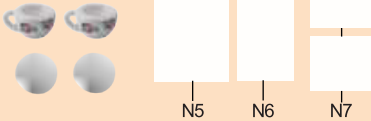

Clock



Material List:

Wood pieces

- 1 Wood piece 1pc

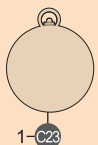

Paper-cut

- 2 Paper-cuts M1, M2

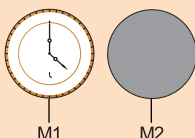

Other pieces

- 3 Transparent sheet N8 1pc
4 Golden bead 1pc (Bag No.6)

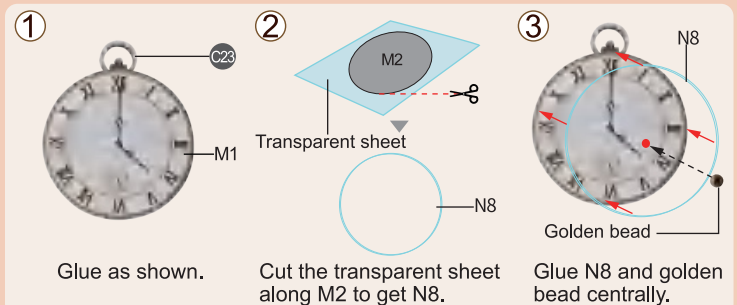

Doorplate

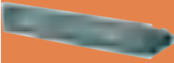

Material List:

Wood pieces

- 1 Wood pieces 7pcs

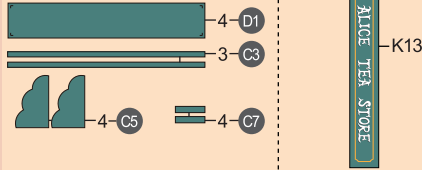

Paper-cut

- 2 Paper-cut K13



①

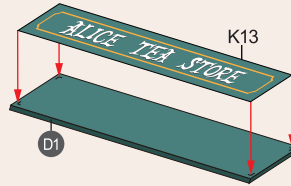

Glue K13 on D1 along reference lines.

②

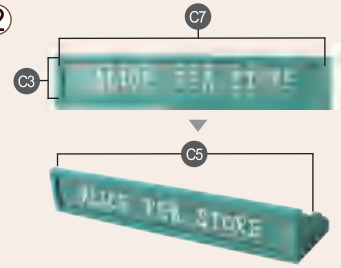

Glue as shown.

Ornament



Material List:

Wood pieces

- 1 Wood pieces 3pcs



Paper-cut

- 2 Paper-cuts P1, P13, K3, K11



Other pieces

- 3 Golden photo frame 1pc (Bag No.5)
4 Golden bead 2pcs (Bag No.6)



①

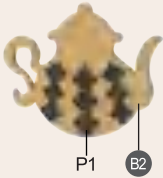

Ornament 1

Glue P1 on B2 along reference line.

②

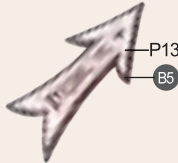

Ornament 2

Glue it centrally as shown.

③



Ornament 3

Cut extra board as shown. Glue paper-cut and bead on both front and back of B3 as shown.

④



Ornament 4

Glue as K11 on the frame along reference lines.

Bunny



Material List:

Wood pieces

- 1 Wood piece 1pc



1-C41

Other pieces

- 2 Butter paper 1pc (Bag No.1)



①

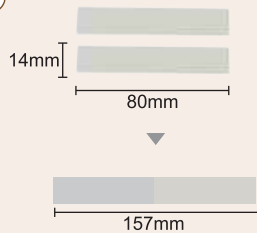

Cut based on the size as shown. Then glue as shown.

②

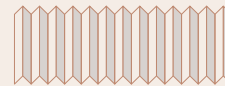

Fold at every 3mm. Complete as shown.

③



Bend as shown. Glue it on the neck of Bunny.

Broom



Material List:

Other pieces

- 1 Golden bar-type sticker 1pc (Bag No.1)
2 Toothpick 1pc (Bag No.5)
3 Khaki paper yarn 1pc (Bag No.5)
4 Small brown broom 1pc (Bag No.5)
5 Black wire L80mm 1pc (Bag No.6)
6 Brown wire L100mm 1pc (Bag No.6)
7 Double sided adhesive 1pc (Bag No.1)



①



Take out the sticker shown as orange in the figure. Then wind it around the small broom as shown.

2 Double sided adhesive



Fix the back joint with double-side tape as shown.

②

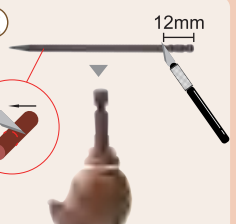

Cut the toothpick based on the size. Then insert it into the hole as shown.

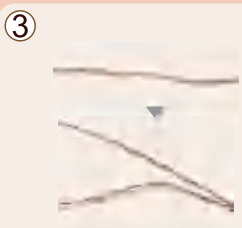

Divide the paper yarn into two strands.



Cut the paper yarn based on the size as shown.



Make a broom as shown.

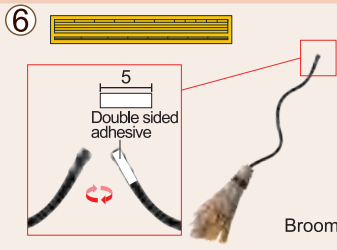

Bend as shown. Then flatten the head of the broom. Fix the back joint with double-side tapes as shown.



Material List:

Other pieces

- ① Blue bead 1pc(Bag No.5)
- ② Golden bead 1pc(Bag No.6)
- ③ Golden bead cap 1pc(Bag No.6)
- ④ Copper eyelet 1pc(Bag No.6)
- ⑤ Round copper button 1pc(Bag No.6)
- ⑥ Flat copper button 1pc(Bag No.6)
- ⑦ Brown wire L70mm 1pc(Bag No.6)

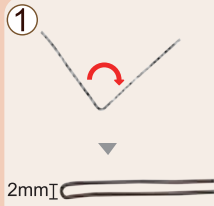

Fold the brown wire in half with round nose pliers.

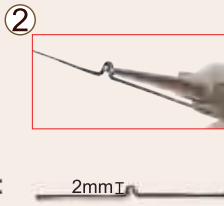

Bend the brown wire with round nose pliers.

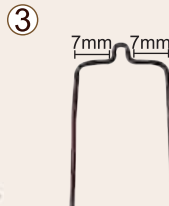

Bend the brown wire as shown.

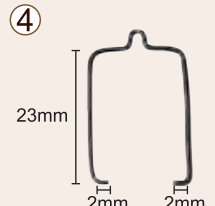

Bend the brown wire as shown. Cut off extra parts.

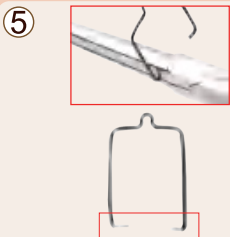

Flatten the part in red frame as shown with needle-nose pliers.



Glue them in order as shown.



Glue as shown.



Glue as shown. Completed.

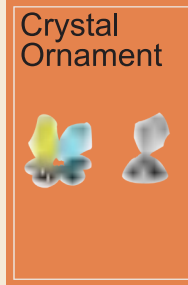

Material List:

Other pieces

- ① Silver bead cap 1pc(Bag No.6)
- ② Golden moon-star receptacle 1pc(Bag No.6)
- ③ Colorful carpolite 3pcs(Bag No.5)



Glue 2 carpolites as shown.

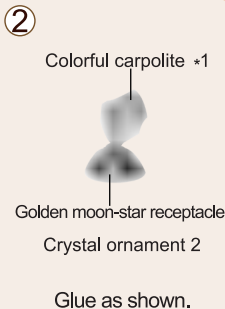

Glue as shown.

Dessert Stand

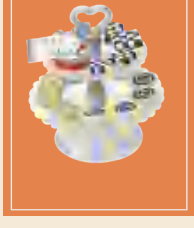

Material List:

Paper-cut

- ① Paper-cut P2



Other pieces

- ② Small plate 1pc(Bag No.5)
- ③ Big plate 1pc(Bag No.5)
- ④ Base 1pc(Bag No.5)

- ⑤ Handle 1pc(Bag No.5)
- ⑥ Bracket 1pc(Bag No.5)
- ⑦ Rainbow cake 1pc(Bag No.5)
- ⑧ Black-white cake 1pc(Bag No.5)
- ⑨ Square cake 1pc(Bag No.5)
- ⑩ Yellow-black rolls 1pc(Bag No.5)
- ⑪ Yellow and white wires L20mm 1pc(Bag No.6)



Cut the polymer clay into slices at 2mm.



Small plate

Place as shown. Fix with glue.



Big plate

Place as shown. Fix with glue.



Base

Glue as shown.

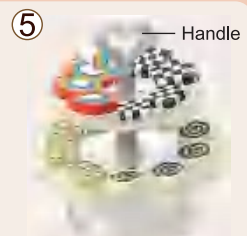

Glue as shown. Completed.

⑥



Cut 20mm yellow and white wires separately. Then peel off their rubber as shown.

⑦

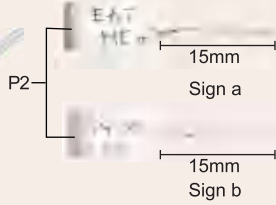

Twine as shown. Complete 2 signs.

⑧

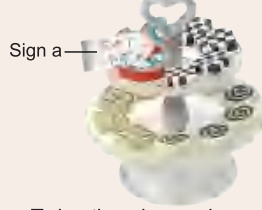

Twine the wire as shown. Then fix it in the place of handle.

Plant



Material List:

Paper-cut

① Paper-cut P11



Other pieces

② Green flower rod L210mm 1pc (Bag No.6)



①

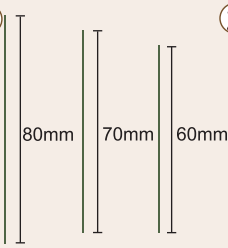

Cut the rod based on the size as shown.

②



Fold the rods in half. Twine as shown.

③



Glue P11 as shown.

Gift Bag



Material List:

Paper-cut

① Paper-cuts P2, P4, P5, P6

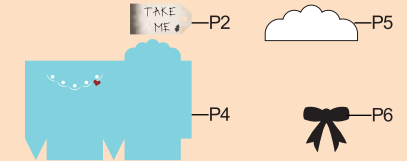

①

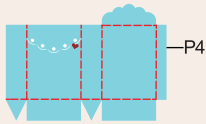

Fold P4 along dotted lines.

②



Glue as shown.

③

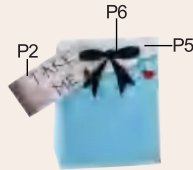

Glue paper-cuts as shown.

Paper Scroll



Material List:

Paper-cut

① Paper-cut M6



①



Roll the paper-cuts up as shown.

Paper Box



Material List:

Paper-cut

① Paper-cut P8

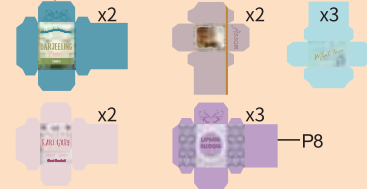

①



Fold paper-cuts along dotted lines. Then make paper boxes as shown.

②

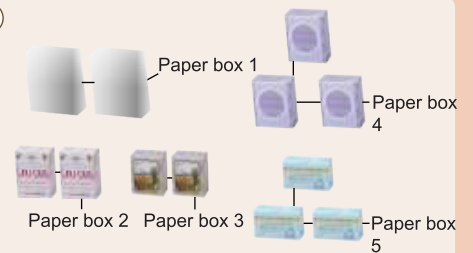

Complete as shown.

Colorful Butterfly

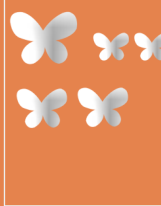

Material List:

Paper-cut

① Paper-cut K15

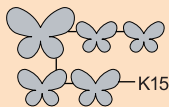

Other pieces

② Dichroic film 1pc (Bag No.1)

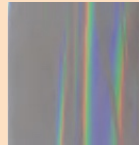

①

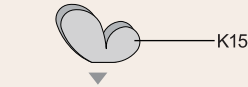

Cut along the edge line of K15. Then get several colorful butterflies.

②

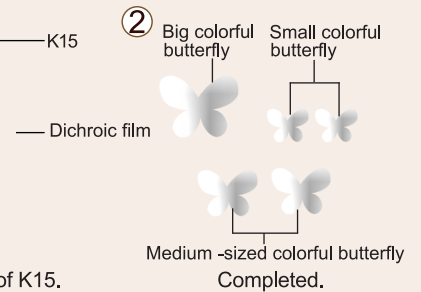

Completed.

Potted Plant



Material List:

Other pieces

- 1 Orchid 1pc(Bag No.5)
- 2 White flower pot 1pc (Bag No.5)



①

Trim as shown.

②

Fold tissue as shown. Put it into the pot.

③

Insert the orchid in as shown.

Ceiling Lamp

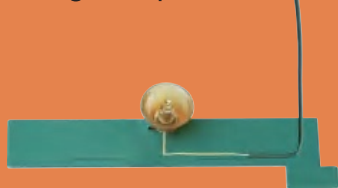

Material List:

Wood piece

- 1 Wood piece 1pc

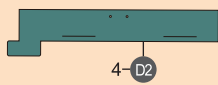

Other pieces

- 2 Lampshade 1pc(Bag No.5)
- 3 Green heat-shrink tube 1pc(Bag No.6)
- 4 Light bead 1pc(Bag No.6)
- 5 Yellow-white wires L450mm 1pc(Bag No.6)
- 6 Brown wire L26mm 1pc(Bag No.6)



①

Cut off the light pins at 5mm.

②

Remove 12mm rubber off both wires in both ends, and wind them separately on the light.

③

Put the heat-shrink tube onto the wires. Heat the tube to shrink.

④

Pass the wires through the lampshade as shown.

⑤

Bend as shown. Put the tube onto the wires at 40mm as shown.

⑥

Bend the brown wire into U-shape.

⑦

Hold the wire up with a. Then pass the wires through the hole.

⑧

Bend the lampshade. Fix it with a.

⑨

Glue the lampshade and wire along interior reference lines of the board. Completed.

Showcase



Material List:

Wood piece

- 1 Wood pieces 19pcs

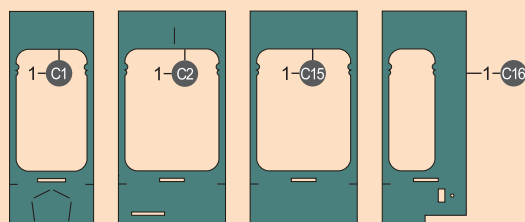
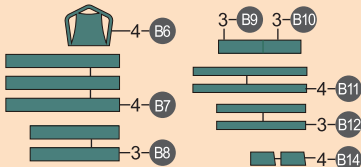

Paper-cut

② Paper-cuts K2, K5, M5



K2



K5



M5

Other pieces

③ White flannelette 1pc(Bag No.1)

④ Golden bar-type sticker 1pc(Bag No.1)

⑤ Transparent sheet N1, N2

⑥ Gold cardboard A1, A2

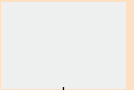

N1

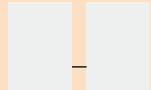

A1



A2

①

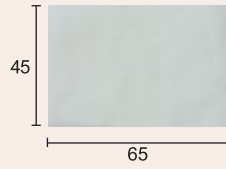

Cut the flannelette as shown.

②

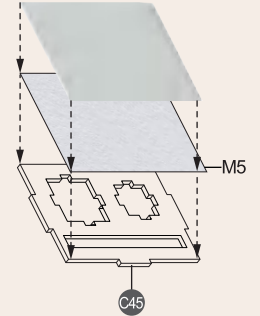

A

Glue them in turns as shown.

③

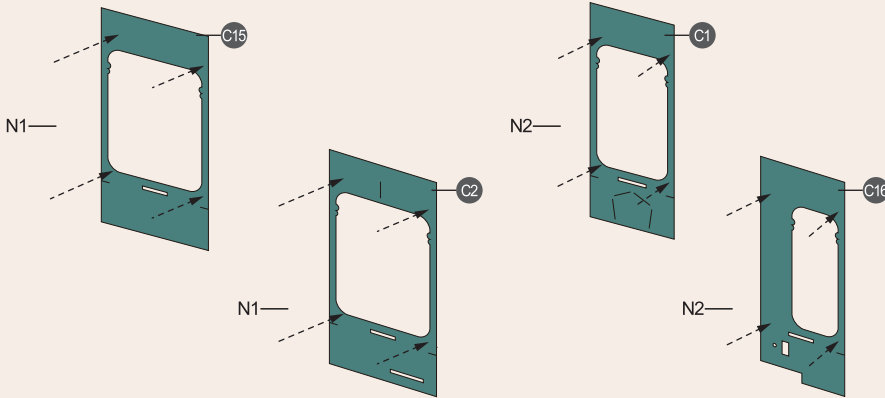

Glue the transparent sheet on the boards centrally.
(The size of transparent sheets see Page 1)

④



Insert A into the grooves of C2 as shown. Then fix with glue.

⑤



Insert and glue as shown.

⑥

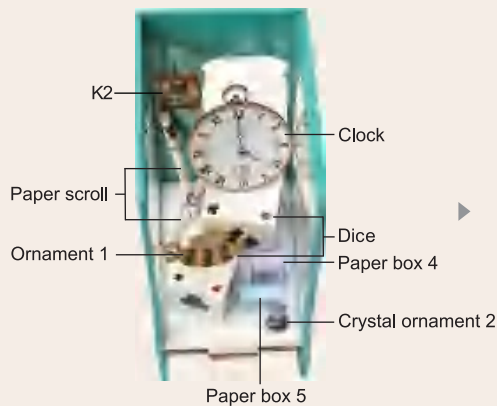

Place small ornaments in turns as shown.

7

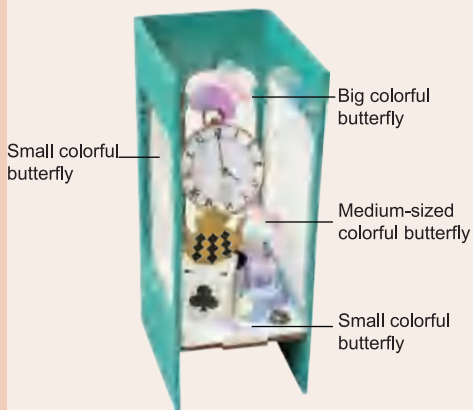

Glue the butterflies as shown.

8



Glue as shown.

9

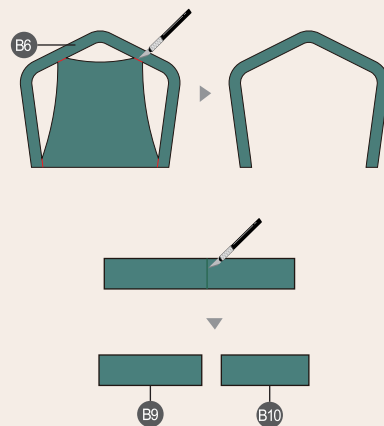

Cut with precision knife. Then polish the cut planes with sandpaper.

10

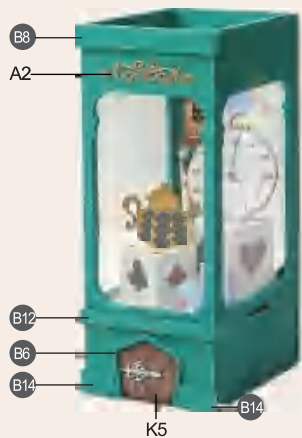

Glue as shown.

11



Glue as shown.

12



Glue as shown.

13



As shown above, paste double-sided tape, then paste the gold line sticker.

14



Wrap the sticker around as shown. Completed.

15



Front view.

Component A

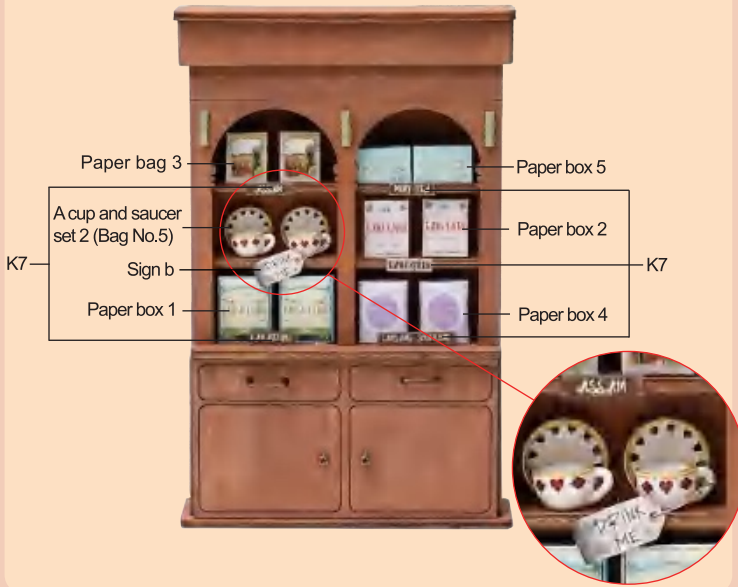

Component B



Frame



Material List:

Wood pieces

① Wood pieces 35pcs

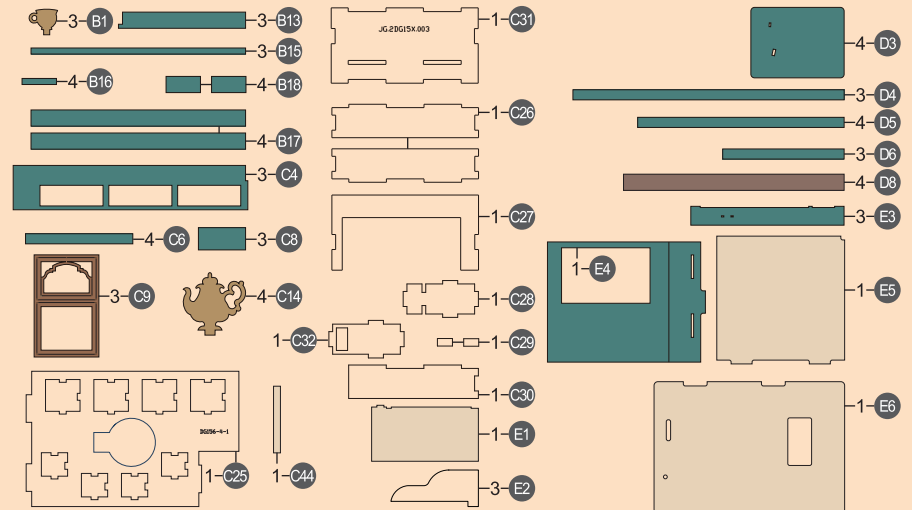

Paper-cut

② Paper-cuts P10,P12,P14,K1,K4,K8,K9,K12,K14,M3,M4,M7

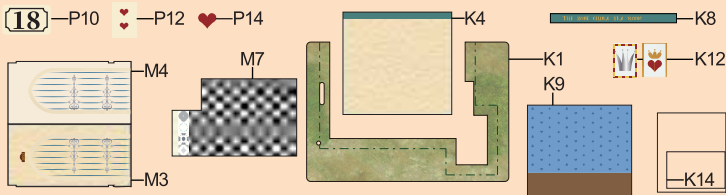

Other pieces

③ Green heat-shrink tube 1pc(Bag No.6) ⑦ Resin crow 1pc(Bag No.5)
 ④ Brown wire L40mm 1pc(Bag No.6) ⑧ Battery box 1pc(Bag No.1)
 ⑤ Tree powder 1pc(Bag No.5) ⑨ Transparent sheet N3,N4
 ⑥ Golden bar-type sticker 1pc(Bag No.1) ⑩ Double sided adhesive 1pc(Bag No.1)



①



Glue transparent sheet on the back of C9.

②



Bend brown wires as shown. Glue on the front side of C9 as shown.

③

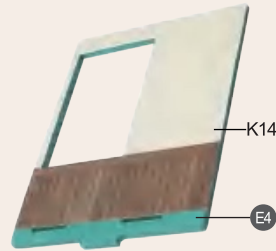

Glue as shown.

④

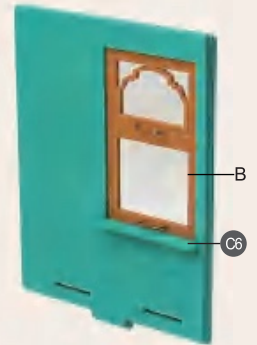

Glue as shown.

⑤



Glue as shown.

⑥



Glue as shown.

⑦



As shown above, paste double-sided tape, then paste the gold line sticker.

⑧

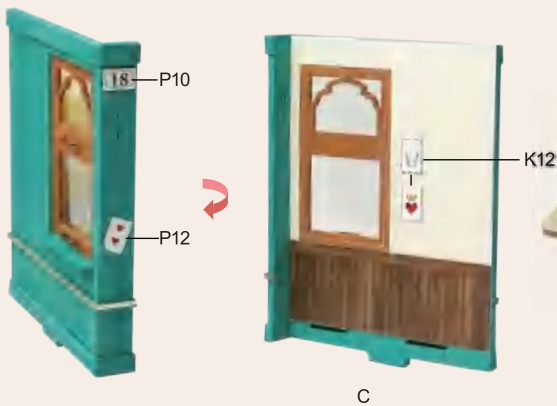

Glue as shown.

⑨



Glue as shown.

⑩



Insert C into the hole site as shown. Fix with glue.

11

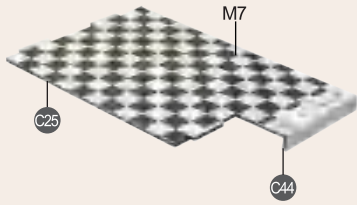

Glue as shown.

12

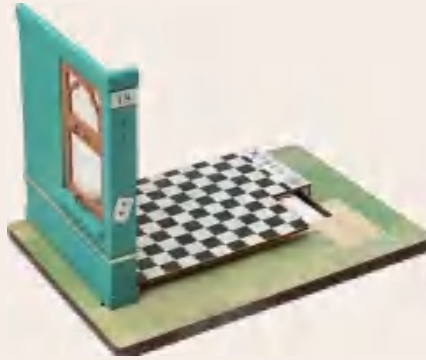

Glue as shown.

13



Glue as shown.

14



Top aligned and glue as shown.

15

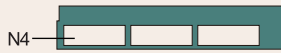

First glue the transparent sheet on C4 as shown. Then glue C4 along reference line.

16

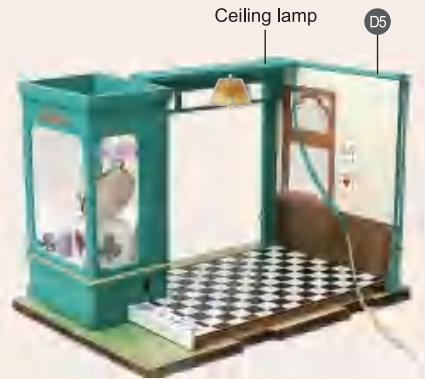

Glue as shown.

17



Fix the wires with glue.

18

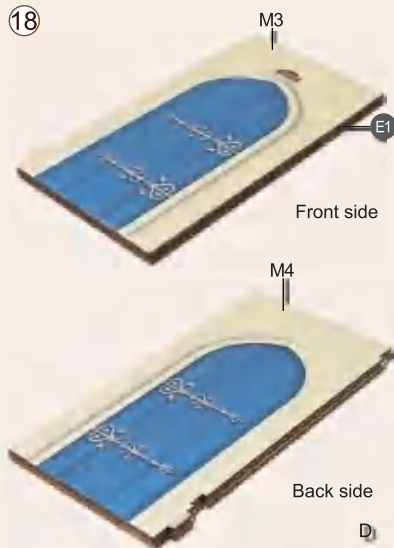

Glue it on both front and back of the board separately.

19

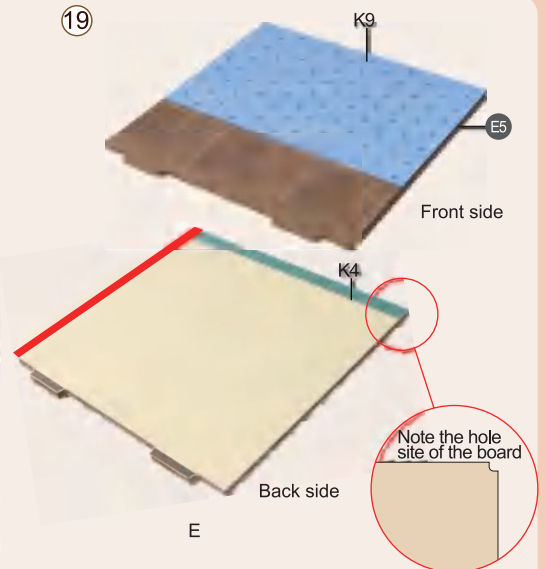

Glue it on front side and back side separately. (Do not cut red area off shown in the figure)

20



Insert D into grooves as shown.

21



Align E with two walls. Fix with glue.

22



Cut L110mm heat-shrink tube, and put it onto the wire as shown. Then glue E2 as shown.

23

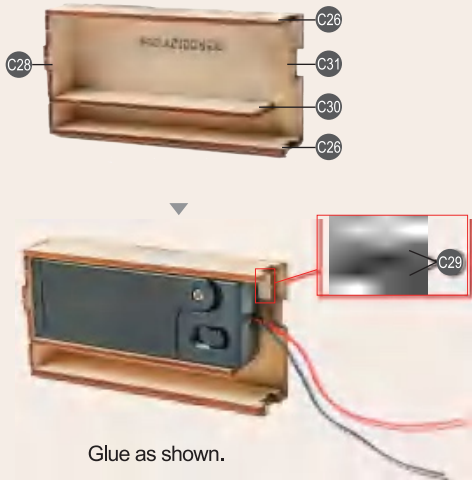

Glue as shown.

24

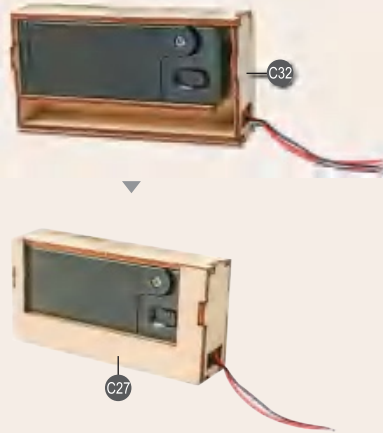

Glue as shown. Pass the wires through the hole.

25



Unscrew the back cover with screwdriver. Put 2 AAA batteries in. (Batteries for self-preparation)

26



Remove 10mm rubber on the top of the wire of battery box with scissors.

27

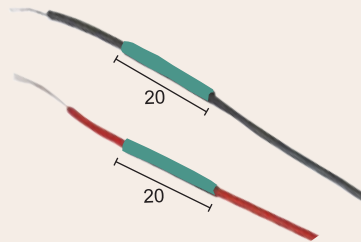

Cut rest heat-shrink tubes based on the size. Then put them through the wires as shown.

28



Connect the wires as shown. Yellow to red, white to black.

29



Connect the wires as shown. Glue the battery box centrally on the back of the board.

30



Tidy the wires as shown. Put the exterior wires into the small hole.

31

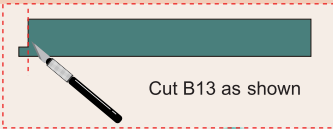

Cut B13 as shown

32

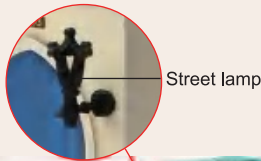

Street lamp



Align and glue as shown.



Glue the street lamp along reference line.

33



Align and glue as shown.

34



Glue as shown.

35



Insert the ornaments into the prepared holes. Fix with glue.

36



Glue as shown. Then glue some tree powder on position as shown.

Assembly Sequence

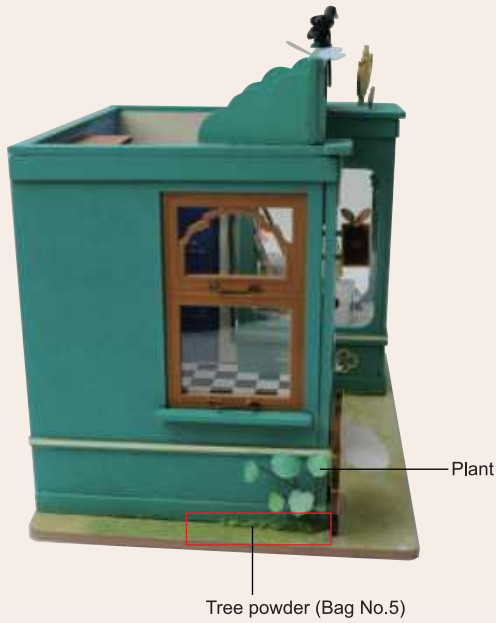

Glue the plant and tree powder as shown.



Glue tree powder and potted plant as shown.

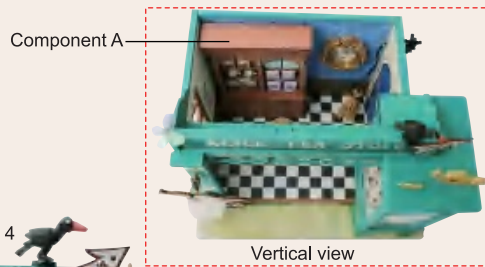

Complete the framework as shown.



Put small components in. Completed.



Completed.

MYSTIC ARCHIVES



Name: Alice's Tea Store
Model No.: DG156
Assembled Size: 220*158*182mm



Name: Mose's Detective Agency
Model No.: DG157
Assembled Size: 202*148*158mm



Name: Kiki's Magic Emporium
Model No.: DG155
Assembled Size: 215*153*175mm

MANUFACTURER:

Robotime C&C (Jiangsu) Co., Ltd.

ADDRESS:

No. 18 Changxing Road, Shuyang, Suqian City, Jiangsu Province, China

Designed by **ROBOTIME**

www.robotime.com

MADE IN CHINA