

# ***1:20 Scale R/C Car Construction Kit***



**USER MANUAL**

**KJ9070**



## PLACEMENT OF UV STICKERS

### How to use the UV stickers:

1. Take off the transfer printing sticker
2. Align and paste it
3. Press and then peel off the transparent film to complete



3



4



1

2





## SAFETY & WARNINGS

### ! ATTENTION

- When using tools like knives to assemble this product, adult supervision is needed, and special attention should be paid to avoid personal injury.
- This product should be kept properly to prevent children from accidental ingestion.
- The removed parts shall be properly placed where is out of children's reach of.
- Plastic bags are not toys and might cause a choking hazard. Please dispose of them properly after unboxing.
- These rubber parts may contain sharp tips. To avoid personal injury, please be careful while assembling and transporting the model.
- Only alkaline batteries or rechargeable batteries is applicable.
- Do not mix different types of batteries or old and new batteries. Depleted batteries should be removed from the model.
- The battery replacement shall be implemented under adult supervision with the two poles aligned correctly to avoid short-circuit.
- Do not charge non-rechargeable batteries. Take the rechargeable batteries from the model before charging. Make sure the charging process is under adult supervision. Do not charge when the batteries are damaged or leaks.
- Only use batteries of identical type or equivalent to the recommended type.
- Do not insert the wires or components into sockets. Do not connected the toy with excessive power supplies than recommended.
- Do not place the batteries near the source of fire or waters, or knock or have it exposed to the sun.
- If your skin or clothes have contacts with the battery leakage, please have it or them rinsed immediately.
- Charging the rechargeable batteries on a regular basis is conducive to their storage. Please use chargers that are identical or equivalent to the recommended ones for charging.



## REMOTE CONTROLLER DIAGRAM

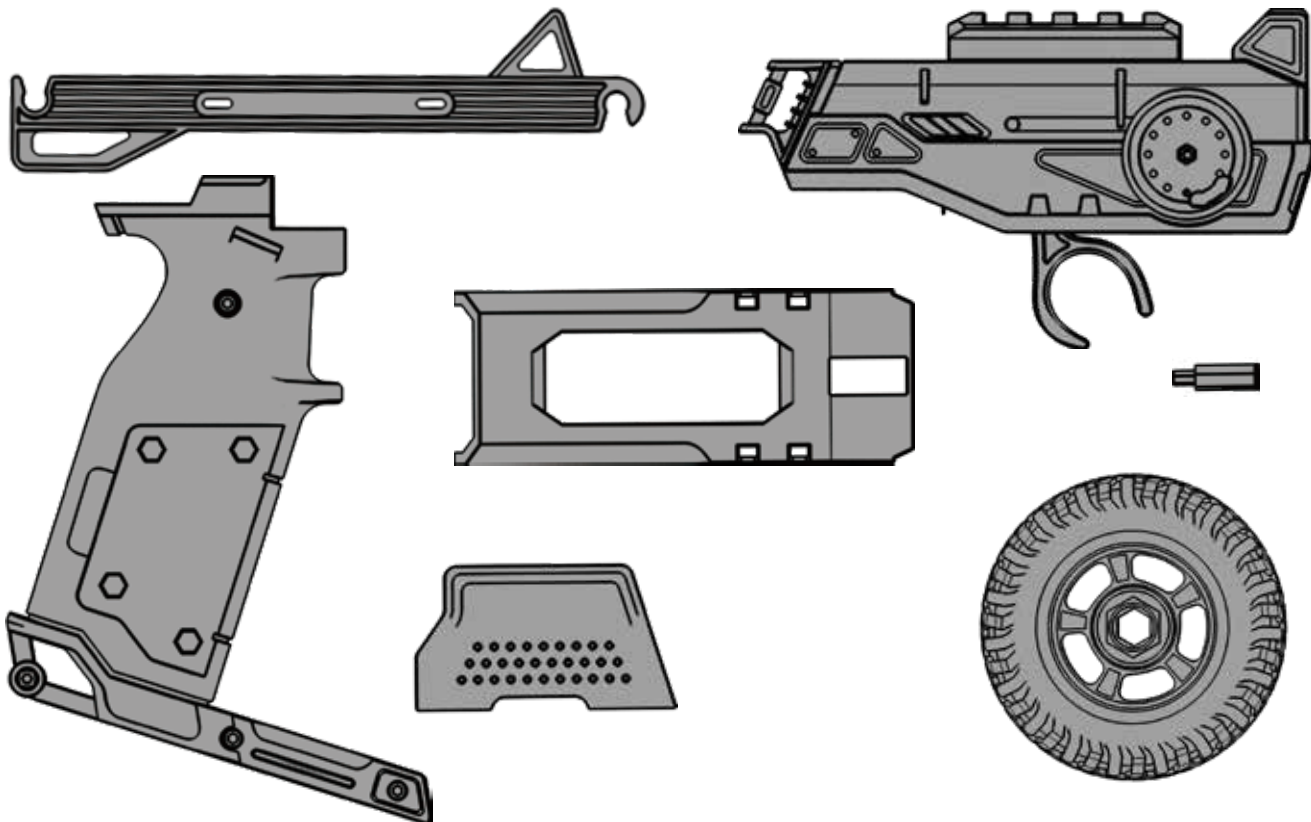



# STEP-BY-STEP ASSEMBLY INSTRUCTIONS

## REMOTE CONTROLLER

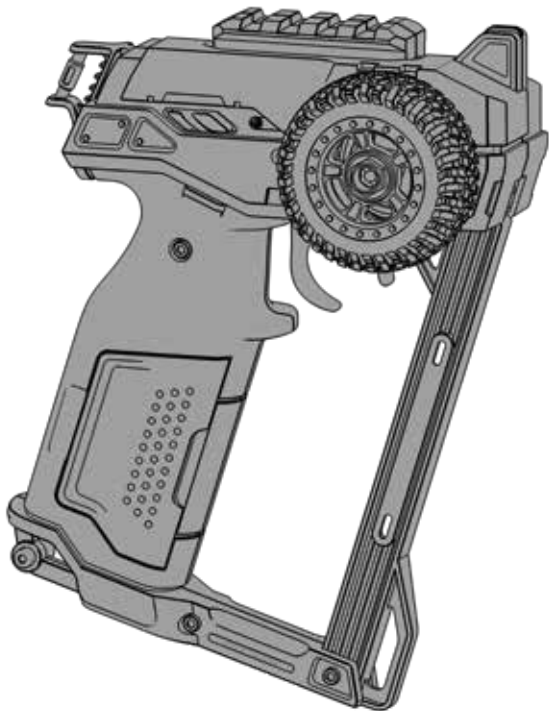

## ASSEMBLY-REQUIRED ACCESSORIES



Main Remote Controller Module \*1

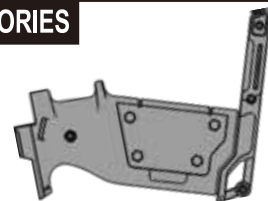

Power Handle Module \*1

## STEP-BY-STEP ASSEMBLY INSTRUCTIONS

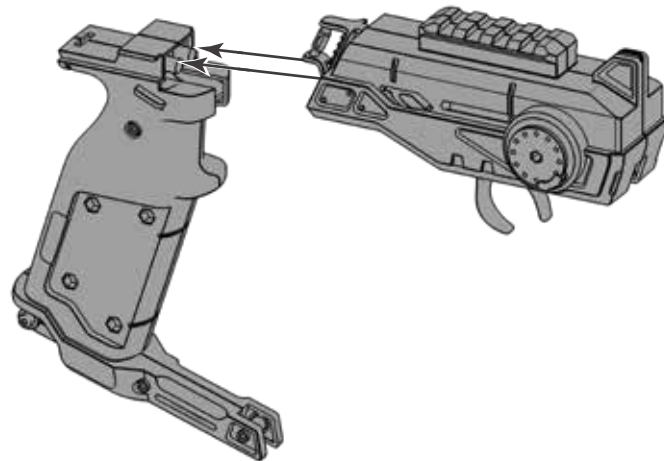

1

## ASSEMBLY-REQUIRED ACCESSORIES

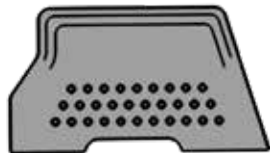

Handle Patch \* 1

## STEP-BY-STEP ASSEMBLY INSTRUCTIONS

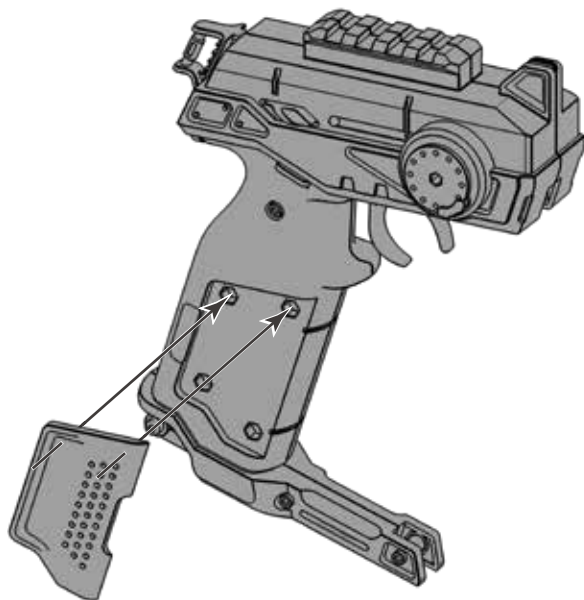

2

## ASSEMBLY-REQUIRED ACCESSORIES



Shaft Plug\* 1



Wheel \* 1

## STEP-BY-STEP ASSEMBLY INSTRUCTIONS

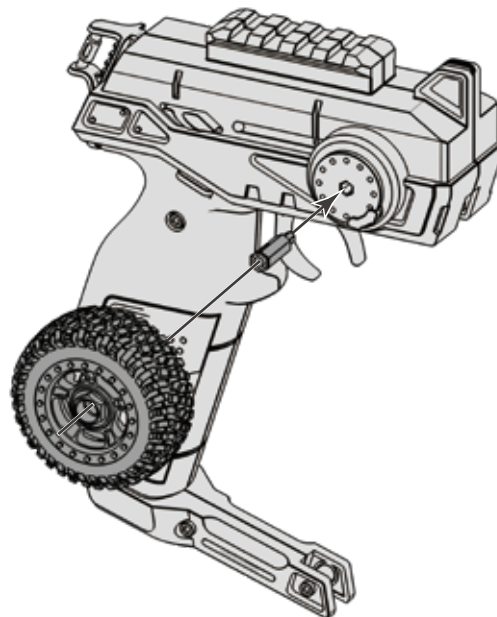

3

### ASSEMBLY-REQUIRED ACCESSORIES

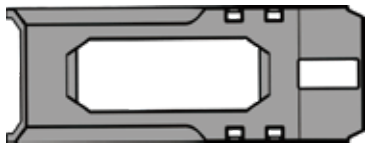

Cover Casing \* 1

### STEP-BY-STEP ASSEMBLY INSTRUCTIONS

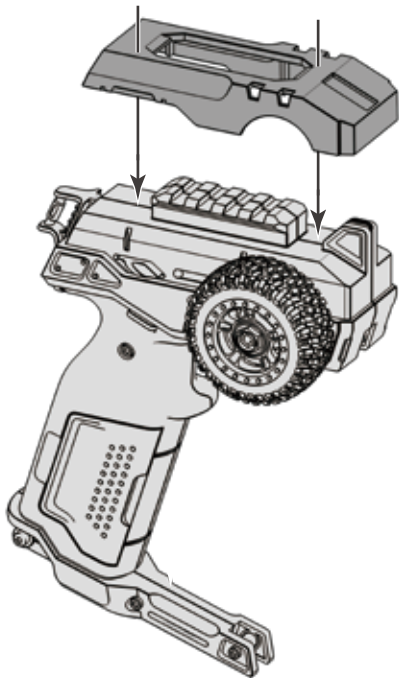

4

### ASSEMBLY-REQUIRED ACCESSORIES



Guard Bar \* 1

### STEP-BY-STEP ASSEMBLY INSTRUCTIONS

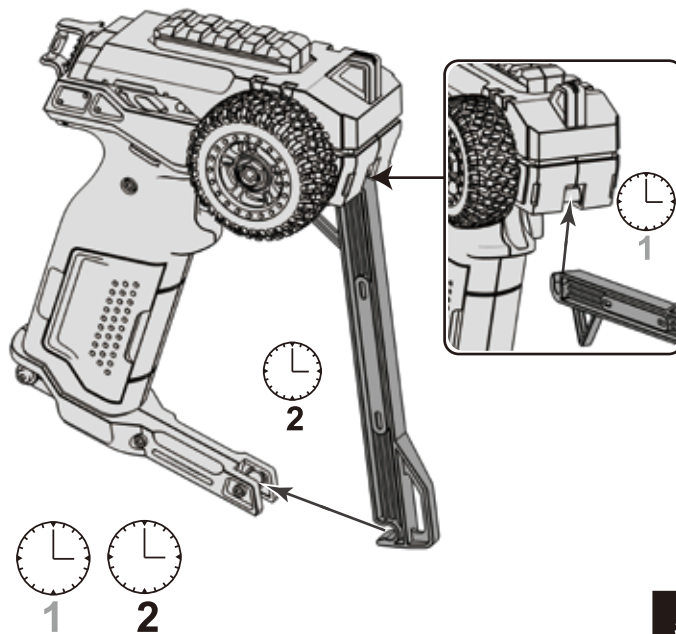

1

2

5



# CAR BODY DIAGRAM

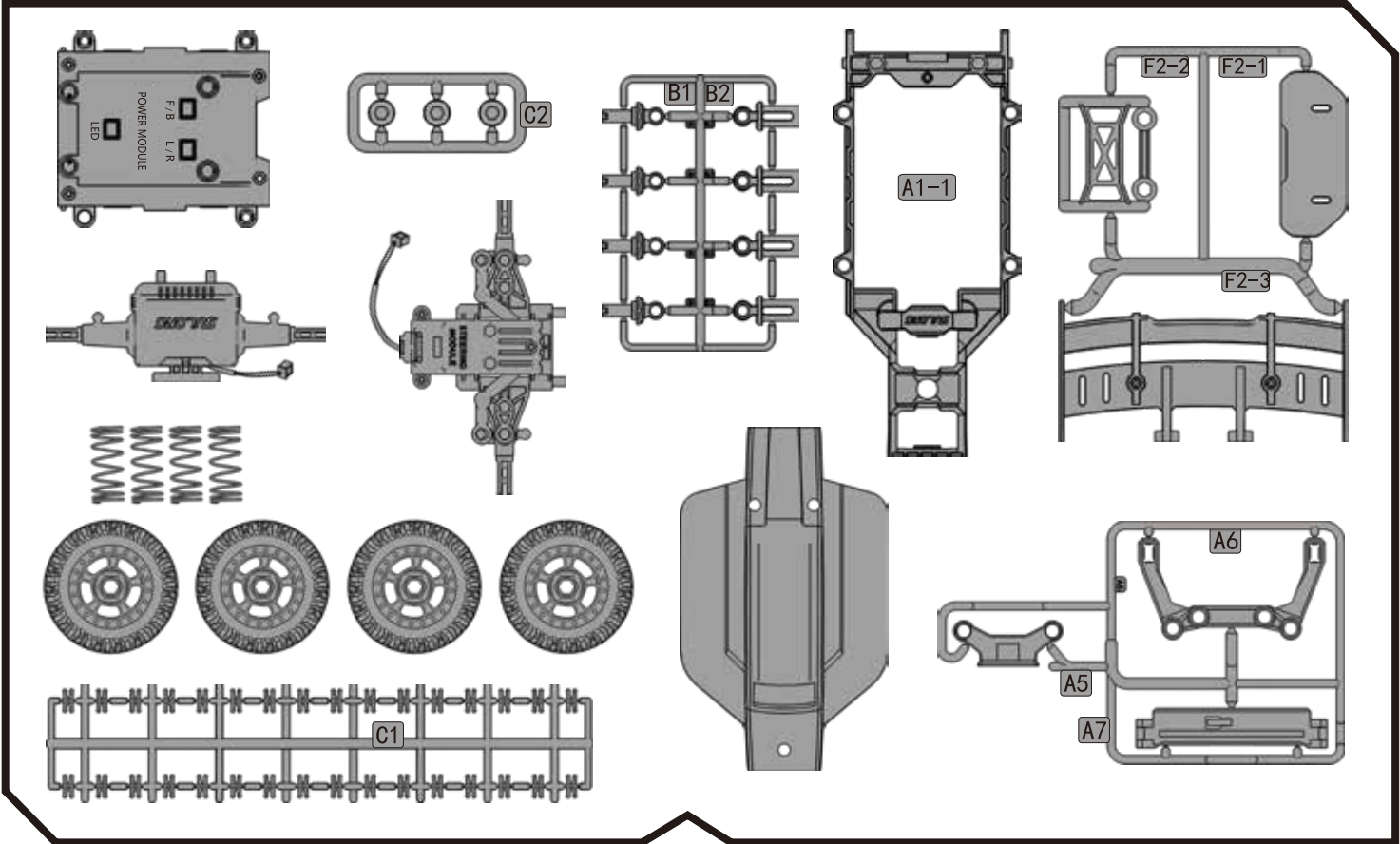





## STEP-BY-STEP ASSEMBLY INSTRUCTIONS

### UNDER-BODY DIAGRAM

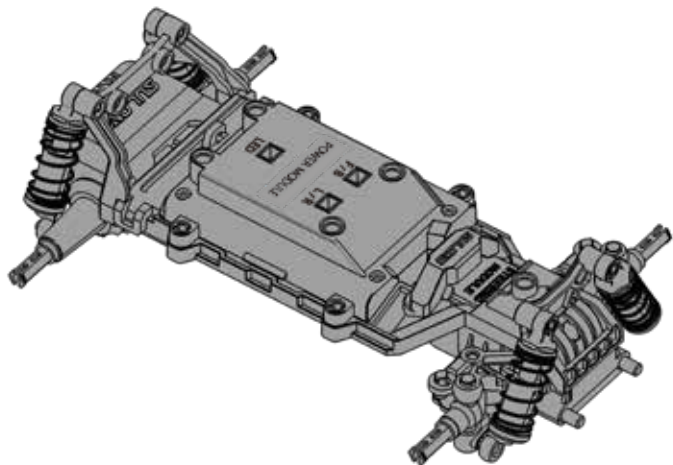

### ASSEMBLY-REQUIRED ACCESSORIES



Latch C1 \* 4

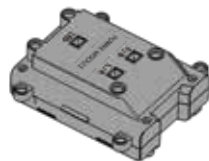

Power Module A2 \* 1



A1-1 \* 1

### STEP-BY-STEP ASSEMBLY INSTRUCTIONS

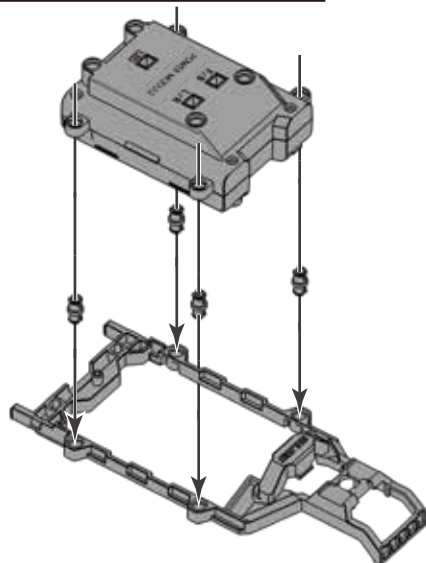

1

## ASSEMBLY-REQUIRED ACCESSORIES



Latch C1 \* 2



A5 \* 1

## STEP-BY-STEP ASSEMBLY INSTRUCTIONS

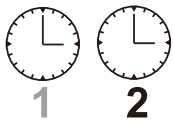
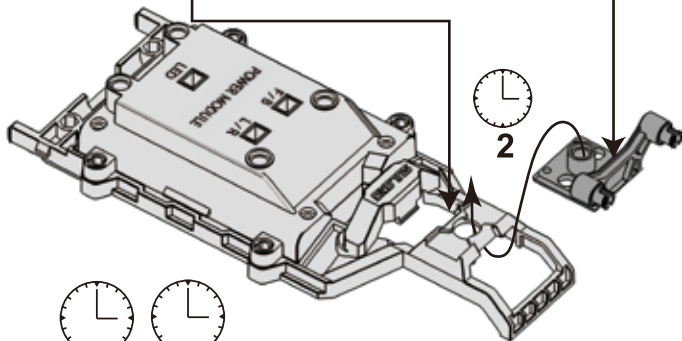
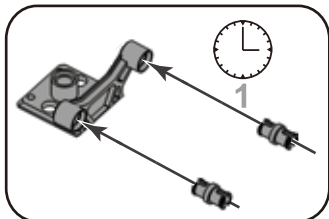
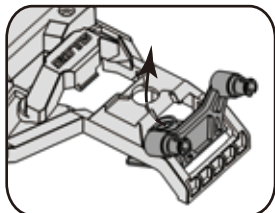

2

1

2

## ASSEMBLY-REQUIRED ACCESSORIES

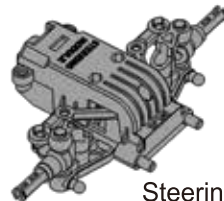

Steering Module A3 \* 1

## STEP-BY-STEP ASSEMBLY INSTRUCTIONS

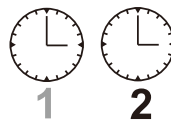
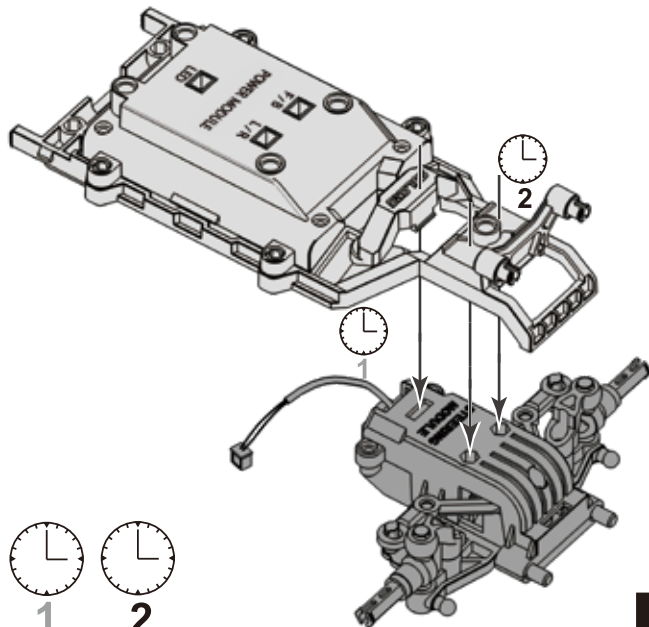

1

2

3

### ASSEMBLY-REQUIRED ACCESSORIES



Shock Absorber B1 \* 2



Spring \* 2



Shock Absorber Tube B2 \* 2

### STEP-BY-STEP ASSEMBLY INSTRUCTIONS

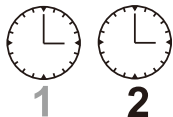

1

2

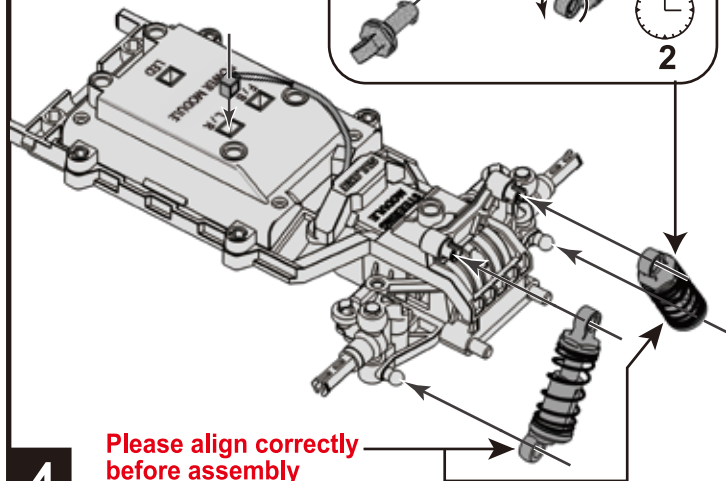
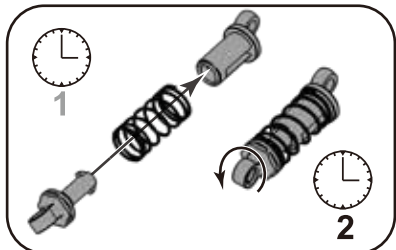

4

Please align correctly  
before assembly

### ASSEMBLY-REQUIRED ACCESSORIES

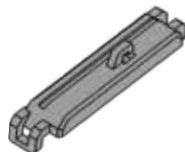

Pressure Strip A7 \* 1

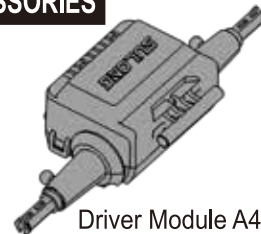

Driver Module A4 \* 1

### STEP-BY-STEP ASSEMBLY INSTRUCTIONS

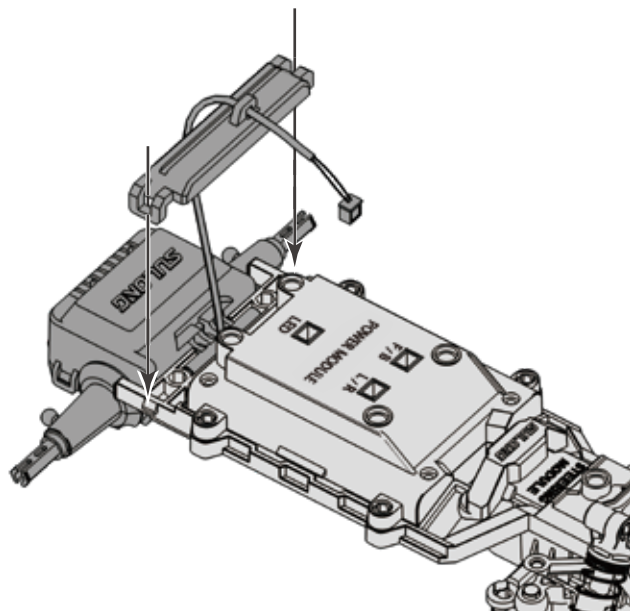

5

## ASSEMBLY-REQUIRED ACCESSORIES

Insert the driver module lead wire into the port of the battery module F/B

## STEP-BY-STEP ASSEMBLY INSTRUCTIONS

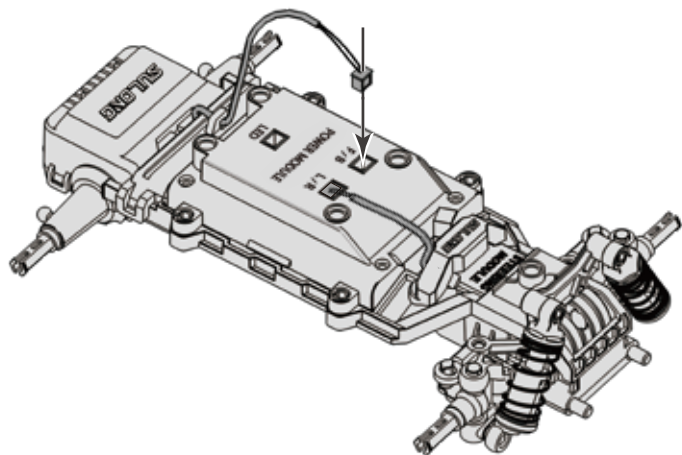

6

## ASSEMBLY-REQUIRED ACCESSORIES



Latch C1 \* 2

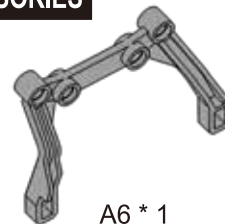

A6 \* 1

## STEP-BY-STEP ASSEMBLY INSTRUCTIONS

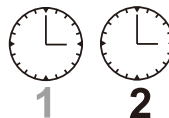

1

2

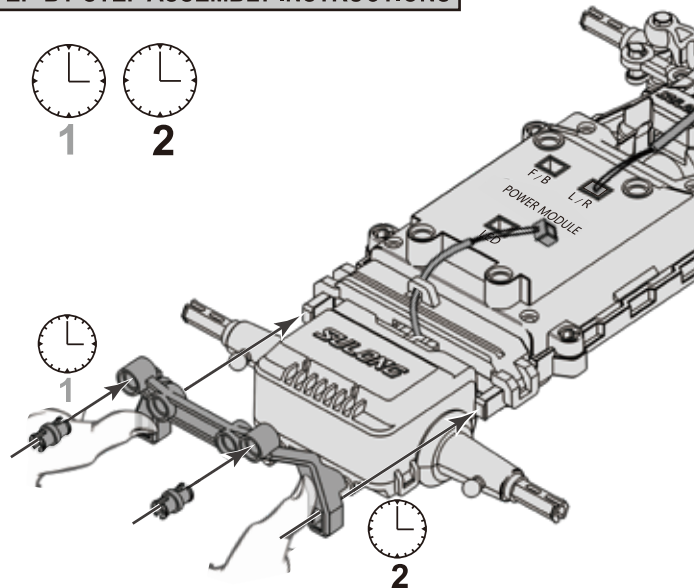

Press firmly in the direction of the arrow to install A6 into the underbody

7

## ASSEMBLY-REQUIRED ACCESSORIES



Shock Absorber B1 \* 2

Spring \* 2

Shock Absorber Tube B2 \* 2

## STEP-BY-STEP ASSEMBLY INSTRUCTIONS

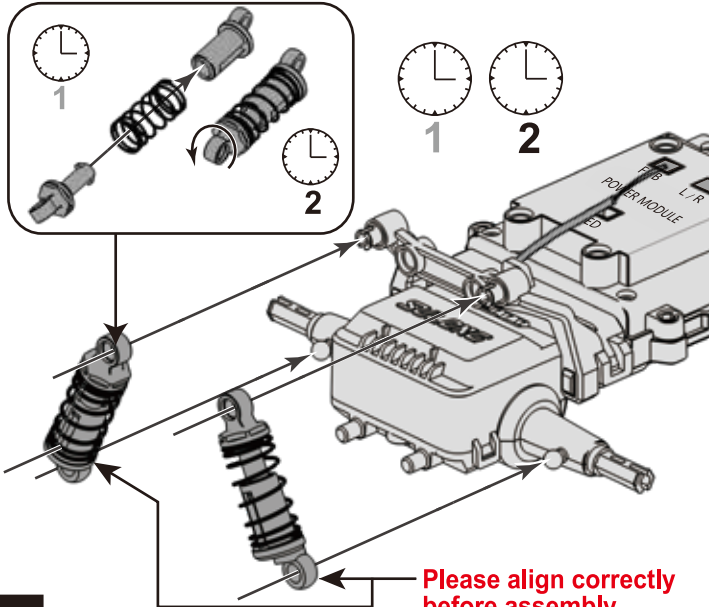

8

## CAR DIAGRAM

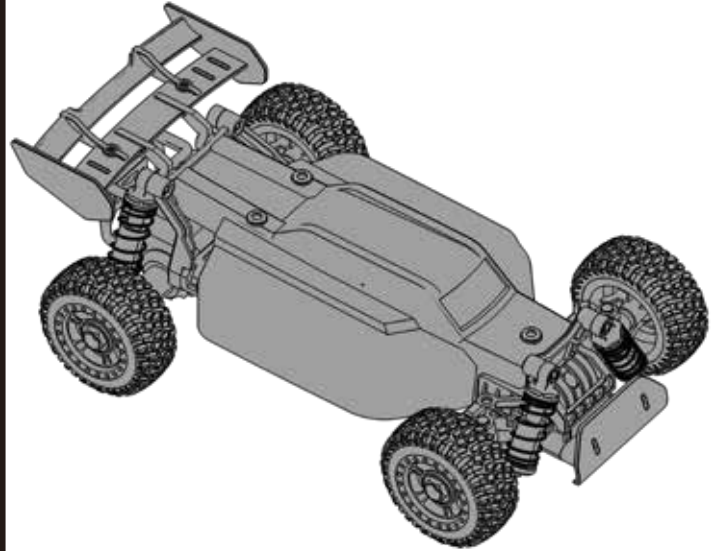

## ASSEMBLY-REQUIRED ACCESSORIES

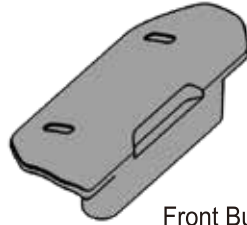

Front Bumper F2-1 \* 1

## STEP-BY-STEP ASSEMBLY INSTRUCTIONS

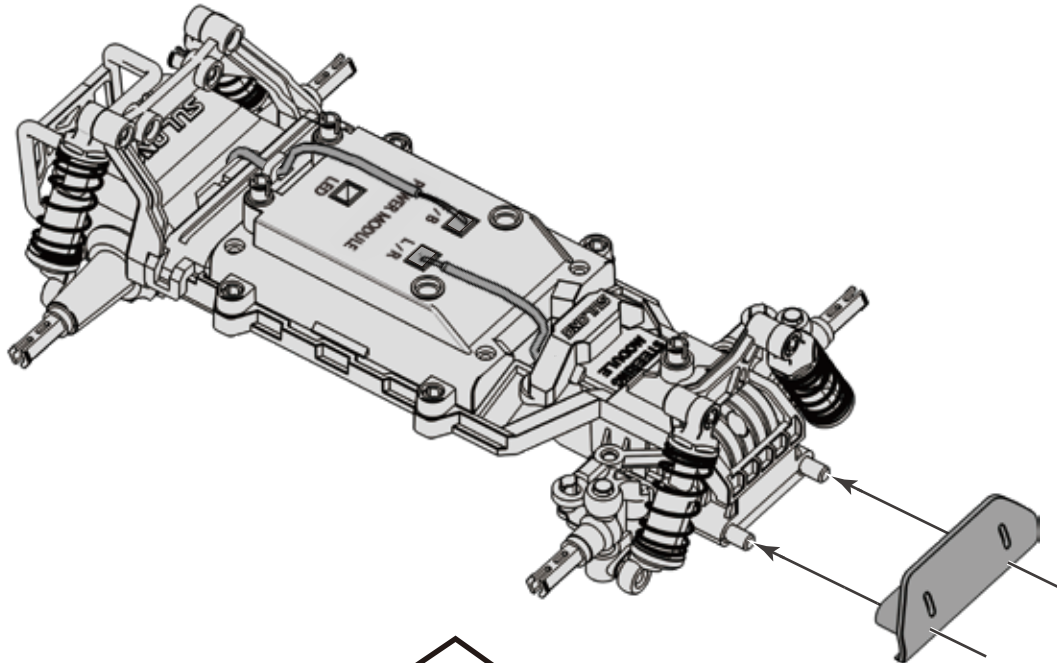

1

## ASSEMBLY-REQUIRED ACCESSORIES



Latch C1 \* 2

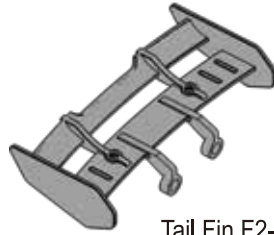

Tail Fin F2-3 \* 1

## STEP-BY-STEP ASSEMBLY INSTRUCTIONS

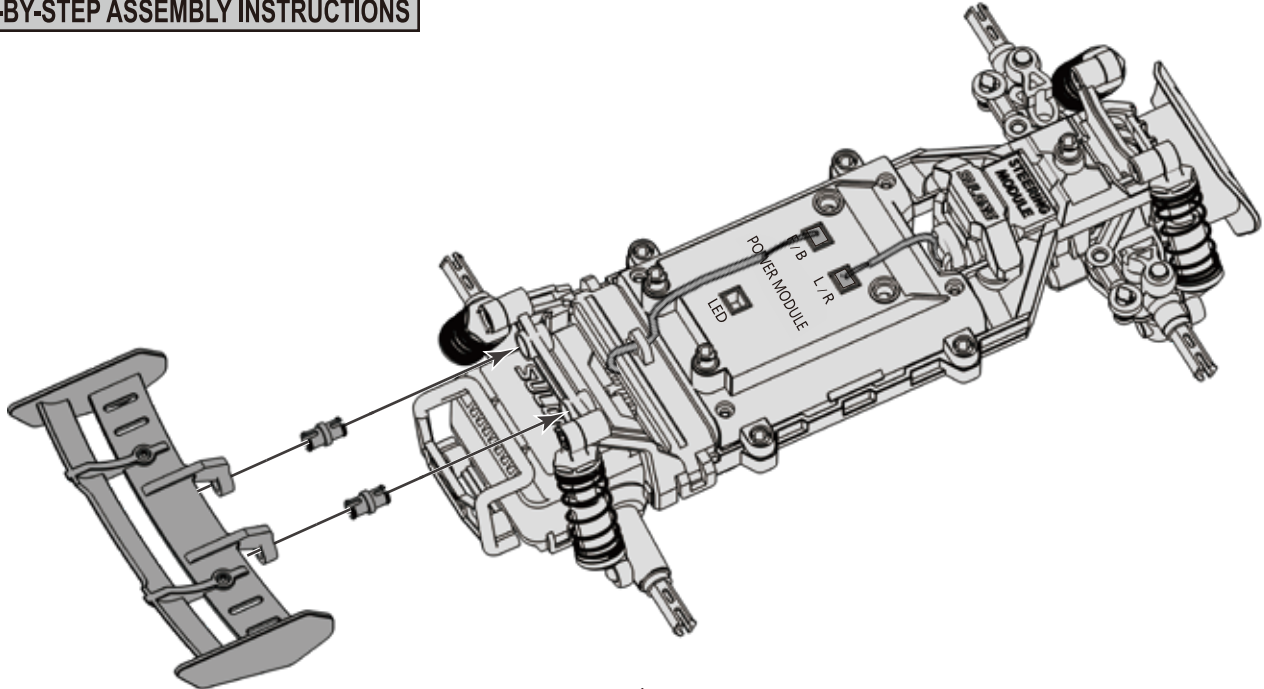

2

## ASSEMBLY-REQUIRED ACCESSORIES



Latch C1 \* 3

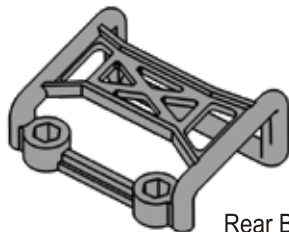

Rear Bumper F2-2 \* 1

## STEP-BY-STEP ASSEMBLY INSTRUCTIONS

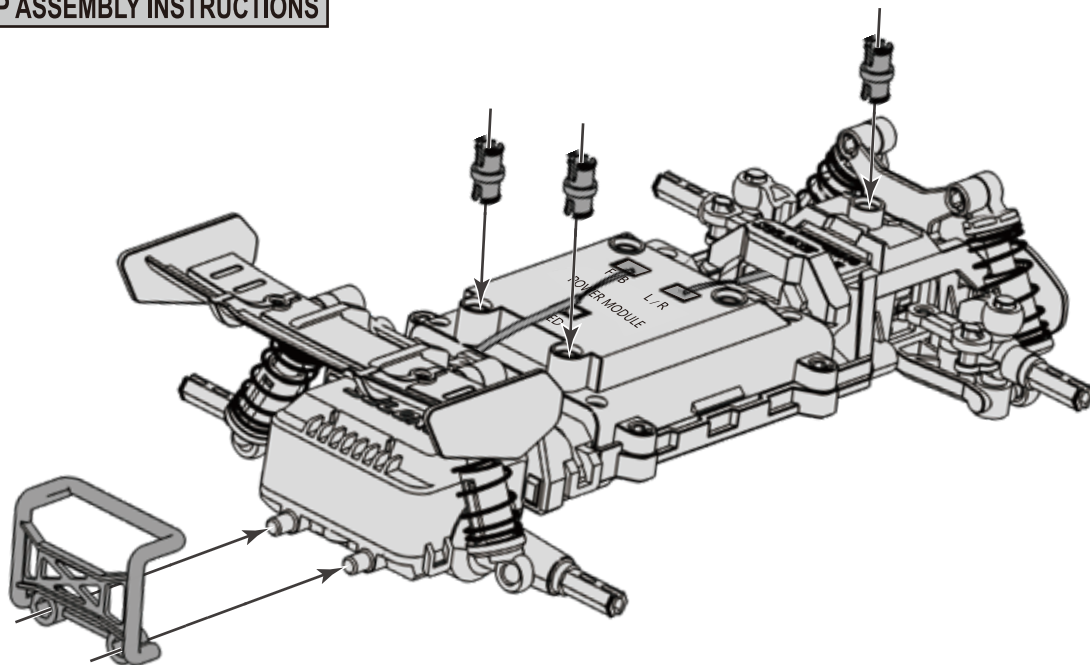

3



## ASSEMBLY-REQUIRED ACCESSORIES



Nut \* 3

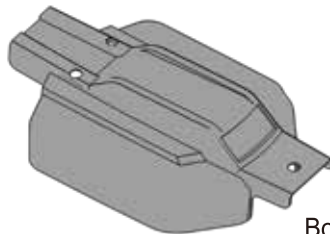

Bodyshell \* 1

## STEP-BY-STEP ASSEMBLY INSTRUCTIONS

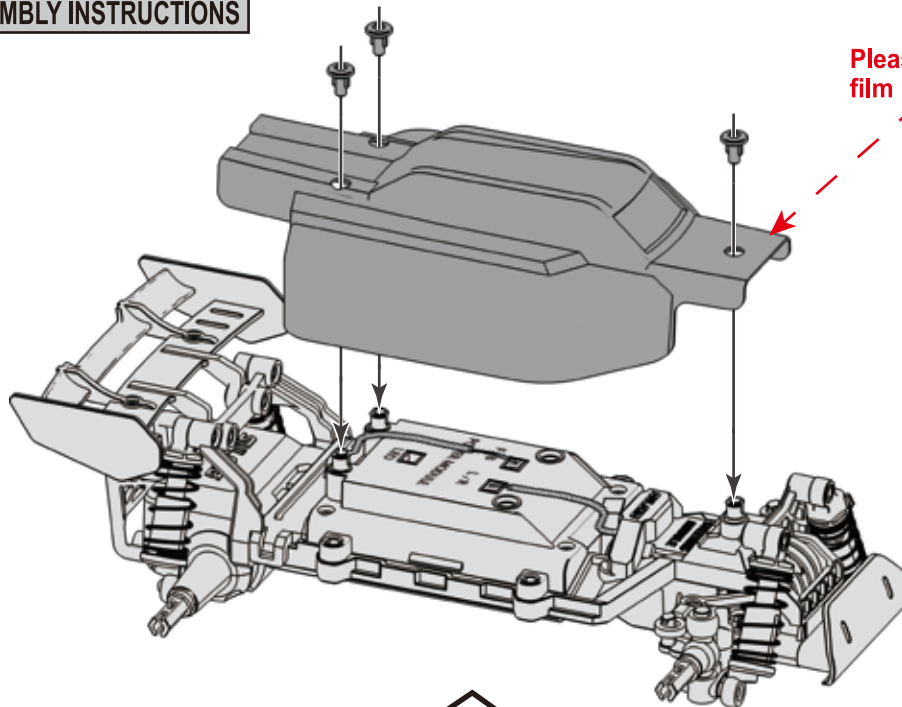

## ASSEMBLY-REQUIRED ACCESSORIES



Wheels \* 4

## STEP-BY-STEP ASSEMBLY INSTRUCTIONS

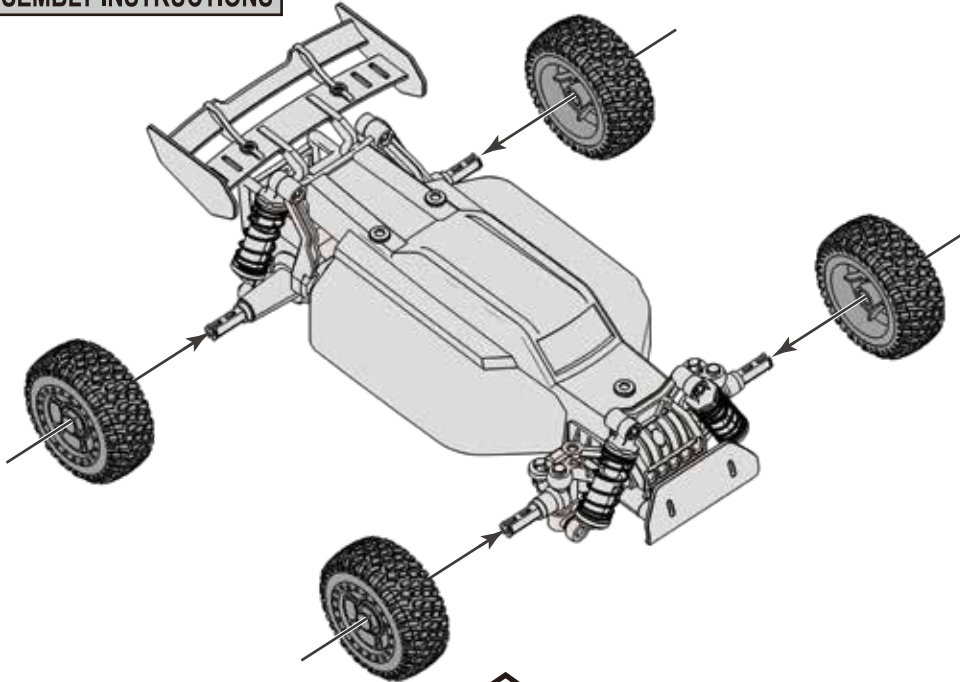

5



# REMOTE CONTROL

## REMOTE CONTROLLER

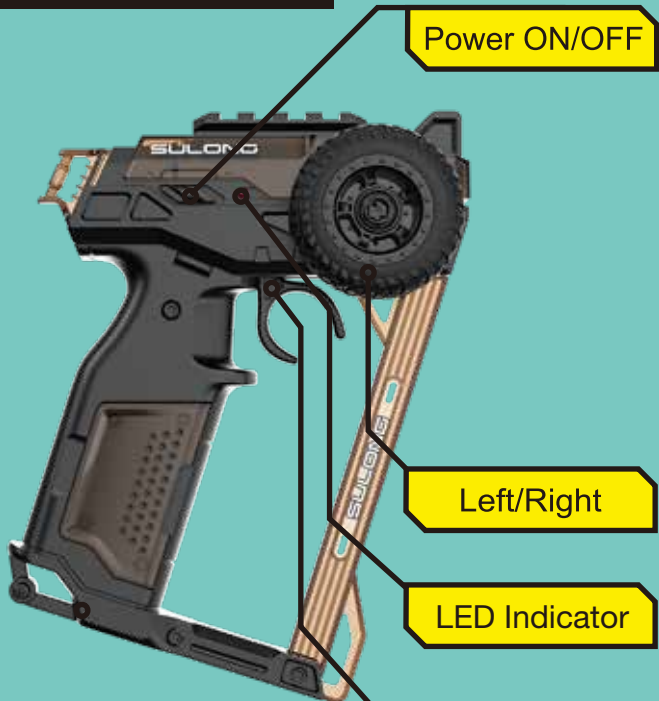

Power ON/OFF

Left/Right

LED Indicator

Forward/Backward

## BATTERY INSTALLATION

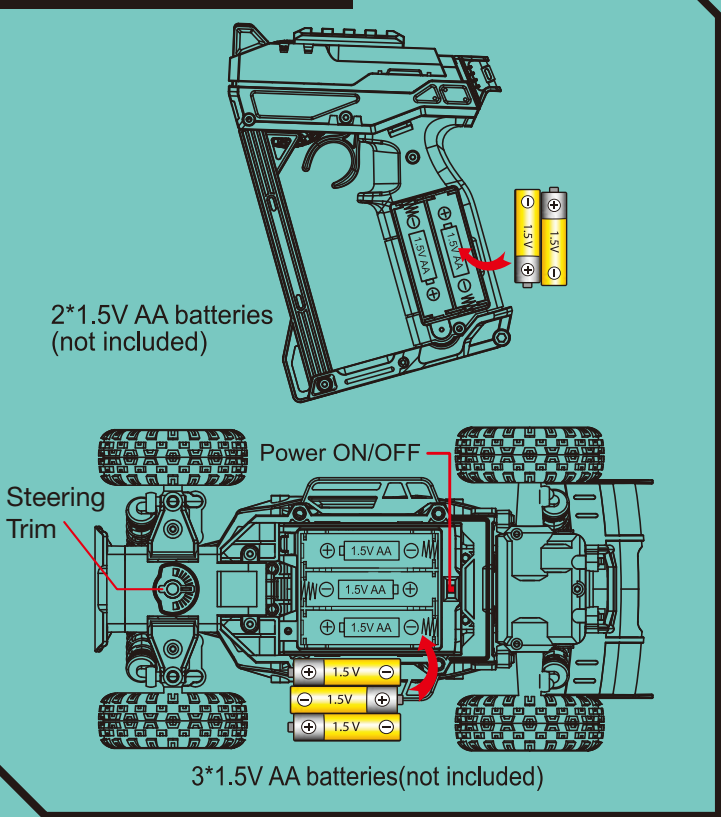

2\*1.5V AA batteries (not included)

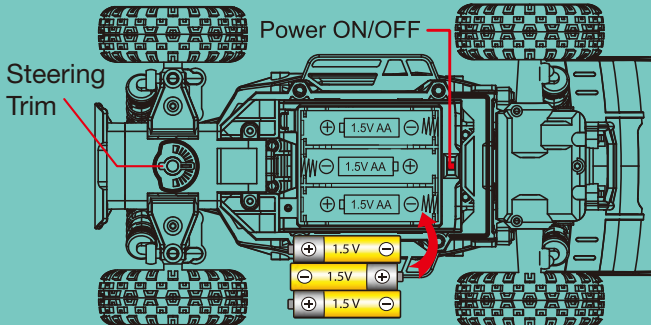

Steering Trim

Power ON/OFF

3\*1.5V AA batteries(not included)

# WARRANTY INFORMATION

Our product is guaranteed to be free from manufacturing defects for a period of 12 Months.

If your product becomes defective during this period, Electus Distribution will repair, replace, or refund where a product is faulty; or not fit for intended purpose.

This warranty will not cover modified product; misuse or abuse of the product contrary to user instructions or packaging label; change of mind and normal wear and tear.

Our goods come with guarantees that cannot be excluded under the Australian Consumer Law. You are entitled to a replacement or refund for a major failure and for compensation for any other reasonably foreseeable loss or damage. You are also entitled to have the goods repaired or replaced if the goods fail to be of acceptable quality and failure does not amount to a major failure.

To claim warranty, please contact the place of purchase. You will need to show receipt or other proof of purchase. Additional information may be required to process your claim.

Any expenses relating to the return of your product to the store will normally have to be paid by you.

The benefits to the customer given by this warranty are in addition to other rights and remedies of the Australian Consumer Law in relation to the goods or services to which this warranty relates.

This warranty is provided by:

Electus Distribution

Address 46 Eastern Creek Drive, Eastern Creek NSW 2766

Ph. 1300 738 555