

R/C STINGRAY

THE ACTUAL OBJECT MAY NOT MATCH THE PICTURE DUE TO CHANGES,
PLEASE REFER TO THE ACTUAL OBJECT!



IMPORTANT CONTENT

PLEASE READ THE USER MANUAL CAREFULLY BEFORE USE, IT IS RECOMMENDED THAT CHILDREN UNDER 8 YEARS OLD USE IT UNDER ADULT SUPERVISION.

FOR INDOOR USE ONLY

● LENGTH:	24cm	● WEIGHT:	82.5g	● RANGE:	3M (INDOOR)
● WIDTH:	14cm	● DIVING DEPTH:	0.5m	● CHANNELS:	3
● HIGH:	3cm	● SPEED:	0.1m/s		

CAUTIONS

1. Contains small parts! Not suitable for children under 8 years old. The stingray contains small parts that are dangerous if swallowed. Please keep it out of reach of children under 3 years old.
2. Only used in indoor cold fish tanks (not suitable for marine fish tanks) or small ponds, the water depth does not exceed 0.5 meters, the length does not exceed 2.5 meters, and the width does not exceed 2.5 meters.
3. This kind of stingray is not suitable for outdoor use.
4. Do not use in salt water, chemical water or polluted water.
5. Do not use it in larger waters, such as oceans, rivers, lakes, canals, swimming pools or water of unknown depth.
6. Please use alkaline batteries.
7. Do not throw it into fire to cause the battery to heat up.
8. Take care of your environment – dispose of used batteries responsibly and recycle them wherever possible.
9. Stingray is only suitable for children aged 8 or above.
10. It is recommended that children under 8 years old use it under adult supervision. Children should be aware of the potential dangers associated with playing near water.
11. Stingray and related components are made of precision electronic parts. Please handle with care and avoid falling, rapid knocking or dismantling.

1. ANTENNA INSTALLATION AND BATTERY INSTALLATION

Insert the antenna into the hole in the center of the remote control. Gently rotate the antenna clockwise until it is tightened. Do not overtighten.

1. Use a Phillips head/Phillips screwdriver to open the battery cover.
2. Install three 1.5V "AA" alkaline batteries into the battery box. Please make sure to insert the batteries with the correct polarity.
3. Close the battery cover and tighten the screws until they are in place.

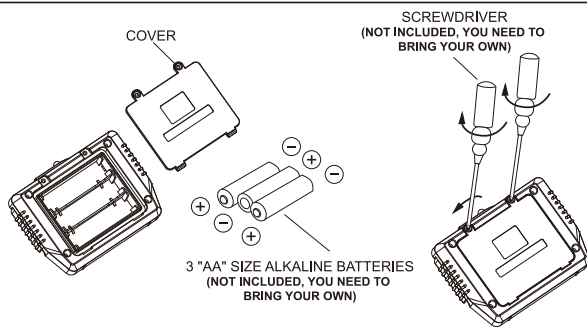

2. HOW TO CHARGE

1. The USB charging power cord has two terminals. Insert the square end into the stingray's outlet switch cap, as the picture shows.
 - The light turns on when charging and turns off when fully charged.
 - A complete charging cycle takes approximately 60 minutes.
2. To ensure charging safety, please use the provided USB charging cable to charge the product.

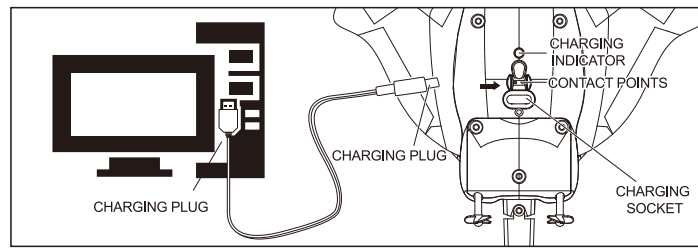

3. PREPARING TO OPERATE THE STINGRAY

1. Stretch the antenna.
2. Gently place the stingray in the water.
3. Important information: Keep the head of the stingray into the water firstly. As shown in the picture, then release the stingray completely in the water to float.
4. Press and hold to operate the remote control stingray.
5. After use, please take the stingray out of the water. Do not leave it in the water for a long time to avoid over discharging of the battery.
6. Important information: away from the water function: as in Figure 1, when the two contact points at the front of the manta ray leave the water, the stingray is in a power-off state, and the stingray propellers stop rotating. (Note: only can operate into the water or use metal connection to conduct two contact points)

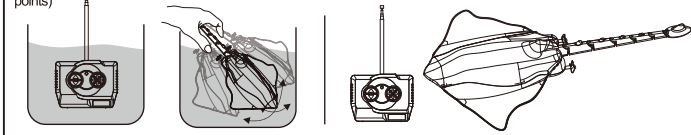

1 COMPLETELY CLOSE THE DRAIN BEFORE THE STINGRAY IS FULLY IN THE WATER

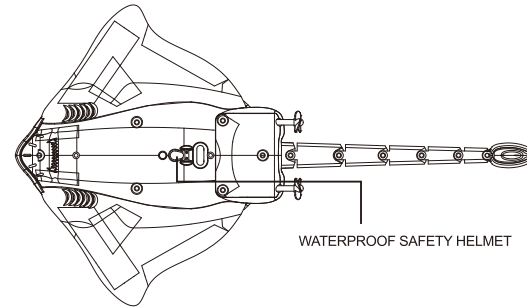

4. COMPLETE FUNCTIONAL OPERATION

1. After the remote control is powered on, put the stingray into the water, press and hold the forward button, and the manta ray will dive forward. When playing underwater, moving forward can make the stingray move underwater, and turning left and right can make it more flexible.
2. In the same operation, press and hold the backward button, and the stingray will slowly move back.
3. Press the automatic demonstration button and the stingray will turn on the automatic demonstration function.
4. If you don't want to automatically demonstrate, you can click the button to turn off automatic demonstration, and the stingray will stop.
5. Press and hold the left turn button, and the stingray will turn left.
6. Press and hold the right turn button, and the stingray will turn right.

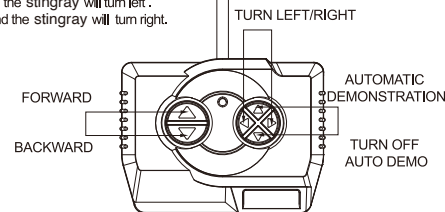

NOTE: WHEN USING THE REMOTE CONTROL,
THE SCREWS MUST BE TIGHTENED.

5. STINGRAY MALFUNCTION

If the stingray is unable to dive, submerge the entire body and shake it a few times to remove excess gas from the bottom of the stingray before the diving can be operated. If the operating time falls below the expected time, for the life of the lithium polymer battery, 5-8 times full charge and discharge cycles are required to restore the stingray's operating time. If does not operate correctly, the stingray may be suffering from external signal interference, try moving to another area and try again. Alternatively, it is possible that the stingray or the remote control does not have enough power. Please replace or recharge the batteries in the remote control or stingray.

6. HOW TO POUR WATER OUT OF STINGRAY

When stingray loses its balance during operation, it means that the stingray is soaking water and you should take it out of the water and pull out the drain plug on bottom of stingray, and then shake the stingray. Note: Keep the drain plug in safe place.

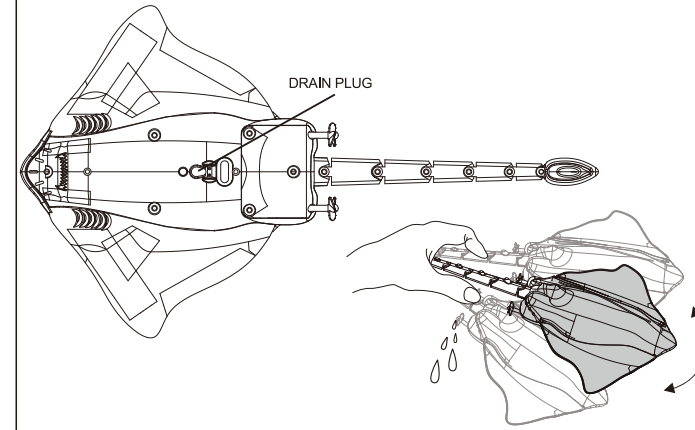

WARNING

- Not designed for salt water use.
- The product itself uses 3.7V rechargeable lithium battery;
- The remote control uses 3*1.5V "AA" batteries (not included);
- Please pay attention to the polarity when installing or replacing batteries;
- Non-rechargeable batteries cannot be recharged;
- Adult supervision is required when charging rechargeable batteries;
- Do not use new, old or different types of batteries;
- Electronic terminals should not be short-circuited.
- When the product slows down, it means the product is low on power.
- Please charge the product according to the above method.
- If the battery of the remote control is low and the power indicator light becomes dim or does not light up, just replace it with a new battery.
- Please look for the charging plug and charging interface when charging.
- If it is not used for a long time, please take out the battery in the remote control and open the waterproof safety cap of the product.
- Under the guidance of an adult when unpacking.
- Keep this information for future reference.

WARRANTY

Our product is guaranteed to be free from manufacturing defects for a period of 12 Months. If your product becomes defective during this period, Electus Distribution will repair, replace, or refund where a product is faulty; or not fit for intended purpose. This warranty will not cover modified product; misuse or abuse of the product contrary to user instructions or packaging label; change of mind and normal wear and tear. Our goods come with guarantees that cannot be excluded under the Australian Consumer Law. You are entitled to a replacement or refund for a major failure and for compensation for any other reasonably foreseeable loss or damage. You are also entitled to have the goods repaired or replaced if the goods fail to be of acceptable quality and failure does not amount to a major failure. To claim warranty, please contact the place of purchase. You will need to show receipt or other proof of purchase. Additional information may be required to process your claim. Any expenses relating to the return of your product to the store will normally have to be paid by you. The benefits to the customer given by this warranty are in addition to other rights and remedies of the Australian Consumer Law in relation to the goods or services to which this warranty relates.

This warranty is provided by: Electus Distribution
Address 46 Eastern Creek Drive, Eastern Creek NSW 2766 Ph. 1300 738 555