

1:43 SCALE R/C SLOT CAR SET



USER MANUAL

GT4350

BOX CONTENTS

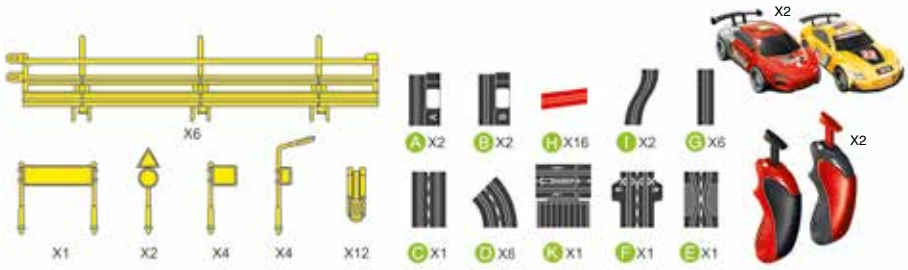

LOOP TRACK ASSEMBLY

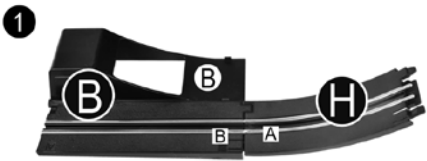

Join B & H tracks together, slide the grooves of A & B together.



Join A & H tracks together, make sure that the tracks are connected together well.

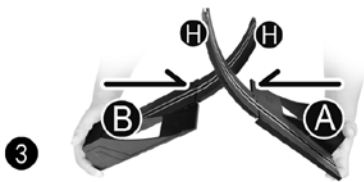

Connect A & B together and push the pieces inward.

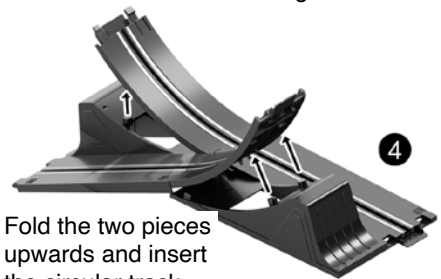

Fold the two pieces upwards and insert the circular track into the groove.



The bottom piece of the loop is now completed.



Join 6 x H tracks together to complete the loop and repeat the steps above to create the second loop.

FITTING ASSEMBLY

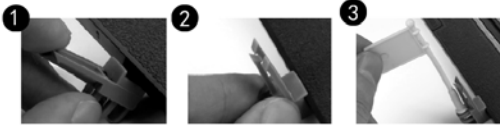

Set the clips to the side of the track and push them inwards until they are locked in place. Insert the flag poles into the holes of the clip.

Race track holder

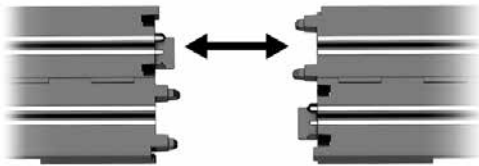

Insert the tracks together on a flat surface.

Guardrail installation

1 Align the guardrail with the groove of the curved tracks and insert vertically.

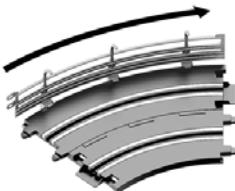
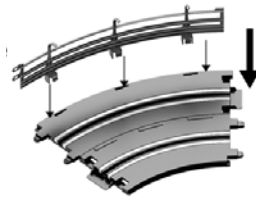

2 Slide the guard rails parallel to the track and lock in place.

CAR ADJUSTMENT

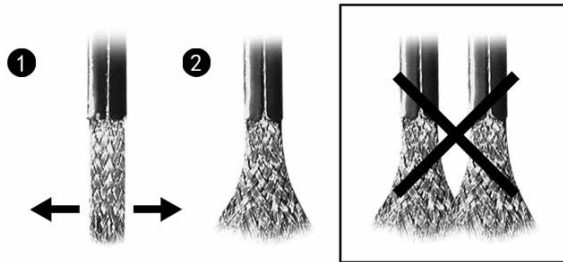

The brush located on the bottom of each car needs to be straight (fig 1.). If the brush has tangled, then stretch it out slightly so that it's completely straight.

Note: The left and right brush of each car should be separated from one another. If the brushes touch each other then the car will not operate correctly.

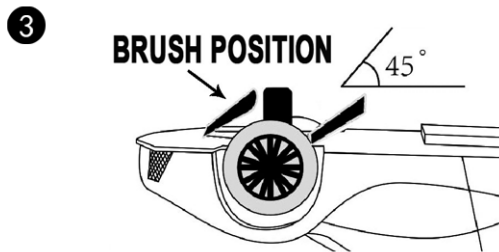

The brushes below each car need to be situated at an angle of 45° to run correctly.

PRE-RACE PREPARATION



When the cars are placed on top of the track, make sure the pillar on the bottom is placed in the groove of the track.



Plug the power handles to the handle sockets on the power box.

BATTERY INSTALLATION

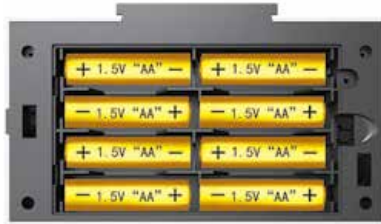

1. Remove the battery cover located on the bottom of the grand stand.
2. Insert 8 x AA (not included) batteries using the correct polarity.
3. Once the batteries have been inserted, place the battery cover back on.

SAFETY & WARNINGS

- It is suggested that only one car at a time should be placed on a single track.
- Wipe the dust off the tracks before each use so that the cars can run properly.
- Keep the slot car set away from high temperatures as it may damage the device.
- Do not expose the slot car set to water or liquids to prevent the unit from damage.

TROUBLESHOOTING

Problem	Solution
Car Has No Power	<ul style="list-style-type: none">• Check that the slot car set has the correct polarity for the batteries and they are not flat.• Ensure the brushes underneath each car is making contact with the track.• Ensure the tracks are all tightly connected together as a break in the tracks will cause the slot car set to not work correctly.• Check to see if the controller matches the correct lane.• Check the connection between to the grand stand and track so that its connected tightly otherwise it may not operate
Car Runs Slowly	<ul style="list-style-type: none">• Ensure the tracks are all tightly connected together as a break in the tracks will cause the slot car set to not work correctly.• Wipe the track to ensure there is no dust or debris on the metal track.
Car Keeps Running Off The Track	<ul style="list-style-type: none">• Ensure the speed of the car is not too fast when going around corners otherwise it will fall off. It is suggested to install the guard rails.• Check the brush on the bottom of each car to see if its higher than an angle of 45°. If it is higher then please adjust lower.

WARRANTY INFORMATION

Our product is guaranteed to be free from manufacturing defects for a period of 12 Months.

If your product becomes defective during this period, Electus Distribution will repair, replace, or refund where a product is faulty; or not fit for intended purpose.

This warranty will not cover modified product; misuse or abuse of the product contrary to user instructions or packaging label; change of mind and normal wear and tear.

Our goods come with guarantees that cannot be excluded under the Australian Consumer Law. You are entitled to a replacement or refund for a major failure and for compensation for any other reasonably foreseeable loss or damage. You are also entitled to have the goods repaired or replaced if the goods fail to be of acceptable quality and failure does not amount to a major failure.

To claim warranty, please contact the place of purchase. You will need to show receipt or other proof of purchase. Additional information may be required to process your claim.

Any expenses relating to the return of your product to the store will normally have to be paid by you.

The benefits to the customer given by this warranty are in addition to other rights and remedies of the Australian Consumer Law in relation to the goods or services to which this warranty relates.

This warranty is provided by:

Electus Distribution

Address 46 Eastern Creek Drive, Eastern Creek NSW 2766

Ph. 1300 738 555