

GT4328

8+

Instruction Manual

Please read this instruction manual
carefully before operation



In order to operate this remote control car more easily, proficiently and safely, please read this instruction manual carefully before operation. The instruction manual contains important information, please properly keep it.

CATALOGUE

1. Introduction of product parameters and remote control ----- 1
2. Installation and function introduction of remote controller battery ----- 2
3. Introduction of installation and charging of remote control vehicle battery ----- 3
4. Related points to note ----- 4

⚠ ATTENTION

Electrical control product

The product is not suitable for children of 8 or below 8

Please pay attention to prevent from electrical shock in using any electronic product.

•Please use under the supervision of the adult.

Warning: Please use the product correctly as the instruction manual.

MAINTENANCE AND CARE

1. If the product is not going to be used for a long period, please take out the battery, so as to avoid liquid leakage or product damage.
2. Please wipe the car with wet cloth slightly.
3. Please do not place the toy in place with high temperature, humidity and direct sunshine.
4. Please do not place the toy in water, because it will probably damage the electronic component.
5. Once the product has been sold out, we will not be responsible for any safety responsibility caused by operation, using or control.
6. In case of any operation, using or maintenance problem, we will authorize the franchisers to provide technical support and after-sales service, and please contact with the local franchisers.

PRODUCT PARAMETERS

Product name: 1:18 four-wheel-drive high-speed vehicle

Remote control battery: 1.5V AA x 4 (not included) Frequency: 2.4Ghz

Vehicle battery: 7.4V, 1200mAh

Charging time: Up to 4 hours

Driving time: around Up to 25mins

Control distance: Up to 80m

INTRODUCTION OF REMOTE CONTROL

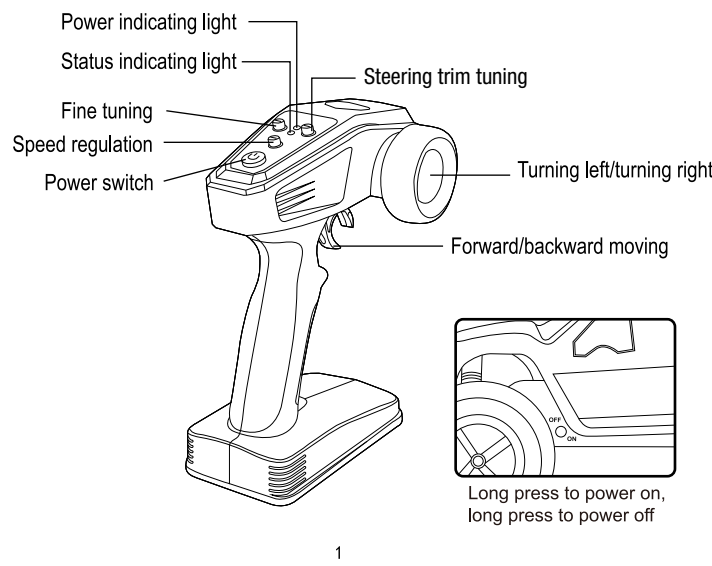

BATTERY INSTALLATION

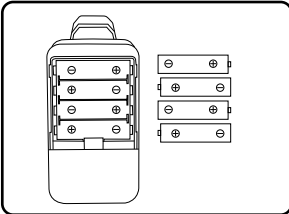

Matters need attention for the battery

- 1) The remote control uses 4 1.5V "AA" non-rechargeable batteries.
- 2) Loading and unloading the battery should correctly operate according to the polarity and voltage marks on the toy battery. The battery should not have any short circuit.
- 3) The non-rechargeable battery can not be charged.
- 4) The batteries of different types or new and old batteries can not be mixed in using.

FUNCTION INTRODUCTION

Introduction of the Operating Rod

1. Accelerator operating rod(the direction operating rod controls the driving route and direction)



2. Direction operating rod(the accelerator operating rod controls the forward, backward, turning left and turning right)

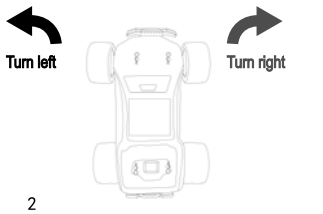

MATTERS NEED ATTENTION IN DRIVING

- When the car moves, please don't touch the four wheels of the remote control vehicle, so as to avoid twist wound or incised wound.
- When the remote control or vehicle has low power, the remote control distance will be affected. In the meanwhile, there will be too low speed or climbing difficulty.
- The remote control vehicle can not fall from altitude or have serious collision, because it might damage the remote controller or shorten the service life of the vehicle.
- Please do not play the vehicle near the roadside, puddle, earth or other dangerous places, so as to avoid danger.

BATTERY INSTALLATION OF THE VEHICLE

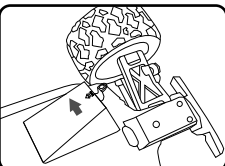

(1) Revolve the screwdriver to open the battery lid;

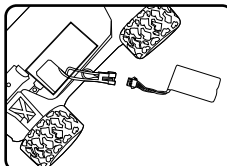

(2) Install the battery in right polarity;

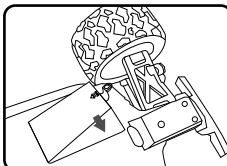

(3) Cover the battery lid and tighten the bolt.

CHARGE THE BATTERY OF THE VEHICLE

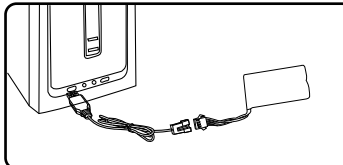

Please firstly take the battery out of the vehicle, and then insert the power plug into the USB charging socket, and then insert the other end of the USB charging line into the charging adapter or computer USB terminal for charging. In charging, the red light on the USB wire is normally on. When it is fully charged, the green light on the USB wire is normally on.

3

CHANGE DRIFT TIRE

- 1-Use the screwdriver to remove the tire to replace the drift tires.
- 2-When replacing the tire, do not lose the small iron axle, the small iron piece and the hexagonal sleeve, otherwise the tire will not rotate properly.

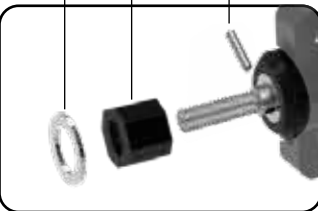
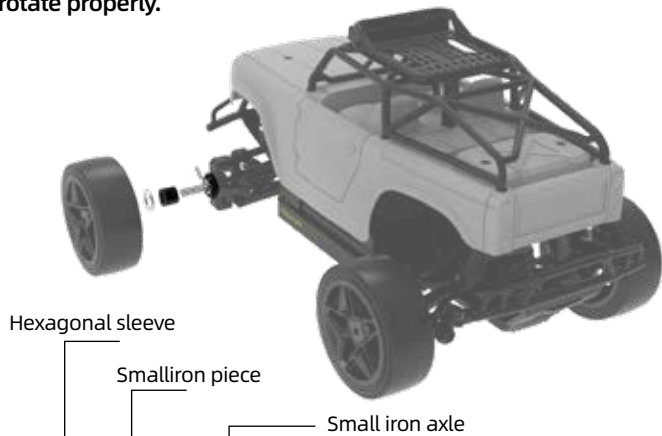

- 3-Please scan the QR code to view the replacement tutorial.



4

MATTERS NEED ATTENTION IN BATTERY USING

1. The product is not suitable for being used by children aged under 8 years old.
2. The product has the power of high-speed revolving, and it is a little dangerous in operating. Please don't approach or touch the product when the product is operating.
3. When using the product, please keep away from the railway, highroad, and other dangerous environments.
4. In using the product, please keep away from the cellphone station, big-power emitting equipment and other environment with high electromagnetic interference.
5. In using the product, please keep away from the bike or car or the like.
6. Please do not use the product in raining, thunderstorm, sandstorm, fog, snow, strong wind, low temperature or other severe environment.
7. The product is in the waterproof design. Please do not operate the product near water domain.
8. Please maintain the product within the eyesight of the operator.
9. Please do not operate the product near the site with children playing.
10. Please do not use the product chase after any transportation tool or affect the normal operation of the transportation tool.
11. The product can not be used after drinking, tiredness, taking medicine or having poor physical condition.
12. Please inspect the product before each operation, including but not limited to the firmness of the component, crack or wearing of the body and tire, battery power amount, effectiveness of the indicating light and so on. In case of any abnormality, please immediately stop using and replace the corresponding components.
13. The remote control vehicle with abnormal working status will probably have accident. Please do not operate by force.
14. Please do not hinder any moving part.
15. Please not refit the product, or use the product for any not originally designed application.
16. Please operate as the instruction manual.
17. Please use the component of the original plant for maintenance and replacement.
18. It is not allowed to mix the batteries of different categories in using.
19. Please do not use the expanded, leaked or damaged battery.
20. In charging the battery, please do not approach any flammable product(such as blanket, wooden furniture and wooden plate and so on.)
21. Please use the charging line configured by the original plant. The charging line of other brand or the damaged charging line can not be used.
22. The model should not be placed near your ear, because improper operation will damage your hearing.
23. Please do not squeeze the battery or enable it to have short circuit, so as to avoid explosion.
24. The motor is the heating part, please do not contact, so as to avoid scalding

WARRANTY INFORMATION

Our product is guaranteed to be free from manufacturing defects for a period of 12 Months. If your product becomes defective during this period, Electus Distribution will repair, replace, or refund where a product is faulty; or not fit for intended purpose. This warranty will not cover modified product; misuse or abuse of the product contrary to user instructions or packaging label; change of mind and normal wear and tear. Our goods come with guarantees that cannot be excluded under the Australian Consumer Law. You are entitled to a replacement or refund for a major failure and for compensation for any other reasonably foreseeable loss or damage. You are also entitled to have the goods repaired or replaced if the goods fail to be of acceptable quality and failure does not amount to a major failure. To claim warranty, please contact the place of purchase. You will need to show receipt or other proof of purchase. Additional information may be required to process your claim. Any expenses relating to the return of your product to the store will normally have to be paid by you. The benefits to the customer given by this warranty are in addition to other rights and remedies of the Australian Consumer Law in relation to the goods or services to which this warranty relates.

This warranty is provided by:
Electus Distribution
Address 46 Eastern Creek Drive, Eastern Creek NSW 2766
Ph. 1300 738 555