

HANDHELD GAME CONSOLE

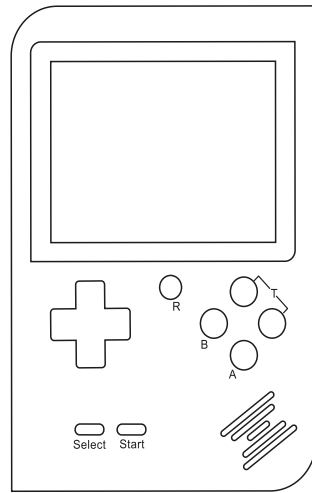

USER MANUAL GT4280

Box Contents

- 1 x Handheld Game Console
- 1 x Rechargeable Lithium Battery
- 1 x 3.5mm to RCA TV Cable
- 1 x USB Charging Cable

Product Diagram

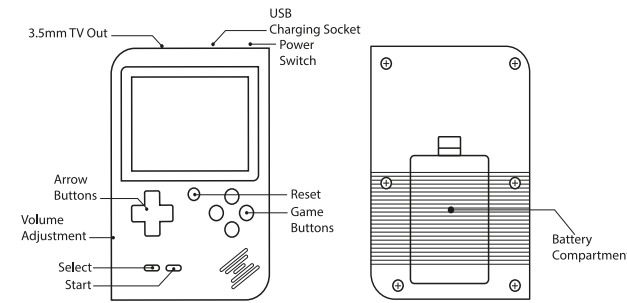

Operation

1. Press the power switch located at the top of the unit to on.
2. You will not see the list of 256 games display. Press the up and down arrow to cycle through the games or press the right or left arrow to turn to the next or previous page of games.
3. Press the A button to select a game you want to play.
4. Depending on the game you're playing, press the start button to proceed to the game.
5. You can now use the arrow and game buttons to start playing the game.

6. Press the start button to pause the game, press it again to unpause.

7. Press the reset button to reset back to the main screen to select another game.

8. The volume can be adjusted by the adjustment dial on the left hand side of the unit.

Charging

1. Plug the USB mini B cable into the USB charging socket located on the top of the unit.

2. Plug the oppsite end of the USB cable to a USB mains power adaptor or USB port on a computer to start charging.

3. The charging will be completed after 2 hours.

TV Out

1. Connect the 3.5mm RCA cable to the 3.5mm socket located on the top of the unit.

2. Connect the opposite end to the yellow and red RCA sockets on the back of your TV.

3. It will now start displaying on your TV.

Troubleshooting

Problem: Sound or video is distorted.
Answer: The battery is running low; start charging the game console

Problem: The game console won't start.
Answer: The battery is too low; start charging the game console.

Safety

1. Do not open the case of the game console to avoid damage and injury.

2. Keep the game console away from high temperatures as it may cause damage to the battery.

3. Do not expose the game console to water, moisture or liquids to prevent the unit from damage.

Specifications

LCD: 2.8"

Play Time: 3-4 Hours

Charge Time: Up to 2 Hours

Battery: 3.7V Li-ion, 800mAh (BL-5C)

Power: 5VDC, 500mA (Mini B USB)

Dimensions: 116(H) x 79(W) x 22(D)mm

Warranty Information

Our product is guaranteed to be free from manufacturing defects for a period of 12 Months.

If your product becomes defective during this period, Electus Distribution will repair, replace, or refund where a product is faulty; or not fit for intended purpose.

This warranty will not cover modified product; misuse or abuse of the product contrary to user instructions or packaging label; change of mind and normal wear and tear.

Our goods come with guarantees that cannot be excluded under the Australian Consumer Law. You are entitled to a replacement or refund for a major failure and for compensation for any other reasonably foreseeable loss or damage. You are also entitled to have the goods repaired or replaced if the goods fail to be of acceptable quality and failure does not amount to a major failure.

To claim warranty, please contact the place of purchase. You will need to show receipt or other proof of purchase. Additional information may be required to process your claim.

Any expenses relating to the return of your product to the store will normally have to be paid by you.

The benefits to the customer given by this warranty are in addition to other rights and remedies of the Australian Consumer Law in relation to the goods or services to which this warranty relates.

This warranty is provided by: Electus Distribution
Address 46 Eastern Creek Drive, Eastern Creek NSW 2766
Ph. 1300 738 555