

R/C 3-in-1 Plane Manual

PLEASE READ CAREFULLY BEFORE FLYING

1. Packaging and instructions contain important information and should be retained.
2. The pictures in the packaging and instructions are not exactly the same as the product of the product. Please refer to the real object.

List of products

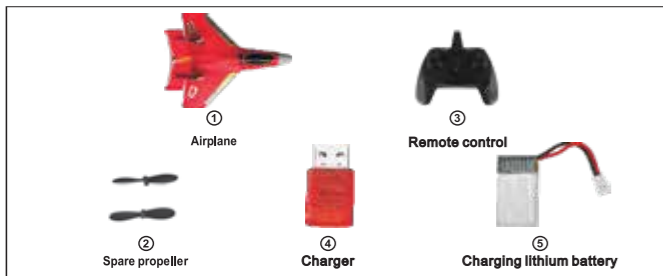

Remote control



1. Power switch
2. Power light
3. Throttle Control Lever
4. Direction Control Lever
5. Left fine-tuning button: long press and hold, every tick left fine-tuning a grid, press once to release the switch light.
6. Right fine adjustment button: long press and hold, and fine tune to the right with every tick.

Note: The remote control must be fitted with sections 1.5V "AA" dry batteries (The product is not subject to purchase)

-1-

HINT

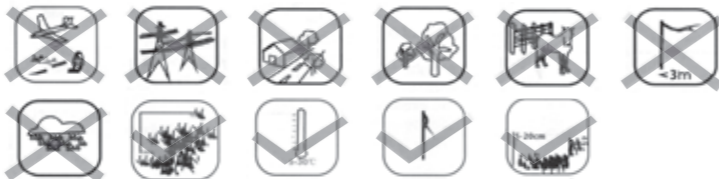

Thank you for purchasing. This product is designed for beginners. You can enjoy the flying infinite charm by using our product, even if you have no experience before.

For your safety and better control, please read the manual carefully before using. Thank you!

Note: For better control, first flight should be done in a large open area in calm condition.

1. Never use the model near parking areas when there are cars.
2. Do not play in thunder day.
3. Do not use the model near highway, high-voltage, airport, buildings, trees, lakes and rivers.
4. Keep distance from propellers when they are working, in case of turning injuries.
5. Do not try to catch the model while flying, or it might cause to injuries.
6. Children under age of 14 should not use the model without adult's accompany.

Tips:

1. We suggest you flying the model at the temperature about 15-30°C. In sunny days, you'd better wear sun glasses for protect your eyes (to prevent sand blow into eyes or sunlight hurting).
2. Flight is an exciting sport, it will depletes your energy at the same time bring you happiness. So we suggest you carrying water and food when out for.

CHARGING INSTRUCTIONS

Before using the product, you need to fully charge the rechargeable battery and use it slowly.

BATTERY RECHARGING

- 1) Connect the charging pin of the battery with the USB, and plug the USB to the USB hub of the power supply. The red indicator on the USB will light on, it shows the battery is being charged.
- 2) It takes about 40 minutes to charge. When the indicator on the USB lights off, it shows the charging is complete.
- 3) If the indicator on the USB keep flashing, it shows the USB or the battery is damaged, please replace them immediately.

-2-

DECODING

Before you want to control the aircraft, you need to first carry out signal frequency matching between the remote control and the aircraft.

SIGNAL SYNCHRONIZATION FOR 2.4GHZ

- 1) Install the remote control into 4 No.5 dry batteries correctly, and pay attention to the orientation of positive and negative poles to avoid power failure. Connect the original rechargeable battery to the aircraft battery compartment after it is fully charged. When connecting, pay attention to the red and black wires of the battery corresponding to the red and black wires in the battery compartment. Otherwise, the control panel will be damaged by a short circuit!
- 2) Open the remote control switch, the power indicator will flash, indicating that the remote control is frequent in the search signal;
- 3) Push the left throttle push rod to the top and then pull it back to the bottom. When both the indicators on the airplane and the controller stop flashing and keep light on, it shows the synchronization is successful. You are now able to control the airplane

HAND THROWING TAKING-OFF

Key points: please observe before flight and confirm the wind.

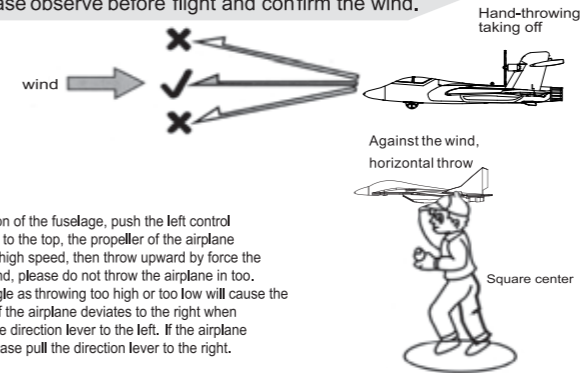

Hold the central position of the fuselage, push the left control lever of the transmitter to the top, the propeller of the airplane will be rotating in very high speed, then throw upward by force the airplane against the wind, please do not throw the airplane in too high or too lower angle as throwing too high or too low will cause the difficulty in taking off. If the airplane deviates to the right when taking off, please pull the direction lever to the left. If the airplane deviates to the left, please pull the direction lever to the right.

-3-

TAKE OFF FROM THE GROUND

Place the airplane on the level ground, push the throttle lever of the transmitter to the top and keep still. The airplane will take off after gliding in a straight for 10 meters. If the airplane won't fly in a straight line or deviate to the right, please pull the direction lever to the left. If the airplane deviates to the left, please pull the direction lever to the right

When the plane flies off the ground, the throttle push rod of the remote control needs to fall back to the middle and lower parts to avoid the crash due to excessive flight power (too high head up).

USE THE FINE ADJUSTMENT FUNCTION TO CORRECT THE DIRECTION

If the aircraft is not controlled to turn, the flight angle always deviates to one side. Then you need to use the left and right fine-tuning buttons in the upper left and right corners of the remote control to correct. If it is biased to the left (right) side, you need to press the right (left) fine-tuning button for 3-5 times and then release it, which can be basically corrected.

FLYING

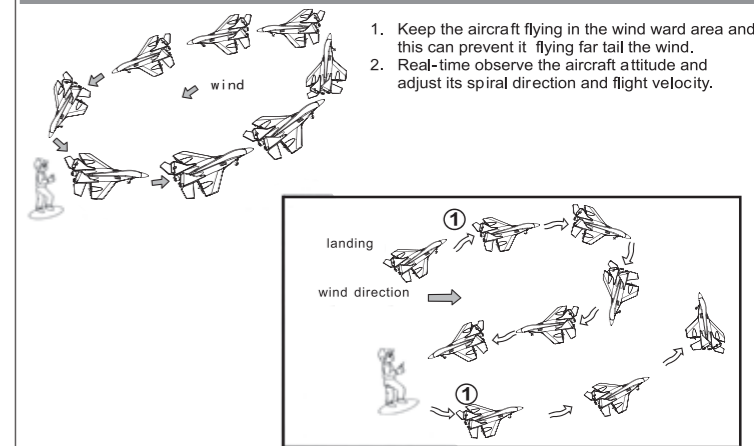

1. Keep the aircraft flying in the wind ward area and this can prevent it flying far tail the wind.
2. Real-time observe the aircraft attitude and adjust its spiral direction and flight velocity.

-4-

During the process of flying, if you have pushed the throttle lever to the top, however, the airplane still has difficulty in climbing up. That represents insufficient power with the battery. This time, please be ready for landing immediately. First of all, control the airplane to fly to the anti-wind area and keep about 30 meters away from yourself, then control the airplane to an appropriate height while release the throttle control lever. When the airplane flies to an appropriate height, you can control the airplane nose to face the operator, then keep the airplane fly in a straight with airplane nose facing to your own anti-wind position and make landing. If you have enough experience, you can control the control lever by Release-Push and Push-Release alternatively and pull or push the direction key in reversing direction to keep the airplane make landing slowly until landing stably and safely.

DIRECTION OF FLYING EXPERIENCE

Few people can operate it well in the first time flying this model. The main reason is that they do not have a better understanding of the spatial concept about which position the flying model lies in 3D space. First of all, please make clear firstly the function of each part of the transmitter and its corresponding flying gesture, especially the directional issue of the flying model. When the tail of the airplane is pointing to yourself, please pull the direction lever to the left and the airplane nose will turn to the left. When you pull the direction lever to the right, the nose of the airplane will turn right. If the nose of the airplane points to yourself, then the pulling direction of the direction lever will be contrary with the turning direction of the nose of the airplane.

The acceleration or deceleration of the throttle lever on the transmitter should be made according to the flying gesture of the airplane. During the process of flying, if the nose of the airplane rises up too much, please decelerate; if the nose of the airplane is turning downward, please accelerate. Keep operating the airplane in this way, you can keep stable flying. If the airplane needs to climb up, please accelerate first. When the airplane rises up, please release the acceleration, then keep level flying state. If the airplane needs to make descending, please release the acceleration and then the airplane will be landing. When the airplane descends to the right height you want, please accelerate and keep the airplane in level flying state.

During the course of flying, the steering of the airplane is finished by the direction lever on the right. If you need to turn left, please pull the direction lever to the left. If you need to turn right, please pull the direction lever to the right. If you want the steering of the airplane smarter, please combine operating both the throttle lever and direction lever. Accelerate while pulling the direction lever (the better mix using both the two control levers in touching way).

-5-

water control instructions:

This product has a waterproof function and can control playing on the water with confidence. Water surface control mainly refers to: The aircraft landed on the water, slid on the water.

1. The aircraft landed on the water surface: control the remote control to adjust the aircraft flight to the air to the state of the preparation of landing, so that it is in a stable glide state in the small accelerator, and then adjust the direction to make its natural taxi land to the water surface superior.
2. The aircraft slides on the surface: When the plane floats on the front on the surface, push the remote control throttle push pole. The aircraft can slide forward on the water. At the same time, control the direction of the push pole to adjust the direction of the gliding, at this time the aircraft can shuttle freely like a yacht.

Note: If you want to take out the planes that have been played on the water, you need to use the water on the body as much as possible. This is because the water on the aircraft will significantly increase the weight of the aircraft, resulting in the difficulty of flying normally. If the aircraft is stopped for a long time, it is necessary to remove the water on the surface and cabin as much as possible, not will affect the service life.

NOTES

If the fuselage is damaged, please use the special-purpose glue or transparent tape to repair it.

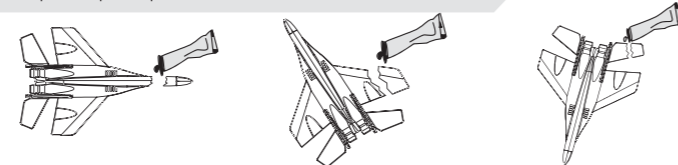

-6-

TROUBLESHOOTING

Break down	Reason	Expel
The airplane can not take off normally	1. Battery is exhausted 2. Incorrect hand-throwing angle 3. The airplane can not fly in a straight line when gliding.	1. Charge the battery 2. Throw the plane against the wind and horizontally. 3. Trim it and use the direction lever to make the airplane glide in a straight
The airplane loses the balance and falls off suddenly during flying	1. Push the throttle lever to the maximum position 2. Keep pulling the direction lever to one direction 3. The pulling direction of the direction lever should be consistent with the deviating direction of the airplane	1. Accelerate or decelerate according to the flying gesture 2. Pull the direction lever by touching way 3. The pulling direction of the direction lever should be contrary with the deviating direction of the airplane
The airplane makes abrupt left or right turning after taking off.	1. The tail vertical wing deviates to the left (right) 2. The rotating speed of the left engine is inconsistent with the right engine	1. Trim the tail wing to the right or to the left 2. Trim the left trimmer or right trimmer, replace the engine
The airplane climbs up too slowly	1. Insufficient power with the battery 2. Overheat with the airplane engine	1. Charge the battery 2. Let the engine cool down before flying
Switch on the power, the propeller will make auto rotation.	1. Load the battery upside down 2. The component of the circuit board is damaged 3. Water seeps into the airplane	1. The red and black lines of the battery are inserted corresponding to the red and black lines in the battery bin 2. Replace the circuit board or replace with new component 3. Dry the circuit board

-7-

Notice

1. This product must be used under adult directly monitoring.
2. This model aircraft is non -toys, which is limited to children over 14 years old.
3. Do not swallow a small parts in this product to avoid suffocation.
4. Keep a safe distance with the high -speed rotating propeller to avoid risk of twisted injury.
5. The motor is a thermal part. Do not touch it to avoid burns.
6. In order to ensure the requirements of the electromagnetic environment of the aviation wireless radio station, it is forbidden to run at the airport. The center of the road is the center of the round, and the remote control of various models is used in areas with a radius of 5000 meters.
7. During the period, during the period, and in the region, in the region, in the region of the relevant state departments To stop using the model remote control.
8. Laser radiation, do not look directly at the beam.
9. Packaging or instructions contain important information and should be retained.

Warranty Information

Our product is guaranteed to be free from manufacturing defects for a period of 12 Months.

If your product becomes defective during this period, Electus Distribution will repair, replace, or refund where a product is faulty; or not fit for intended purpose.

This warranty will not cover modified product; misuse or abuse of the product contrary to user instructions or packaging label; change of mind and normal wear and tear.

Our goods come with guarantees that cannot be excluded under the Australian Consumer Law. You are entitled to a replacement or refund for a major failure and for compensation for any other reasonably foreseeable loss or damage. You are also entitled to have the goods repaired or replaced if the goods fail to be of acceptable quality and failure does not amount to a major failure.

To claim warranty, please contact the place of purchase. You will need to show receipt or other proof of purchase. Additional information may be required to process your claim.

Any expenses relating to the return of your product to the store will normally have to be paid by you.

The benefits to the customer given by this warranty are in addition to other rights and remedies of the Australian Consumer Law in relation to the goods or services to which this warranty relates.

This warranty is provided by: Electus Distribution
Address 46 Eastern Creek Drive, Eastern Creek NSW 2766
Ph. 1300 738 555



-8-