

# R/C Mini Chameleon Drone

AGES 14+  
GT4119



## USER MANUAL

### Trim Adjustment:

When you lift your Drone into the air, without the use of any control levers, it should HOVER in one spot. If it doesn't, you can follow the instructions below to bring your Drone back to a perfect HOVER.

	If your Drone banks to the Left, keep pressing the Bank Right Trim Button to the Right till the Drone stops banking.	
	If your Drone banks to the Right, keep pressing the Bank Left Trim Button to the Left till the Drone stops banking.	
	If your Drone flies Backwards, keep pressing the Forward Trim Button Up till the Drone stops flying Backwards.	
	If your Drone flies Forwards, keep pressing the Backwards Trim Button Down till the Drone stops flying Forwards.	

### Safety:

- This product is suitable for users that have prior operating experience or users no less than the age 14.
- If you encounter any problems while operating or repairing this product, kindly contact us. You can find our contact information in the warranty section. We will provide you with the technical support and after-sale service.
- This drone is recommended to fly indoors.

### Warnings:

- The toy shall be used with caution since skill is required in order to control the flight and avoid collisions with the user, objects or third parties
- Do not touch the rotating rotor, avoid loose clothing or hair that could be caught in the rotor, do not fly near the face
- Item must play or used under adult supervision. Adult must teach children how to safely fly and control the toy
- Please use the product outside; Use in open areas free of obstacles and people; Maximum operating distance is 30 meters; Keep the product within your visual range
- It is recommended to keep the instruction manual
- The rechargeable batteries should be removed from the toy before being charged
- The rechargeable batteries should be removed under adult supervision
- Different types of batteries or new and used batteries are not to be mixed.
- Batteries are to be inserted with the correct polarity (+ and -)
- Exhausted batteries are to be removed from the toy.
- The supply terminals are not to be short-circuited.

### Battery Safety:

- Battery should be put in the dry or well ventilated area with a room temperature of about 18-25 C.
- In order to prolong the battery life, please avoid repeatedly charging or excessive discharging.
- If the battery needs to be stored away for while, please charge the battery first. The battery needs to be charged to at least 50-60% of its capacity.
- If you do not use it for more than a month, it is highly recommended that you need to check the battery voltage every month to make sure the voltage is no less than 3V. Otherwise please do not follow step NO. (3).

### Remote Control Diagram:

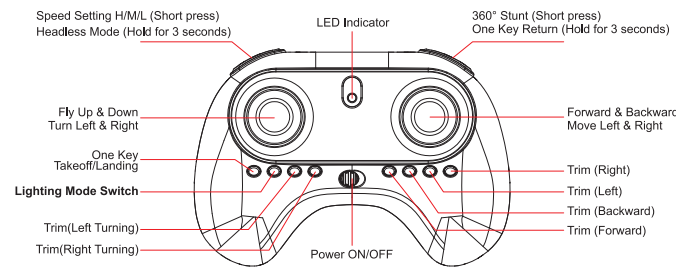

### Battery installation

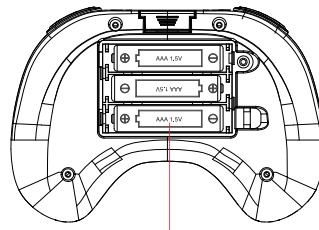

- Different types of batteries or new and used batteries cannot be mixed.
- Batteries must be inserted with the correct polarity.
- Exhausted batteries need to be removed from the toy.
- The supply terminals cannot be short-circuited.
- Open the battery cover with the screwdriver.

### Battery Installation & Charging:

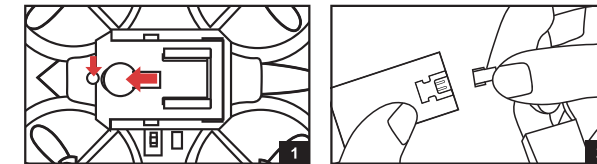

1. Press and hold the battery door button and pull out the door. Then take out the battery.

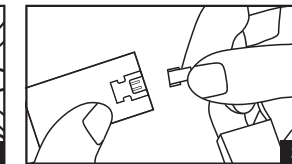

2. Take out the USB charging cable and insert into the battery power port (Make sure the ports are connected correctly).

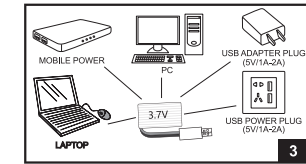

3. Connect the battery to the USB charging cable, then connect the USB plug to USB port of a computer / laptop / mobile power / adaptor. While charging, the LED will light up; when fully charged, the LED will turn off.

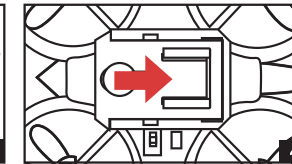

4. Reconnect the battery to the quadcopter.

**Play Time: Up to 5 Minutes**  
**Charging Time: Up to 90 Minutes**

Note: It is recommended to remove the USB cable from the charger when the battery has finished charging.

### Charging Safety:

- When charging, please put this product in a dry or well ventilated area. Keep it away from any heat sources or explosive products.
- Before charging, remove the batteries from the quadcopter. Charging process should be supervised by an adult to prevent an accident.
- After flying, please do not charge the battery if the surface temperature is still not cool. Otherwise it may cause the battery to swell, this could be a fire hazard.
- Please make sure that you use the original USB charging cable provided. If the battery has been used for a long time, or appears to be swollen, please replace them.
- If you do not play with the quadcopter for a long time, please remove the battery.

### Operation:

**Step 1**

Slide open the battery cover on the drone. Insert the battery, connect the battery cable into the drone point. Make sure it fits correctly, then slide the battery cover to close. Turn the switch on the drone to ON, and place it facing onto a flat surface making sure the drone is facing AWAY from you.

**Step 2**

Make sure the drone is switched on, turn on the controller power switch, and you will hear beeping sounds. Then push the left stick to the top and pull it down to bottom (as photo 1&2), the drone will automatically connect with the controller. All the LEDs will flash and stay on. Now it is ready to fly. Click the One Key Takeoff button (as photo 3) to start your flight!

### Flight Controls:

Ascending: When you push Up on the Up/Down Lever the Drone will lift (please do this slowly at first till you learn the sensitivity). When you push Down on the Up/Down Lever the Drone will descend.

Descending: When you push Down on the Up/Down Lever the Drone will descend.

Forward: When you push Forward on the Forward/Backward Lever the Drone will fly Forward (please do this slowly at first till you learn the sensitivity). When you push Backwards on the Forward/Backward Lever the Drone will fly Backwards.

Backward: When you push Backwards on the Forward/Backward Lever the Drone will fly Backwards.

Turn Right: When you push Left on the Turn Left/Right Lever the Drone will spin Left. When you push Right on the Turn Left/Right Lever the Drone will spin Right.

Turn Left: When you push Left on the Turn Left/Right Lever the Drone will spin Left. When you push Right on the Turn Left/Right Lever the Drone will spin Right.

Left sideward fly: When you push Left on the Bank Left/Bank Right Lever the Drone will start to Bank Left.

Right sideward fly: When you push Right on the Bank Left/Bank Right Lever the Drone will start to Bank Right.

### Speed Settings:

The first time you turn on the drone, the initial speed is set to 40%. You will hear ONE beep. When you press the SPEED BUTTON, you will hear TWO beeps which will increase the speed level to 60%. Pressing the SPEED BUTTON again you will hear THREE beeps and this will increase the level to 100%. Pressing again will bring you back to 40% speed and you will hear ONE beep. Always learn to fly at 40% speed, and then you can increase it as you get better at flying.

### Landing:

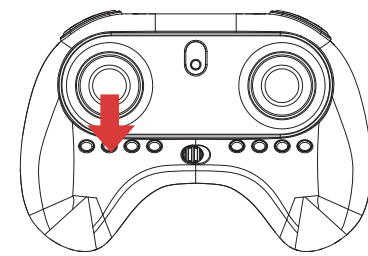

Option 1: After playing, control the drone to the ground and keep the throttle at the lowest position for 3-4 seconds or until the motor stops working. Finally switch off the transmitter and drone.

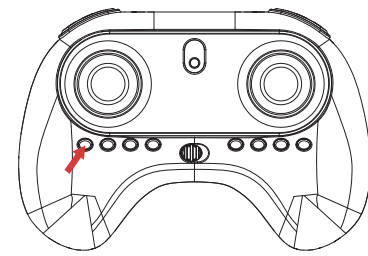

Option 2: For a fast turn off, press the one key landing button, the product will slowly land on the ground and motor will shut down.

### Resetting the Drone:

Pull the left stick to lower left quarter, and pull the right stick to lower right quarter (as photo), you will hear beeping sound and the LED lights begin to flash and stay on, the gyro will auto reset and keep better balance. Please notice that the drone should be put on the flat surface.

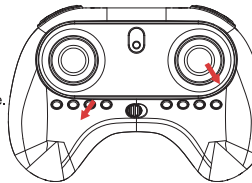

### 360° Flip:

- Make sure the Drone is flying at least 1.5 meters above the floor, or 1.5 meters below a ceiling.
- Press the Flip button on the controller. The controller will make a "Beep" sound, then flick the right hand lever in any direction, the Drone will flip in that direction.
- You may need to push Up on the Up/Down Lever after the flip, if your battery is low on power to keep the Drone high in the air after the Flip.

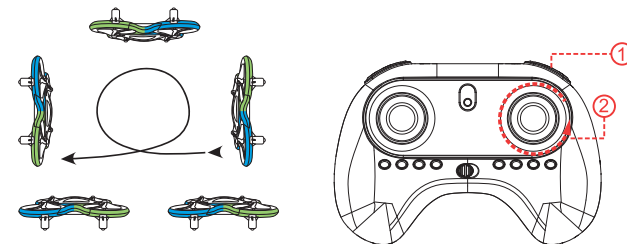

### Headless Mode:

**FRONT**

LEFT RIGHT

BACK

Headless Mode (Hold for 3 seconds)

Please notice that: Once signal connection is finished, the direction of THE DRONE (BUT NOT THE PLAYER) will be marked. In this case (same direction), enter headless mode. Push the control stick forward, it will fly towards the direction which is marked FRONT when signal connection. Push the control stick back / left / right to fly back / left / right.

**BACK**

RIGHT LEFT

FRONT

Headless Mode (Hold for 3 seconds)

Please notice that: Once signal connection is finished, the direction of THE DRONE (BUT NOT THE PLAYER) will be marked. In this case (opposite direction), enter headless mode. Push the control stick forward, it will fly towards the direction which is marked FRONT when signal connection. NOW THE FRONT IS THE OPPOSITE DIRECTION OF THE PLAYER. Push the control stick back / left / right to fly forward / right / left; NOW THE DIRECTIONS ARE ALSO OPPOSITE TO THE PLAYER'S.

### One Key Return:

**FRONT**

LEFT RIGHT

BACK

One Key Return (Hold for 3 seconds)

Situation 1. Please notice that: Once signal connection is finished, the direction of THE DRONE (BUT NOT THE PLAYER) will be marked. In this case (same direction), press the auto-back fly button for 3 seconds it will fly CLOSE TO YOU automatically.

**BACK**

RIGHT LEFT

FRONT

One Key Return (Hold for 3 seconds)

Situation 2. Please notice that: Once signal connection is finished, the direction of THE DRONE (BUT NOT THE PLAYER) will be marked. In this case (opposite direction), press the auto-back fly button for 3 seconds it will fly AWAY FROM YOU automatically.

### Blade Installation:

The quadcopter comes with replacement blades, if the originals are broken or badly damaged. It is extremely important to use the correct blade (A or B) for replacement. The marking can be found on the blades. Using the incorrect blade will make it impossible to control the quadcopter.

(Assembly of the blades: Clip the small cap of the blade, and then aim at the shaft of the motor and press it. It may require a little force. Please be careful so you don't break it.)

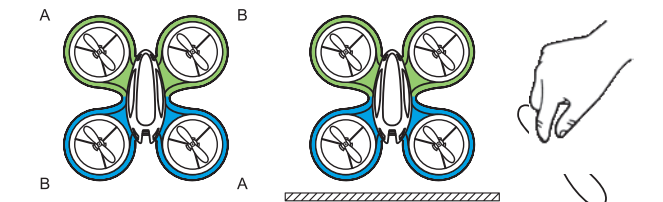

### Warranty Information:

Our product is guaranteed to be free from manufacturing defects for a period of 12 Months. If your product becomes defective during this period, Electus Distribution will repair, replace, or refund where a product is faulty; or not fit for intended purpose. This warranty will not cover modified product; misuse or abuse of the product contrary to user instructions or packaging label; change of mind and normal wear and tear. Our goods come with guarantees that cannot be excluded under the Australian Consumer Law. You are entitled to a replacement or refund for a major failure and for compensation for any other reasonably foreseeable loss or damage. You are also entitled to have the goods repaired or replaced if the goods fail to be of acceptable quality and failure does not amount to a major failure. To claim warranty, please contact the place of purchase. You will need to show receipt or other proof of purchase. Additional information may be required to process your claim. Any expenses relating to the return of your product to the store will normally have to be paid by you. The benefits to the customer given by this warranty are in addition to other rights and remedies of the Australian Consumer Law in relation to the goods or services to which this warranty relates.

This warranty is provided by: Electus Distribution  
Address 46 Eastern Creek Drive, Eastern Creek NSW 2766 | Ph. 1300 738 555