

# RESPONSE

Bluetooth Hands-free Car Kit

AR3138

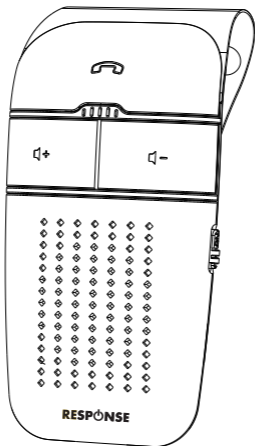

Quick Start Guide

# CONTENTS

WELCOME .....	3
EMERSON AR3138 OVERVIEW .....	4
POSITIONING & CHARGING .....	5
GETTING STARTED .....	6
HOW TO USE YOUR AR3138 .....	8
OTHER FUNCTIONS .....	11
TECHNICAL SPECIFICATIONS .....	12
FAQ .....	13
HOW TO TAKE CARE OF YOUR AR3138 .....	14

# WELCOME

Dear customers

Thank you for purchasing Bluetooth Handsfree Car Kit AR3138. We hope you enjoy it ! To ensure correct operation, please read this quick start guide carefully before operation.

## Package Contents

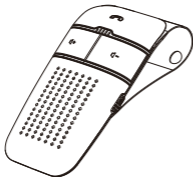

AR3138



Quick Start Guide

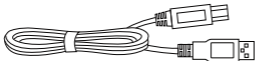

USB cable

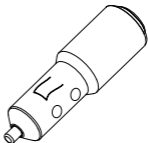

Car Charger

## AR3138 OVERVIEW

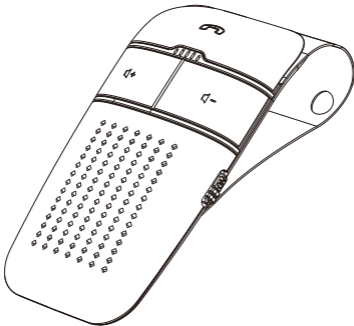

### WHAT YOUR AR3138 CAN DO

- Answer, end, decline incoming calls.
- Deliver great sound and noise cancellation with the HD voice microphone.
- Last number redial.
- Connect with two mobile phones simultaneously.
- Voice notification for incoming call number.
- Voice commands to allow easy call interaction while driving (Say "YES" to answer or say "NO" to decline an incoming call).
- Voice guidance for pairing instructions and connection status.
- Play music and GPS via your connected mobile device.
- Power on/off automatically.
- Activate Siri on iPhone or Android phone commands. (Phone dependent)

## POSITIONING YOUR AR3138

Clip the AR3138 to the sun visor in your vehicle.



## CHARGING YOUR AR3138

### IN-CAR CHARGING

Connect your AR3138 with the USB cable to the Car Charger before plugging the Charger into the car lighter socket equipped in your vehicle

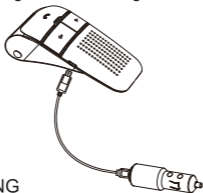

### PC CHARGING

Connect your AR3138 with the USB cable to any powered USB slot on your PC.

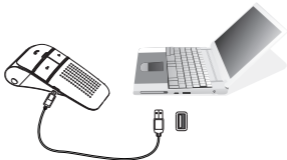

## GETTING STARTED

### TURNING ON YOUR AR3138

Slide the ON/OFF button to turn the AR3138 on or off.

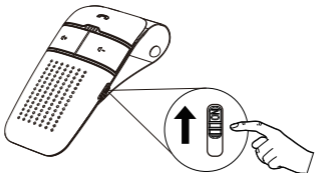

### FIRST TIME PAIRING

The first time the AR3138 is turned on, voice guidance will guide you through pairing with your mobile phone.

1. Turn on the AR3138.

2. The answer key flashes red and blue alternatively, you will then hear a voice prompt "Power on, Pairing". Bluetooth will need to be activated on your mobile phone. If asked for a passkey or PIN during pairing, please enter 0000.

NOTE: After the AR3138 and a mobile phone have been paired, they will automatically connect whenever the AR3138 is switched on and the mobile phone has Bluetooth activated within range.

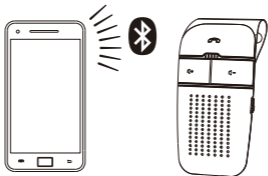

## PAIRING WITH ANOTHER MOBILE PHONE

1. Turn on your AR3138.

2. Long press the **Volume +** and **Volume -** button simultaneously for 2.5 seconds to disconnect the Bluetooth link with the first device and waiting for pairing the second Bluetooth enabled mobile phone.

3. Activate Bluetooth on the second mobile phone and select AR3138. If asked for a passkey or PIN during pairing, please enter 0000.

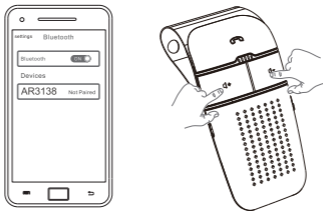

4. Select the AR3138 from the list of My Devices or Paired Devices on the first mobile to connect the AR3138 again.



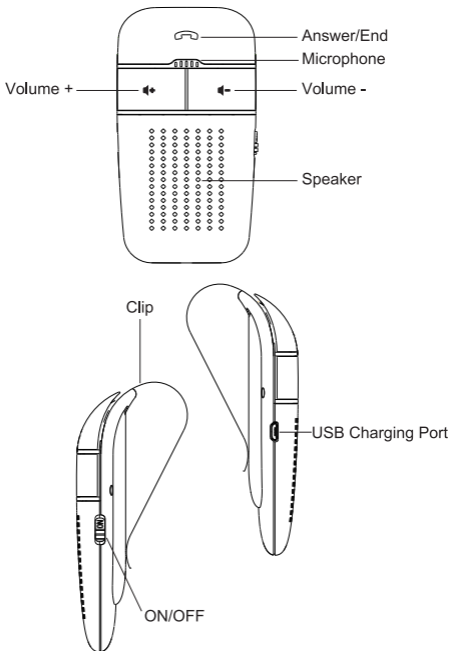

# HOW TO USE YOUR AR3138 WITH YOUR MOBILE PHONE





## HOW TO USE YOUR AR3138

	Make call	Start a call with your mobile phone. The call will automatically transfer to the AR3138.
	Answer call	Press the <b>Answer/End</b> button or say "YES"
	End call	Press the <b>Answer/End</b> button
	Decline call	Pres the <b>Answer/End</b> button for 2.5 seconds or say "NO"
	Activate the voice commands on phone	Long press the <b>Answer/End</b> (Phone dependent)
	Redial last number	Double –press the <b>Answer/End</b> button
<b>+</b>  <b>-</b>	Speaker volume up/down	Long press the <b>Volume +</b> or <b>Volume –</b> button
	Disconnect Bluetooth	Press the <b>Volume +</b> and <b>Volume –</b> button simultaneously for 2.5 seconds
	Empty the paired list of the AR3138	Press the <b>Volume +</b> and <b>Volume –</b> button simultaneously for 5 seconds

## ANSWERING/ENDING A CALL

1. When there is an incoming call, the AR3138 will alert you by reading out loud the incoming phone numbers. You can say either "Yes to answer the incoming call or say "NO" to decline it after you hear the incoming phone numbers.

2. When there is an incoming call, short press the Answer/End button to answer the call, long press to decline, short press again to end the call.

3. When putting through, long press the Volume + or Volume - button, there will be a tone alert for reaching the max volume or min volume.

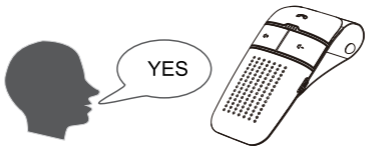

## POWER OFF AUTOMATICALLY

In pairing state, if there is no mobile phone connected in 180 seconds, the device will turn off automatically (soft off) and make alert tone, the switch is in the ON position at this moment. In addition, if the Bluetooth connection of the device disabled and do not connect again in 180 seconds, the AR3138 will power off automatically.

## POWER ON FROM STANDBY MODE

In the standby model (soft off), if you want to restart the device, you just need to shake anything nearby (like closing the car door) that can awake the AR3138 back to active mode.

## PLAY MUSIC OR GPS

You can play music or hear GPS through the AR3138 Music or GPS played on your connected mobile phone will automatically transfer to the AR3138.

## OTHER FUNCTIONS

### VOICE GUIDANCE

Voice guidance guides you through using the AR3138.

What you hear	What it means
"Power on,Pairing"	The AR3138 is power on and in pairing mode. Follow the instructions to pair your mobile phone with the AR3138
"Connected"	AR3138 is connected to a phone/ device
"Disconnected"	A connected phone/ device is turned off, out of range, or has Bluetooth disabled while in range
"Last number redial"	Redial the last number
"Low battery"	The AR3138 battery level is low, please charge your unit in time
"Power off"	The system of AR3138 is powered off

### MOBILE PHONE VOICE COMMANDS (E.G. SIRI)

To activate your mobile phone's voice commands (e.g. Siri), long press the **Answer/End** button on the AR3138. For a full list of voice commands refer to your mobile phone's user manual.

(Phone dependent)

### LOW BATTERY ALERT

The red indicator flashes quickly for three time every 3 seconds.

### CHARGING INDICATOR

When charging, the red indicator glows solidly, and will be turned off after fully charged. It takes 2-3 hours to get fully charged.

### EMPTY THE BLUETOOTH PAIRED LIST

Press the **Volume +** and **Volume -** button simultaneously for 5 seconds can empty the paired list of the AR3138 .

## TECHNICAL SPECIFICATIONS

Dimensions	W60xD48xH115mm
Weight	89±3g
Microphone	HD Omni-directional microphone
Speaker	2W
Frequency response	180Hz~16KHz
Impedance	8Ω
SNR	≥70dB
Bluetooth version	4.0
Operating range	10m
Paired devices	Up to 8 paired devices. Two active devices connected simultaneously
Battery	Internal rechargeable 600mAh Li-ion battery
Talk time	Up to 10 hours
Standby time	Up to 700 hours
Charging time	2-3hours
CLA power adapter	DC 12V input, 5V 500mAh output
Charging plug dimensions	Micro-USB
Operating temperature	Charging 0° C to 40° C (32° F to 104° F) Discharging -10° C to 60° C (14° F to 140° F)
Pairing passkey or PIN	0000

## FAQ

### **Q I hear crackling noises**

A Bluetooth is a radio technology that is sensitive to objects between the AR3138 and the connected device. Ensure the AR3138 and the connected device are within 33 feet (10 meters) of each other, with no major objects in the way (walls, etc.).

### **Q I cannot hear anything**

A - Increase the speaker volume.  
- Ensure the AR3138 is paired to a device that is playing.  
- Make sure your phone is connected to the AR3138.

### **Q I am having pairing problems**

A You may have deleted the AR3138 pairing connection in your mobile phone. Follow the pairing instructions.

### **Q Will the AR3138 work with other Bluetooth equipment?**

A The AR3138 is designed to work with Bluetooth mobile phones. It can also support other Bluetooth devices that are compliant with Bluetooth version 2.1 or higher and support a headset, hands-free and/or advance audio distribution profile.

### **Q I cannot activate the phone commands by long pressing the Answer/End button?**

A This feature requires your mobile phone to support voice commands. Refer to your mobile phone user manual for more details.

## HOW TO TAKE CARE OF YOUR AR3138

- Always store the AR3138 with the power off safely protected.
- If do not use the AR3138 for long time, please charge at least once within one month, in order to prevent the lithium battery from getting damaged because of excessive energy consumption.
- Avoid storage at extreme temperatures (above 45°C/113°F or below -10°C/14°F). This can shorten battery life and may affect operation. High temperatures may also degrade performance.
- Do not expose the AR3138 to rain or other liquids.



# RESPONSE

DISTRIBUTED BY: TechBrands by Electus Distribution Pty. Ltd.  
320 Victoria Rd, Rydalmere NSW 2116 Australia  
Ph: 1300 738 555 Int'l: +61 2 8832 3200 Fax: 1300 738 500  
[www.techbrands.com](http://www.techbrands.com)

MADE IN CHINA

