

Bluetooth® Wireless
Kids Safe Headphones

digitech

Model:

AA2228

Please read and save all instructions to ensure safe and effective use of this product.



R-NZ

Instruction Manual

INCLUDED

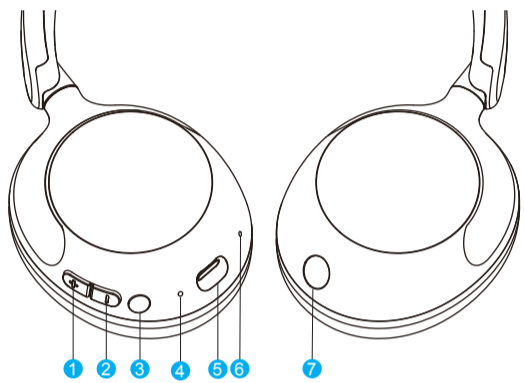

- 1 Volume Up
- 2 Volume Down
- 3 Power Button (Multi-function)
- 4 LED Indicator
- 5 Charging Port
- 6 Microphone
- 7 3.5mm Audio Port

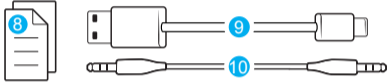

SAFE HEARING

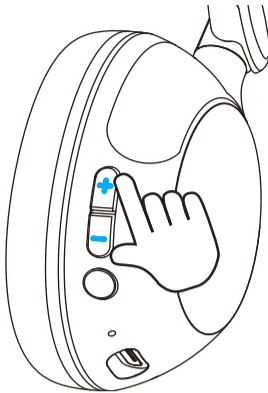

Press and hold the +/- buttons 1S to activate **Travel Mode (94dB max)**.

Study Mode defaults to **85dB max**.

WIRED LISTENING MODE

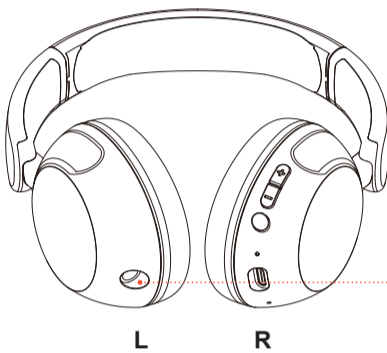

- The button functions will not work when **AUX INPUT** is connected.
- The volume will be dependent on your **AUX device settings**. Adjust accordingly.

L

R

MULTI-POINT CONNECTION

maximum 2 devices

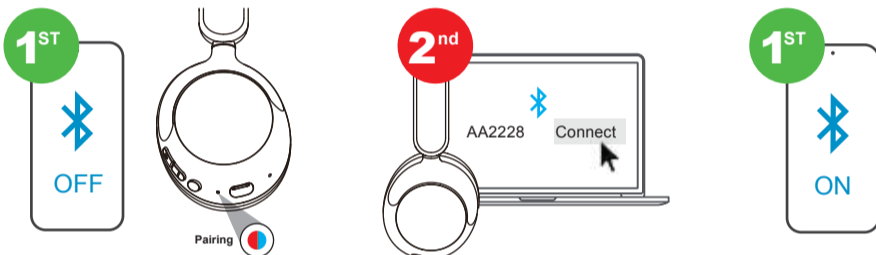

- Once **FIRST** device is connected, turn off Bluetooth in device settings. Headphone will auto enter Bluetooth Pairing.
- Enter your **SECOND** device Bluetooth settings and connect to headphone
- Enter your **FIRST** device settings. Turn on Bluetooth and reconnect to headphone

POWER ON CONNECT

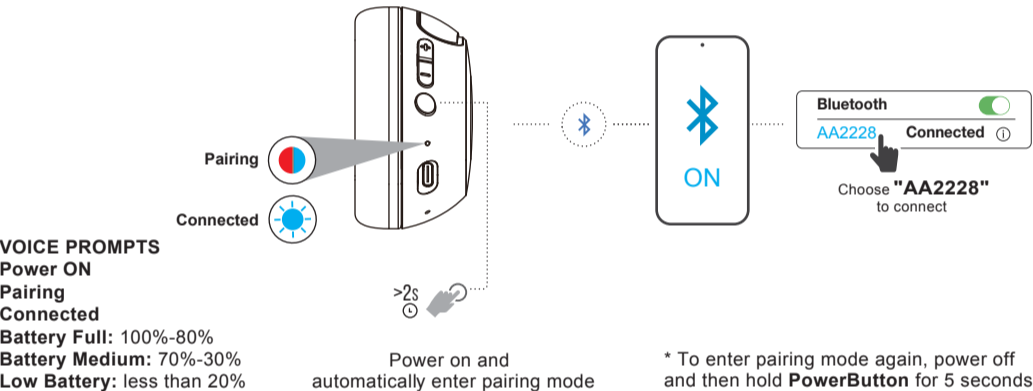

CONTROL

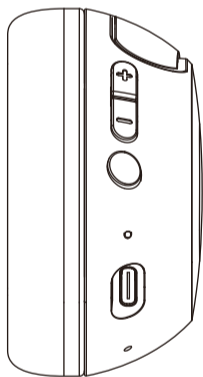

- Press once to **increase volume**
- Press and hold to **skip forward**
- Press once to **decrease volume**
- Press and hold to **skip back**
- Press once to **play, pause, or answer, end a phone call**
- Press twice to **activate Siri or other voice control software**
- Press and hold 2s to **reject incoming calls**
- Press and hold to **power ON or OFF**

CHARGING

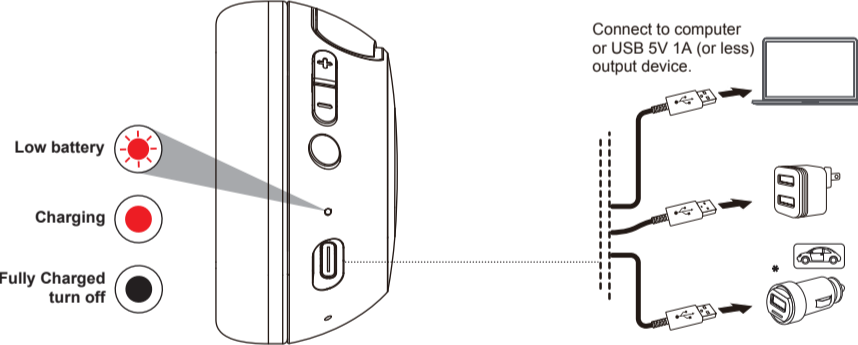

AUDIO SHARING

(Share between two KT81 headphones)



- Turn off **both** headphones. Press and hold the power button for **5 seconds** until the lights flash **red and blue**.
- Press the power button **3 times** on **each** headphone. A blinking blue light means they're paired.

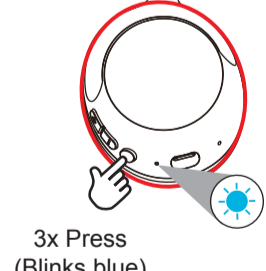
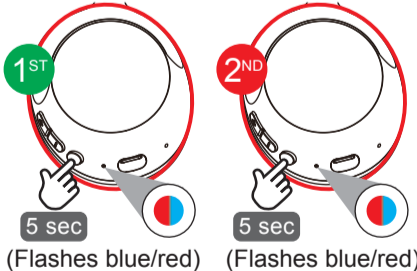

- One headphone will flash **red and blue**. Connect this one to your device.

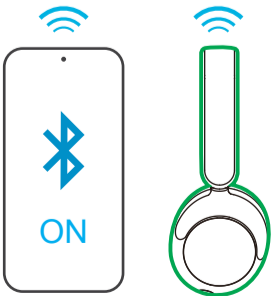

• **3x Press** on **either** headphone to **disconnect** from sharing mode.

FACTORY RESET

Please make sure you forget "KT81" from your Bluetooth device settings before resetting

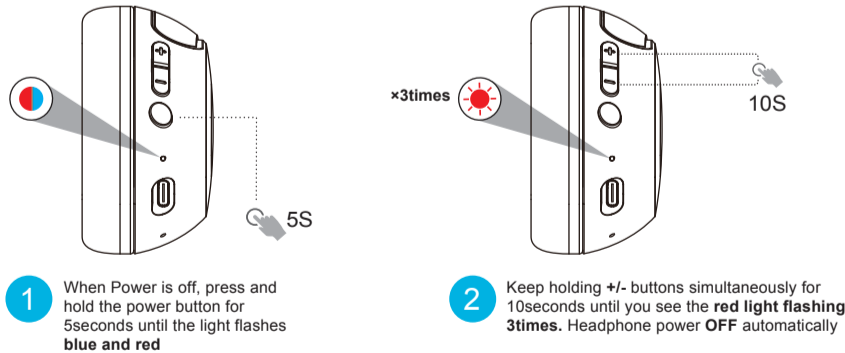

Please read this manual carefully before use.

Safety Warnings

- Do not place any naked flame sources, such as lighted candles
- Dispose of batteries responsibly and be aware of the environmental effects of battery disposal
- Do not expose the batteries (batteries installed) to excessive heat, such as fire or the like

Warning

- To prevent possible hearing damage, do not listen at high volume levels for long periods.
- For your own safety, please be aware of your surroundings when using these headphones.

Warranty Information

Our product is guaranteed to be free from manufacturing defects for a period of 12 Months. If your product becomes defective during this period, Electus Distribution will repair, replace, or refund where a product is faulty; or not fit for intended purpose. This warranty will not cover modified product; misuse or abuse of the product contrary to user instructions or packaging label; change of mind and normal wear and tear. Our goods come with guarantees that cannot be excluded under the Australian Consumer Law. You are entitled to a replacement or refund for a major failure and for compensation for any other reasonably foreseeable loss or damage. You are also entitled to have the goods repaired or replaced if the goods fail to be of acceptable quality and failure does not amount to a major failure. To claim warranty, please contact the place of purchase. You will need to show receipt or other proof of purchase. Additional information may be required to process your claim. Any expenses relating to the return of your product to the store will normally have to be paid by you. The benefits to the customer given by this warranty are in addition to other rights and remedies of the Australian Consumer Law in relation to the goods or services to which this warranty relates.

This warranty is provided by: Electus Distribution
Address 46 Eastern Creek Drive, Eastern Creek NSW 2766 | Ph. 1300 738 555