



LINK TRUE WIRELESS EARBUDS

AMA-3050A-BLACK / AMA-3050A-BLUE / AMA-3050A-PINK



Instruction Manual

Product Overview

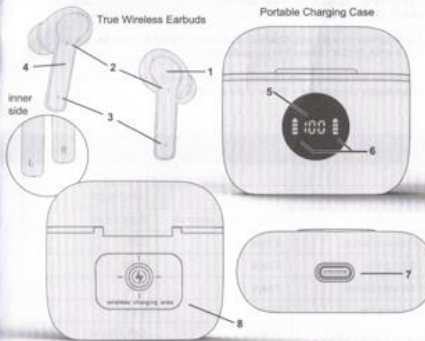

Remove the protective stickers before using

1. Touch Control On / Off Button / Play / Pause Music / Answer / End Call
2. Built-in Microphone
3. Built-in Microphone
4. True Wireless Earbuds
5. Charging Case Battery Level Indicator
6. Earbuds Battery Level Indicator
7. USB Type-C Charging Port
8. Wireless Charging Area

Package Contents

Includes:

- 1(One) Pair Earbuds 1.7in. x 1.5in. x 1.0in. (4.4cm x 3.7cm x 2.6cm) each
- 1(One) Portable Charging Case 3.3in. x 2.3 in. x 1.3 in. (8.4cm x 5.8cm x 3.2cm)
- 1(One) USB-C Charging Cable 11.8in. (30cm)
- 1(One) Instruction Manual

Pairing with smartphone

1. Take the two earbuds out of the case; they will automatically turn on and pair with each other. At this point they will be ready for pairing with the smartphone.
2. Now turn on your phone's Bluetooth and search the list of found devices for "Aiwa AMA-3050A". Select it to complete pairing.
3. After the first pairing (with Bluetooth setting turned on,) the earbuds will automatically connect to the phone when activated.

Functions

Play/Pause music	1 touch	Left / Right
Voice assistant	Long press 3 seconds	Right / Left
Previous track	2 taps	Left
Next track	2 taps	Right
Volume Down	3 taps	Left
Volume Up	3 taps	Right
Answering a call	1 touch	Left / Right
Ending a call	1 touch	Left / Right
Rejecting a call	Long press 2 seconds	Left / Right

Specifications

Driver Diameter: 13 mm
 Impedance: 32 Ohms
 Frequency Response: 20 Hz - 20 kHz
 Sensitivity: 96 dB +/- 3 dB
 Power Supply: Li-ion Battery 3.7V 30 mAh Per Earbud
 Playtime: 10 Hours Total
 Charging Time: 2-3 Hours
 Bluetooth Version: 5.3
 Charging Case Battery Capacity: 200 mAh
 USB Type-C Charging Cable Included

Charging

Charging the earbuds

Charge the earbuds fully before use and whenever battery becomes weak. To charge, just place the earbuds in its case. Charging starts automatically as shown on the indicators on the case screen. The indicators turn off when battery is fully charged.

Charging the case

Option 1: Use the provided Charging Cable to connect the Charging Case to a suitable charging adaptor.
 Option 2: Place the rear of the Charging Case (wireless charging area) on a suitable Wireless Charger to start wireless charging.
 In both cases, the indicator on the middle of the screen shows the charging level. When fully charged, the indicator shows 100.

Power On/Off

Power On

Way 1: The earbuds will switch on automatically when they are removed from the charging case.
 Way 2: Long press earbud 5 seconds to power on

Power Off

Way 1: The earbuds will turn off automatically, when inserted into the charging case.
 Note:
 - If it does not power off, take it out and insert it again. Check if the pins are covered with something. Wipe clean with a soft cloth before trying again.
 Way 2: Long press earbud 5 seconds to power off

FAQ

If the wireless earbuds cannot be paired with your device, please try the following:
 Ensure that your earbuds are in pairing mode or reconnection mode
 Ensure that Bluetooth search function of your mobile device is activated.

If the wireless earbuds will not turn on:

Make sure the earbuds are fully charged.
 Make sure the protective stickers are removed from the Earbuds

Can I charge the battery for the earbuds and the charging case?

The wireless earbuds and the charging case use a built-in non-detachable battery which cannot be removed.

If the charging case cannot be recharged:

If you use a power outlet, ensure that the power supply is connected securely and the outlet works.

⚠ Safety instructions for the lithium battery and charging the product

-The input voltage to the product is 5V 1A.

-In order to charge the product in safe manner and reliable conditions, please only adopt certified appropriate charger/ adapter for charging the product.

-Only charge the product at ambient temperatures between 10 °C/ 50 °F and 40 °C/104 °F.

-Do not expose to sunlight or throw into fire.

-Switch off the product after use.

-In extreme cases, abuse or misuse of Lithium battery pack can lead to explosion, heat generation, fire development or smoke development.