

**digitech**

# Stereo Amplifier 2x120WRMS



Model:  
AA0520

# Instruction Manual

## BEFORE FIRST USE

Prior to using your product, please read all the safety and operating instructions thoroughly. Please ensure you follow the steps below before using the product. We recommend you keep the original packaging for storing the product when not in use.

Find a safe and convenient place to keep this instruction manual for future reference.

Unpack the product but keep all packaging materials until you have made sure your new product is undamaged and in good working order. Ensure you have all accessories listed in this manual.

## BOX CONTENTS

1 x Stereo Amplifier  
1 x Remote

1 x User Manual

## SPECIFICATIONS

|                                  |                             |
|----------------------------------|-----------------------------|
| Output Power:                    | 120W +120WRMS Max (4 Ohms)* |
| Input Impedence:                 | 47k Ohm                     |
| InputSensitivity:                | 300mV                       |
| Signal-to-Noise:                 | ≥80dB                       |
| Total Harmonic Distortion(1KHz): | ≤0.5%                       |
| Frequency Response:              | 20Hz-20KHz±2dB              |
| Power Input:                     | 240VAC @ 2A Max.            |
| Audio Input:                     | Dual Stereo RCA Sockets     |
| Audio Output:                    | 1 x Stereo RCA Sockets      |
| Weight:                          | 3.5kg                       |
| Dimensions:                      | 250(W) x 240(D) x 90(H)mm   |

\*The minimum allowable speaker impedance is 4 Ohms, which gives the maximum rated power of 120 Watts per channel. It will work perfectly well with higher impedance speakers such as 8 Ohms, it's just that the maximum power will be reduced. With 8 Ohms you will only get 60 Watts per channel, 6 Ohms you would get about 80 Watts per channel and so on.

# PRODUCT DIAGRAM

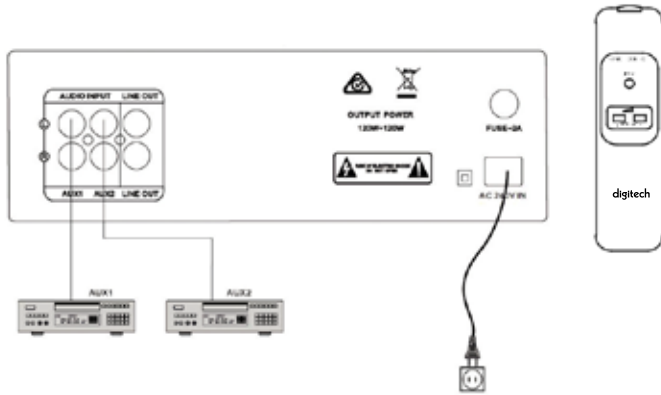
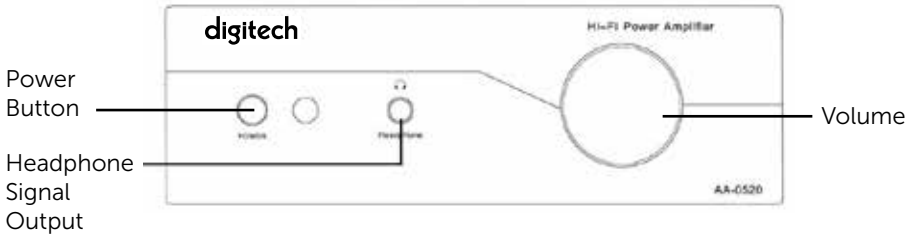

Aux Signal Input

Aux 2 Signal Input

Line Out

AC Input Fuse

## WARRANTY INFORMATION

Our product is guaranteed to be free from manufacturing defects for a period of 12 Months.

If your product becomes defective during this period, Electus Distribution will repair, replace, or refund where a product is faulty; or not fit for intended purpose.

This warranty will not cover modified product; misuse or abuse of the product contrary to user instructions or packaging label; change of mind and normal wear and tear.

Our goods come with guarantees that cannot be excluded under the Australian Consumer Law. You are entitled to a replacement or refund for a major failure and for compensation for any other reasonably foreseeable loss or damage. You are also entitled to have the goods repaired or replaced if the goods fail to be of acceptable quality and failure does not amount to a major failure.

To claim warranty, please contact the place of purchase. You will need to show receipt or other proof of purchase. Additional information may be required to process your claim.

Any expenses relating to the return of your product to the store will normally have to be paid by you.

The benefits to the customer given by this warranty are in addition to other rights and remedies of the Australian Consumer Law in relation to the goods or services to which this warranty relates.

This warranty is provided by:

Electus Distribution

Address 46 Eastern Creek Drive, Eastern Creek NSW 2766

Ph. 1300 738 555