

protech

# 30W 240V Temperature Controlled Soldering Iron

HOBBYIST



## User Manual

TS1540

## CONTENTS

|   |   |
|---|---|
| Box Contents.....                           | 3 |
| Product Diagram .....                       | 3 |
| Warnings & Safety Information.....          | 4 |
| Features.....                               | 4 |
| Operating Instructions .....                | 5 |
| Cleaning, Care, Storage & Maintenance ..... | 6 |
| Specifications .....                        | 7 |
| Warranty Information .....                  | 8 |

## BOX CONTENTS



1x Soldering Iron

## PRODUCT DIAGRAM

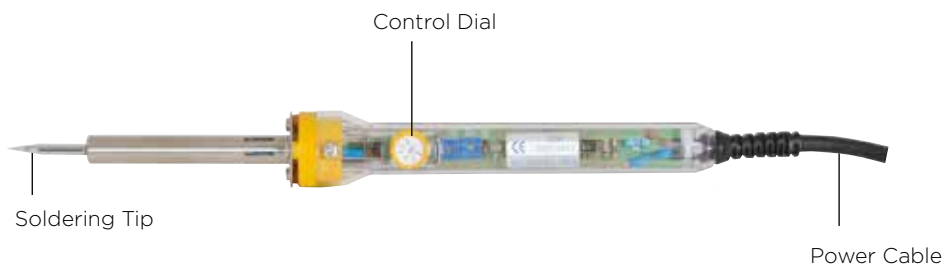

## WARNINGS & SAFETY INFORMATION

- Ensure the solder always cover on the top of the soldering tip.
- Do not use the strong acid flux when soldering.
- Do not file or beat the soldering tip by file or hammer.
- When the solder stick on the soldering tip, please use the sand paper to clean, and then soak in some flux. It is better to control the temperature on approx 250C.
- Forbid to disassemble the heat components when the application is powered on.
- Put the soldering iron on the stand when not using. It is a must that the soldering iron stand is with the function of heat elimination.
- Only the professional person can replace the cable when it is broken.
- This appliance is not intended for use by persons (including children) with reduced physical, sensory or mental capabilities, or lack of experience and knowledge, unless they have been given supervision or instruction concerning use of the appliance by a person responsible for their safety.
- Children should be supervised to ensure that they do not play with the appliance.

## FEATURES

- Temperature control.
- With transparent handle, stainless steel outer tube, high grade heater element, and updated integrated temperature automatic controller.
- Temperature can be set by the regulation button on the handle directly.
- Having many outstanding merits, such as quick temperature rising, accurate controlling, leakage protection design, and beautiful appearance.
- The most special is that it can protect the PCB and devices when soldering.
- Stable soldering temperature and high power heater elements.
- Quick heat-up and good temperature reduction compensation..
- Long life lead free soldering tip and safety reliable grounding device.

## OPERATING INSTRUCTIONS

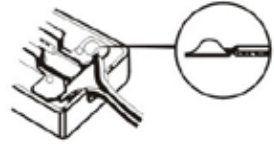

1. Remove any dirt, rust, or paint from the part you intend to solder. Then, heat the part using the soldering iron.
2. Apply rosin-based solder to the part and melt it with the soldering iron. Note: If you're using non-rosin-based solder, make sure to apply soldering paste to the part before applying the solder.
3. Allow the solder to cool and harden before handling the soldered part.

### Soldering steps to protect the tip from oxidation.

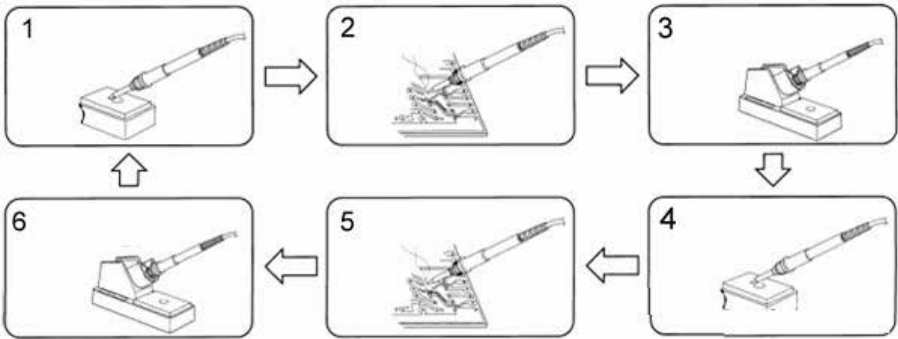

1. Before soldering, clean the tip using a sponge, and then apply tin to the tip.
2. Begin your soldering work.
3. When not in use, please place the soldering iron on the holder.
4. Clean the tip and apply tin to it.
5. Proceed with the soldering.
6. Repeat steps 1 to 5 as needed.
7. When your soldering work is finished, either adjust the temperature to 270°C or switch off the power.
8. Afterward, clean the tip and apply tin for protection.

## CLEANING, CARE, STORAGE & MAINTENANCE

### Soldering Tip Care Guidelines

- Always ensure that the tips are coated with tin to prolong their service life.
- Avoid leaving the iron at high temperatures for an extended duration.
- Never clean the tip with abrasive materials.
- Do not quench the tip in water.
- It is advisable to remove and clean the tip every twenty hours of use, or at least once a week, and clear any loose residue from the barrel.
- Refrain from using fluxes that contain chloride or acid; opt for rosin or activated resin fluxes only.
- Avoid using any compounds or anti-seize materials.
- Handle the heated soldering iron with extreme caution, as its high temperature can lead to fires or severe burns.
- Ensure the soldering tip is correctly fitted and the locking screw is tightened securely.

### Soldering Iron Maintenance

This tool should be placed on its stand when not in use. If the supply cord is damaged, it should be replaced by the manufacturer, its service agent, or a similarly qualified person to avoid any hazards.

Do not attempt to file the specially-plated tip.

### Tip Replacement

Tip replacement or cleaning should be performed only when the iron is at room temperature or below. To change or replace the tip, unscrew the knurled nut barrel assembly. Ensure that the station is switched off and allowed to cool both before and during this operation, as leaving the system on without the tip inserted could lead to damage.

After removing the tip, clean any oxide dust that may have formed in the tip-retaining area of the barrel. Be cautious to prevent dust from getting into your eyes. To replace the tip, screw the retaining knurled nut barrel assembly using only hand pressure to tighten. Pliers should be used only if the nut needs tightening when the iron is hot, to avoid burns on your fingers. Be careful not to overtighten, as this could damage the heating element.

### General Cleaning

You can clean the outer case of the iron or station with a damp cloth and a small amount of liquid detergent. Do not submerge the unit in liquid or allow any liquid to enter the case of the station. Never use solvent to clean the case.

## SPECIFICATIONS

|                                      |                 |
|--------------------------------------|-----------------|
| <b>Voltage</b>                       | 220V- 240V 50Hz |
| <b>Max Power</b>                     | 30W             |
| <b>Temperature Range</b>             | 200°C-450°C     |
| <b>Start-up time</b>                 | <45 seconds     |
| <b>Temperature control precision</b> | +/-3°C          |
| <b>Grounding resistance</b>          | <0.10           |
| <b>Fuse</b>                          | 1A/250V         |

## WARRANTY INFORMATION

Our product is guaranteed to be free from manufacturing defects for a period of 12 Months.

If your product becomes defective during this period, Electus Distribution will repair, replace, or refund where a product is faulty; or not fit for intended purpose.

This warranty will not cover modified product; misuse or abuse of the product contrary to user instructions or packaging label; change of mind and normal wear and tear.

Our goods come with guarantees that cannot be excluded under the Australian Consumer Law. You are entitled to a replacement or refund for a major failure and for compensation for any other reasonably foreseeable loss or damage. You are also entitled to have the goods repaired or replaced if the goods fail to be of acceptable quality and failure does not amount to a major failure.

To claim warranty, please contact the place of purchase. You will need to show receipt or other proof of purchase. Additional information may be required to process your claim.

Any expenses relating to the return of your product to the store will normally have to be paid by you.

The benefits to the customer given by this warranty are in addition to other rights and remedies of the Australian Consumer Law in relation to the goods or services to which this warranty relates.

This warranty is provided by:

Electus Distribution

Address 46 Eastern Creek Drive, Eastern Creek NSW 2766

Ph. 1300 738 555