

SEM-416VS

VAN SLIDING DOOR SWITCH

The switch has been designed to be used for central locking application in vehicles with sliding or tailgate doors. The switch may also be used for other application other than central locking.

SPECIFICATIONS :

Contact Rating	: 12V, 20A
Contact Resistance	: 30M Ω Max.
Operating Life	: 100,000.00 operations
Operating Temperature	: -40°C ~ +85°C

Note : Before securing the switches onto the vehicles seal all drilled holes with anti rust paint.

1. Cut out template "A" and place over the section were the male switch is to be installed. Drill and install the male part of the switch onto the sliding section or opening tailgate section of the vehicle. (Ref fig. 1 &2)
2. Temporarily install the male switch, place some marking paint on the end of the male switch then close and open the door.
3. Cut out template "B" measure and place over the section were the paint has left the mark. Drill and install the female part of the switch onto the vehicle body. (Ref fig. 1&2)

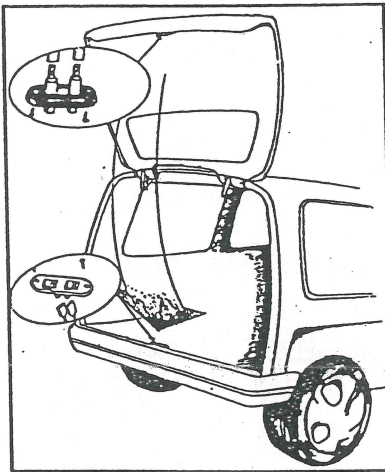

Fig. 1

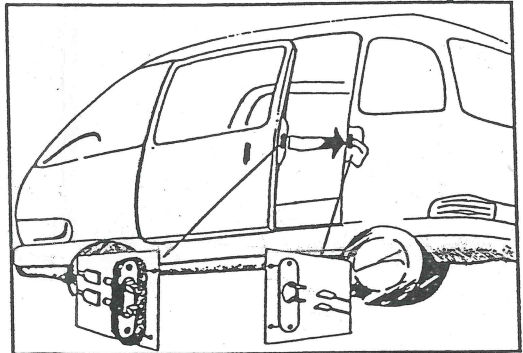
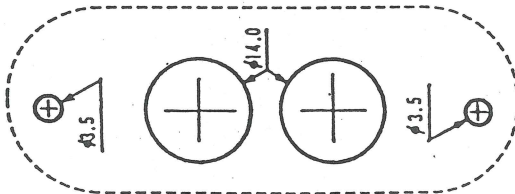
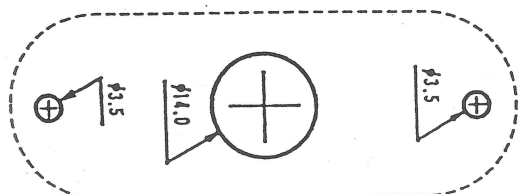

Fig. 2



Template "A"



Template "B"